

Archaeological Area of Potential Effect (APE) for the Proposed Action

Figure 10-1

SOURCE: New York City Department of City Planning

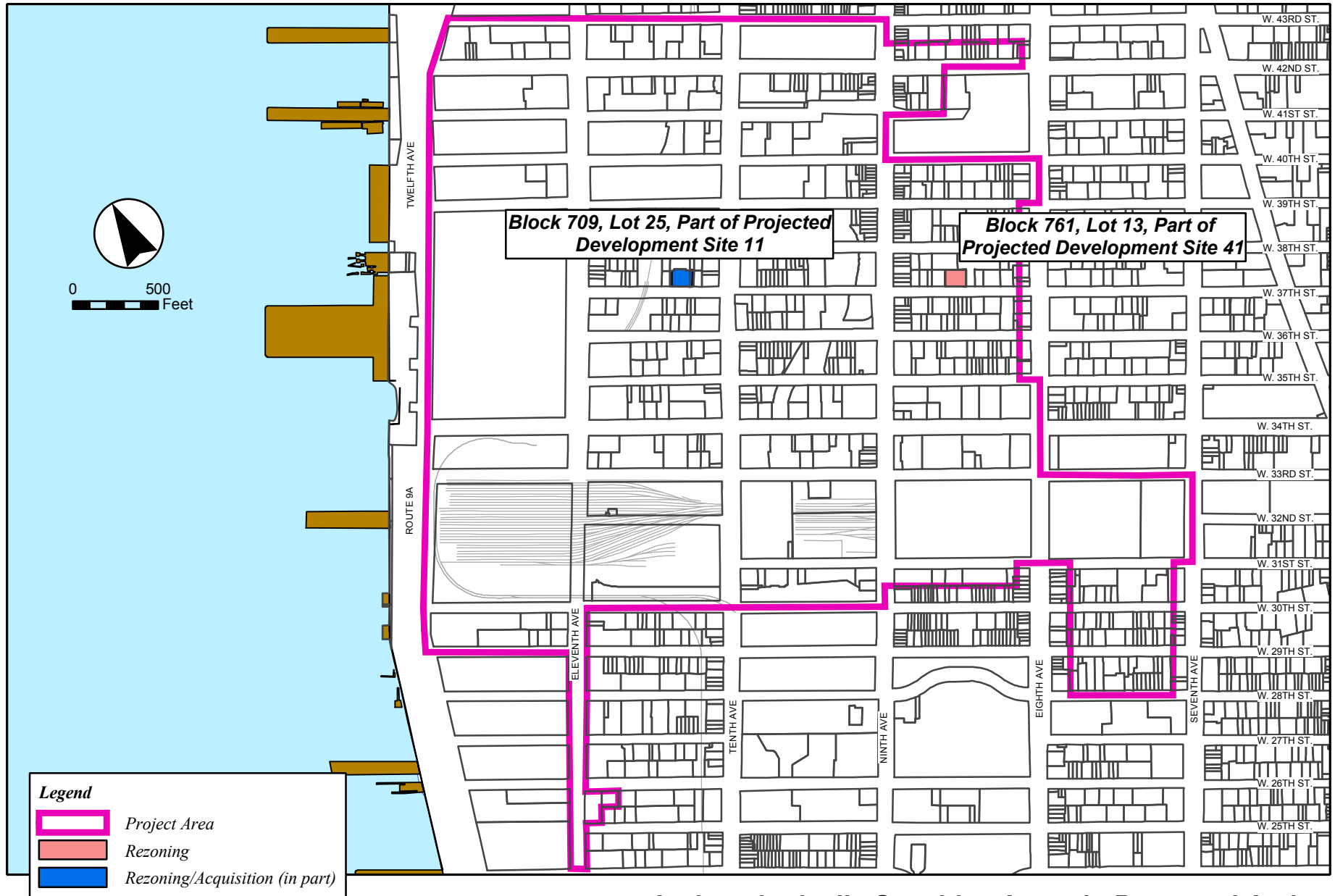

Archaeologically Sensitive Areas in Proposed Action

Figure 10-2

SOURCE: New York City Department of City Planning

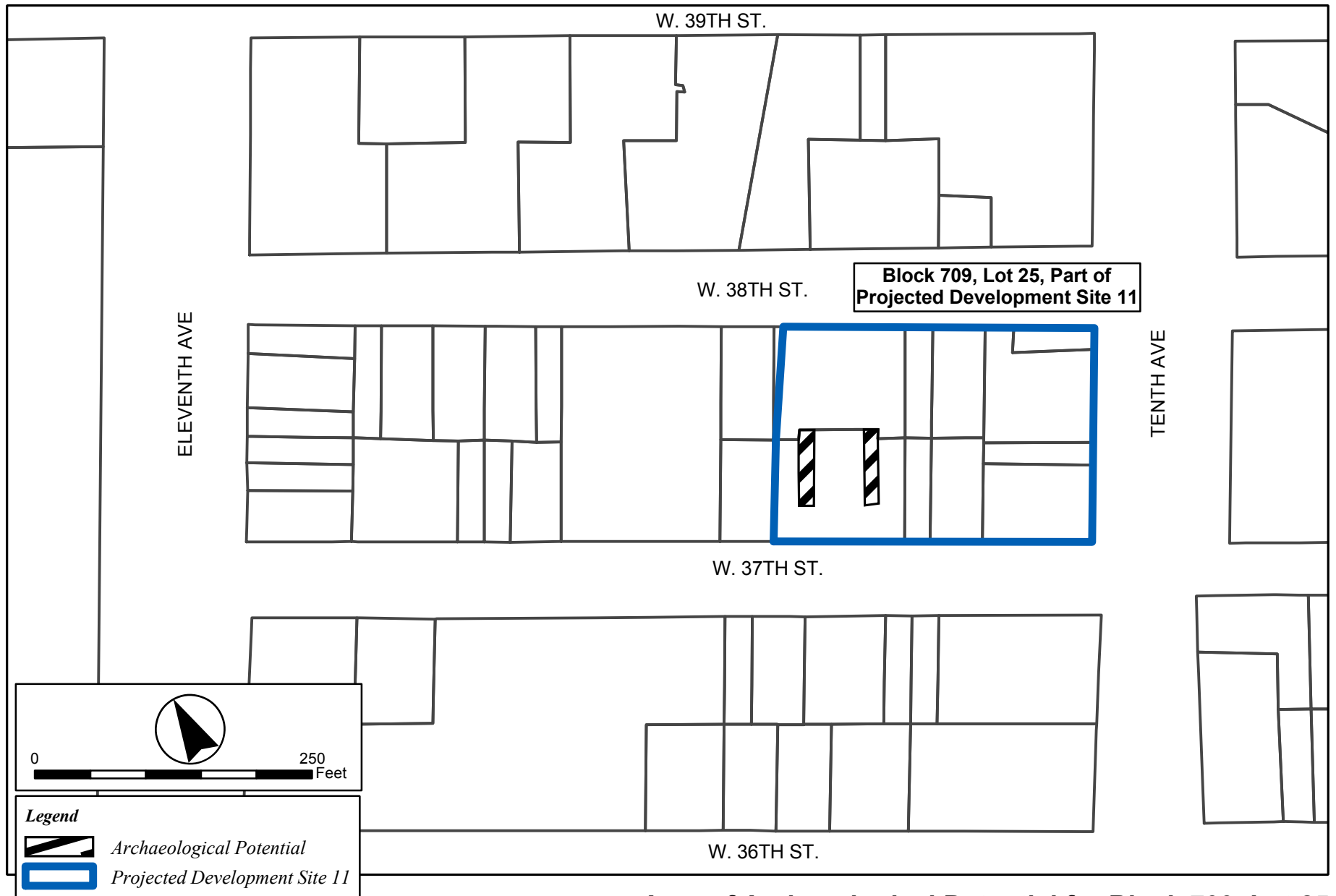

Area of Archaeological Potential for Block 709, Lot 25

Figure 10-3

SOURCE: New York City Department of City Planning

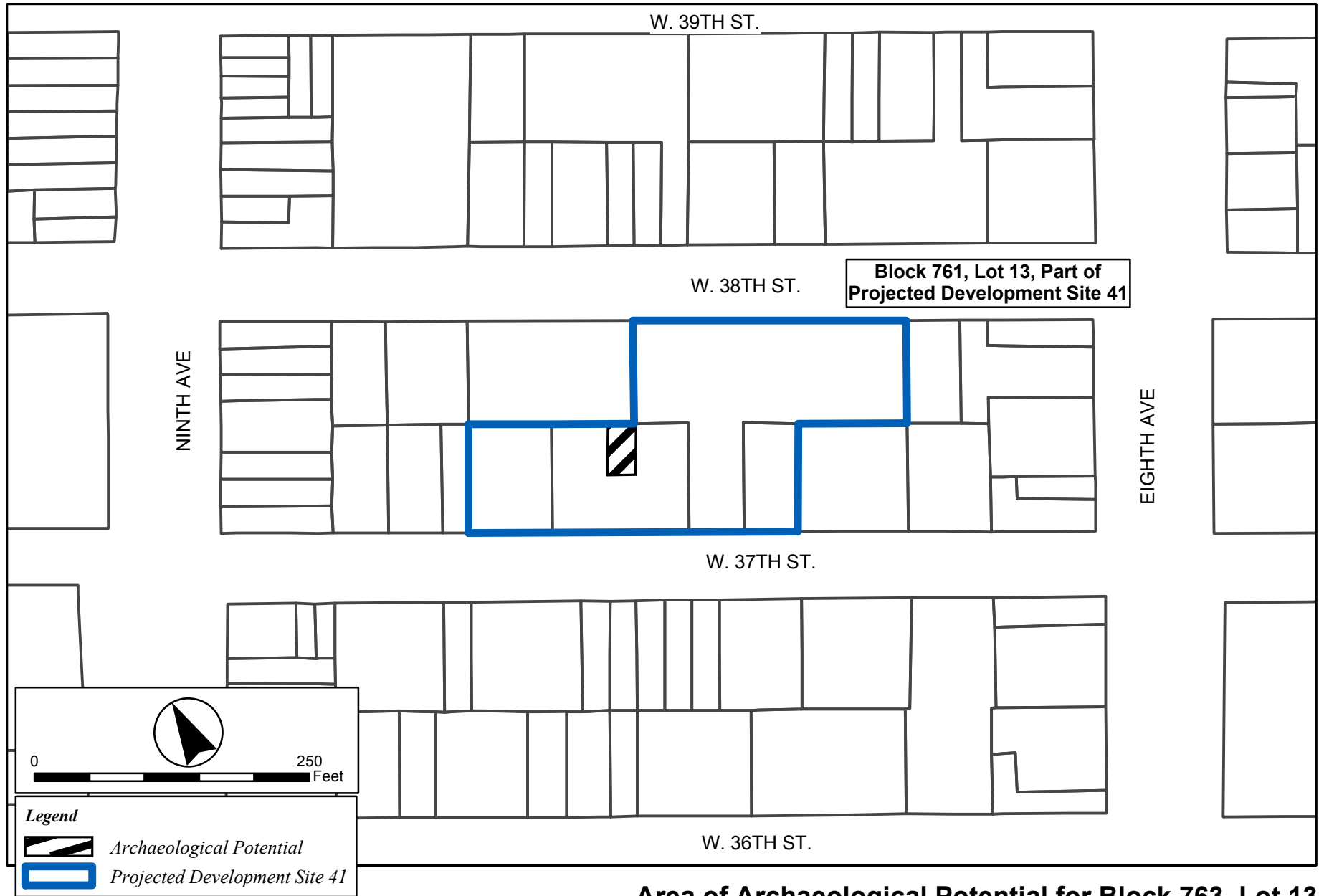

Area of Archaeological Potential for Block 763, Lot 13

Figure 10-4

SOURCE: New York City Department of City Planning