

**Architectural Resources:  
North of West 36th Street**

Figure 9-1





Macy's Seventh Avenue facade, view northeast 2a



Macy's view west from Broadway and West 34th Street 2b

## Architectural Resources Figure 9-3



St. Francis Roman Catholic Church Complex, 129-143 West 31st Street. View north **3a**



St. Francis Roman Catholic Church Complex, 129-143 West 31st Street. View north **3b**

## Architectural Resources Figure 9-4



New Amsterdam Theater, 214 West 42nd Street. **4**  
View southwest on West 42nd Street



Candler Building, 220 West 42nd Street. **5**  
View west on West 42nd Street

## Architectural Resources Figure 9-5



St. John the Baptist Roman Catholic Church, 207-215 West 30th Street. View northeast **6a**



St. John the Baptist Roman Catholic Church, 207-215 West 30th Street. View north **6b**

**Architectural Resources**  
Figure 9-6



Penn Station Service Building, 236-248 West 31st Street. View southeast 7



Times Square Hotel. View northeast from Eighth Avenue and West 43rd Street 8

## Architectural Resources

Figure 9-7



Holy Cross Roman Catholic Church and Rectory, 329-333 West 42nd Street 9a



Holy Cross Roman Catholic Church School, 334 West 43rd Street 9b

## Architectural Resources Figure 9-8





McGraw-Hill Building, 330 West 42nd Street. View west on West 42nd Street 10



Commercial building, 300 West 38th Street. View southwest 11

## Architectural Resources

Figure 9-9



United States General Post Office. View northwest from Eighth Avenue and West 31st Street 12a



United States General Post Office. View northeast from Ninth Avenue and West 31st Street 12b

## Architectural Resources

Figure 9-10



Former French Hospital, 326-330 West 30th Street. View southwest 13



Film Center Building, 630 Ninth Avenue. 14  
View northeast from Ninth Avenue and West 44th Street

## Architectural Resources

Figure 9-11



State Bank and Trust Company, 681-685 Eighth Avenue. View west 15



Actor's Studio, 432 West 44th Street 16

## Architectural Resources

Figure 9-12



Morgan General Mail Facility. Ninth Avenue facade, view west 17



Public School 51, 520 West 45th Street. 18  
View east on West 45th Street

**Architectural Resources**  
Figure 9-13



Lincoln Tunnel Entrance (19A). View west 19a



Lincoln Tunnel entrance (19A). View north of wall along West 39th Street 19b

## Architectural Resources

Figure 9-14



Lincoln Tunnel Ventilation Building (19B), 491 Eleventh Avenue. View west. **19c**



1950's Lincoln Tunnel Ventilation Building (19C). View southeast **19d**

**Architectural Resources**  
Figure 9-15



Lincoln Tunnel North Ventilator (19D). View west on West 39th Street 19e



U.S.S. Intrepid. View northwest on Twelfth Avenue 20

## Architectural Resources

Figure 9-16





New York Terminal Warehouse Company. Eleventh Avenue facade, view north 23a



New York Terminal Warehouse Company. View west on West 27th Street 23b

## Architectural Resources Figure 9-17



Starrett-Lehigh Building. View northeast from West 24th Street and Twelfth Avenue 24a



Starrett-Lehigh Building. Eleventh Avenue facade, view north 24b

**Architectural Resources**  
Figure 9-18



B & O Railroad Warehouse. View west from Eleventh Avenue 25



Terminal Hotel. 563-565 West 23rd Street. View east 26

**Architectural Resources**  
Figure 9-19



West 29th Street trestle. View west 27a



Rail spur over Tenth Avenue and West 30th Street. View north on Tenth Avenue from West 29th Street 27b

**Architectural Resources**  
**The High Line**  
Figure 9-20



Rail spur platform over Tenth Avenue at West 30th Street. View southwest on West 30th Street 27c



Rail spur along West 30th Street and trestle over West 30th Street. View west 27d

**Architectural Resources**  
**The High Line**  
Figure 9-21



West 30th Street viaduct. View west toward Eleventh Avenue from West 30th Street trestle 27e



Trestle over Eleventh Avenue. View north 27f

**Architectural Resources**  
**The High Line**  
Figure 9-22



West 30th Street viaduct, View west towards Twelfth Avenue 27g



Viaduct along Twelfth Avenue. View north on Twelfth Avenue from West 30th Street 27h

**Architectural Resources**  
**The High Line**  
Figure 9-23



West 33rd Street trestle. View west 27i



Curve in the viaduct as it moves from Twelfth Avenue to parallel West 34th Street 27j  
View northwest from West 33rd Street

**Architectural Resources**  
**The High Line**  
Figure 9-24





345-353 Seventh Avenue. View northeast 28



Seventh Avenue Building, 323-335 Seventh Avenue. View southeast 29

**Architectural Resources  
Garment Industry Resources**

Figure 9-25



Kheel Tower, 311-315 Seventh Avenue. View southeast 30



Shampán 8th Avenue Building, 553-555 Eighth Avenue. View northwest 31

**Architectural Resources**  
**Garment Industry Resources**  
Figure 9-26



Former American Union Bank Building, 540-552 Eighth Avenue. **32**  
View east



Thirty-Six Thirty-Seventh Street Arcade, 520-528 Eighth Avenue. **33**  
View east

**Architectural Resources**  
**Garment Industry Resources**  
Figure 9-27



509-519 Eighth Avenue. View southwest 34



Hoover Building, 501-507 Eighth Avenue. View northwest 35

**Architectural Resources**  
**Garment Industry Resources**  
Figure 9-28



322-326 Eighth Avenue. View east 36



Harding Building, 440-448 Ninth Avenue. View southeast 37

**Architectural Resources  
Garment Industry Resources**

Figure 9-29



263-267 West 40th Street. View northwest 38



251-255 West 39th Street. View northeast 39

**Architectural Resources**  
**Garment Industry Resources**  
Figure 9-30



Former Kermacoe Building, 257-267 West 39th Street. View northwest 40



323-327 West 39th Street. View north 41

**Architectural Resources**  
**Garment Industry Resources**  
Figure 9-31



Shampan Building, 252-258 West 37th Street. View southeast 42



Garment Wear Arcade, 306 West 37th Street. View southeast 43

**Architectural Resources**  
**Garment Industry Resources**  
Figure 9-32





315-325 West 36th Street. View northwest 44



144-154 West 30th Street. View southwest 45

**Architectural Resources**  
**Garment Industry Resources**  
Figure 9-33



Fur Craft Building, 242-246 West 30th Street. View southwest 46



214-222 West 29th Street. View southwest 47

**Architectural Resources**  
**Garment Industry Resources**  
Figure 9-34



231-239 West 29th Street. View northeast 48



241-245 West 29th Street. View northeast 49

**Architectural Resources**  
**Garment Industry Resources**  
Figure 9-35



249-251 West 29th Street. View north 50



Industrial Building, 150-154 West 28th Street. View southwest 51

## Architectural Resources Garment Industry Resources

Figure 9-36



Fur Towers, 156-160 West 28th Street. View southeast 52



Fur Art Building, 236-240 West 27th Street. View southeast 53

**Architectural Resources**  
**Garment Industry Resources**  
Figure 9-37



Nelson Tower, 446-456 Seventh Avenue. View north 54



Fairmont Building, 239-241 West 30th Street. View north 55

**Architectural Resources  
Garment Industry Resources**

Figure 9-38



Hill Building, 469-475 Tenth Avenue. View west 56



Master Printers Building, 406-416 Tenth Avenue. View southeast 57

**Architectural Resources**  
**Printing Industry Resources**

Figure 9-39



Zinn Building, 210 Eleventh Avenue. View northeast 58



United Publishers Building, 231-249 West 39th Street. View northwest 59

**Architectural Resources**  
**Printing Industry Resources**  
Figure 9-40





Finck Building, 316-326 West 39th Street. View southwest 60



344-348 West 38th Street. View south. 61

## Architectural Resources Printing Industry Resources

Figure 9-41



Underhill Building, 438-448 West 37th Street. View southeast **62a**



Detail of Underhill Building, 438-448 West 37th Street **62b**

**Architectural Resources**  
**Printing Industry Resources**

Figure 9-42



424 West 33rd Street, View south 63



406-426 West 31st Street. View southwest 64

**Architectural Resources**  
**Printing Industry Resources**

Figure 9-43



523-539 Ninth Avenue. View southwest 65



347-353 West 44th Street. View north 66

**Architectural Resources**  
**Hell's Kitchen Residential Resources**

Figure 9-44



446-448 West 44th Street. View south 67



454 West 44th Street. View south 68

**Architectural Resources**  
**Hell's Kitchen Residential Resources**  
Figure 9-45



309 West 43rd Street. View north 69



417-419 West 43rd Street. View northeast 70

**Architectural Resources**  
**Hell's Kitchen Residential Resources**  
Figure 9-46



435 West 43rd Street. View north 71



Model Tenements, 500, 502, and 506 West 42nd Street. View southwest 72

**Architectural Resources**  
**Hell's Kitchen Residential Resources**  
Figure 9-47



274 West 40th Street. View southeast 73

**Architectural Resources**  
**Hell's Kitchen Residential Resources**  
Figure 9-48





408 West 39th Street. View south 74



Former Barbour Dormitory, 330 West 36th Street 75

**Architectural Resources**  
**Hell's Kitchen Residential Resources**  
Figure 9-49



346 West 36th Street. View south 76



367 West 35th Street. View north 77

**Architectural Resources**  
**Hell's Kitchen Residential Resources**  
Figure 9-50



463 west 35th Street. View east from Tenth Avenue 78



William F. Sloan Memorial YMCA, 360 West 34th Street. View south 79

**Architectural Resources**  
**Hell's Kitchen Residential Resources**  
Figure 9-51



Webster Apartments, 419 West 34th Street. View northeast 80

**Architectural Resources**  
**Hell's Kitchen Residential Resources**  
Figure 9-52



Former Second German Baptist Church, 407 West 43rd Street. View north 81

**Architectural Resources**  
**Hell's Kitchen Institutional Resources**  
Figure 9-53



St. Raphael Roman Catholic Church and Rectory, 502-504 West 41st Street. View west **82a**



St. Raphael Roman Catholic Church and Rectory, 502-504 West 41st Street. View north from West 40th Street **82b**

**Architectural Resources**  
**Hell's Kitchen Institutional Resources**  
Figure 9-54



Christ Church Memorial, 334-344 West 36th Street, View southwest 83a



Christ Church Memorial, 334-344 West 36th Street. View south 83b

**Architectural Resources**  
**Hell's Kitchen Institutional Resources**

Figure 9-55



West Side Jewish Center, 347 West 34th Street. View north 84



St. Michael's Roman Catholic Church Complex, 414-424 West 34th Street. View south of church and rectory 85a

**Architectural Resources**  
**Hell's Kitchen Institutional Resources**  
Figure 9-56





St. Michael's Roman Catholic Church Complex, 409-429 West 33rd Street. View west of vestry, church, convent, and school **85b**



Glad Tidings Tabernacle, 325-329 West 33rd Street. View north **86**

**Architectural Resources**  
**Hell's Kitchen Institutional Resources**  
 Figure 9-57



Former New York Public Library West 40th Street Branch, 457 West 40th Street. View north **87**



Former Manhattan Opera House, 311 West 34th Street. View northwest **88**

**Architectural Resources**  
**Hell's Kitchen Institutional Resources**  
Figure 9-58



Former Otis Elevator Company, 246-260 Eleventh Avenue. View north 89



Former New York Edison Company, 308-312 West 36th Street 90

## Architectural Resources Hell's Kitchen Industrial Resources

Figure 9-59



343-345 West 39th Street. View north 91



Former Franco-American Baking Company, 509-517 West 38th Street. View north 92

**Architectural Resources**  
**Hell's Kitchen Industrial Resources**  
Figure 9-60



500 West 37th Street. View southwest from Tenth Avenue 93



Former Pinehill Crystal Spring Water Company, 500-504 West 36th Street. View west from Tenth Avenue 94

**Architectural Resources**  
**Hell's Kitchen Industrial Resources**  
Figure 9-61



Former Gledhill Wall Paper Company. 541-545 West 34th Street. View north 95

**Architectural Resources**  
**Hell's Kitchen Industrial Resources**  
Figure 9-62



Cheyenne Diner, 411 Ninth Avenue. View west 96

**Architectural Resources**  
**Hell's Kitchen Commercial Resources**  
Figure 9-63



Former Hess Brothers Confectionery Factory, 502-504 **97**  
West 30th Street. View southwest



Former Charles P. Rodgers and Co. Building, 517-523 **98**  
West 29th Street. View north

**Architectural Resources**  
**Chelsea Industrial Resources**  
Figure 9-64





Former W&J Sloane Warehouse, 541-561 West 29th Street. View northeast from Eleventh Avenue 99



550 West 29th Street. View south 100

**Architectural Resources  
Chelsea Industrial Resources**

Figure 9-65



Former Berlin & Jones Envelope Company, 547-553 West 27th Street. View northeast 101



241-245 West 26th Street. View north 102

**Architectural Resources  
Chelsea Industrial Resources**

Figure 9-66



537-547 West 26th Street. View north 103



Standard Oil Offices, 551-555 West 25th Street. View north 104

**Architectural Resources**  
**Chelsea Industrial Resources**  
Figure 9-67



Hotel Pennsylvania, 401 Seventh Avenue. View east 105



Former Equitable Life Assurance Company, 383-399  
Seventh Avenue. View southeast 106

## Architectural Resources Commercial Resources Near Penn Station

Figure 9-68



Former Governor Clinton Hotel, 371-377 Seventh Avenue. **107**  
View southeast



New Yorker Hotel, 481-497 Eighth Avenue. View west on 34th Street **108**

## Architectural Resources Commercial Resources Near Penn Station

Figure 9-69



Pennsylvania Building, 225 West 34th Street. View northeast 109



Former J.C. Penney Building, 330 West 34th Street, View southeast 110

**Architectural Resources**  
**Commercial Resources Near Penn Station**  
Figure 9-70



**Legend**

— Proposed Rezoning Area Boundary	■ Potential Development Sites
- - - Project Area Boundary	■ Projected Development Sites
- - - Study Area Boundary (400-Foot Perimeter)	■ Existing Buildings to Remain
■ Designated and Eligible Architectural Resources (see Table 9-1)	
— High Line	



**Architectural Resources and Development Sites  
North of West 36th Street  
Figure 9-71**

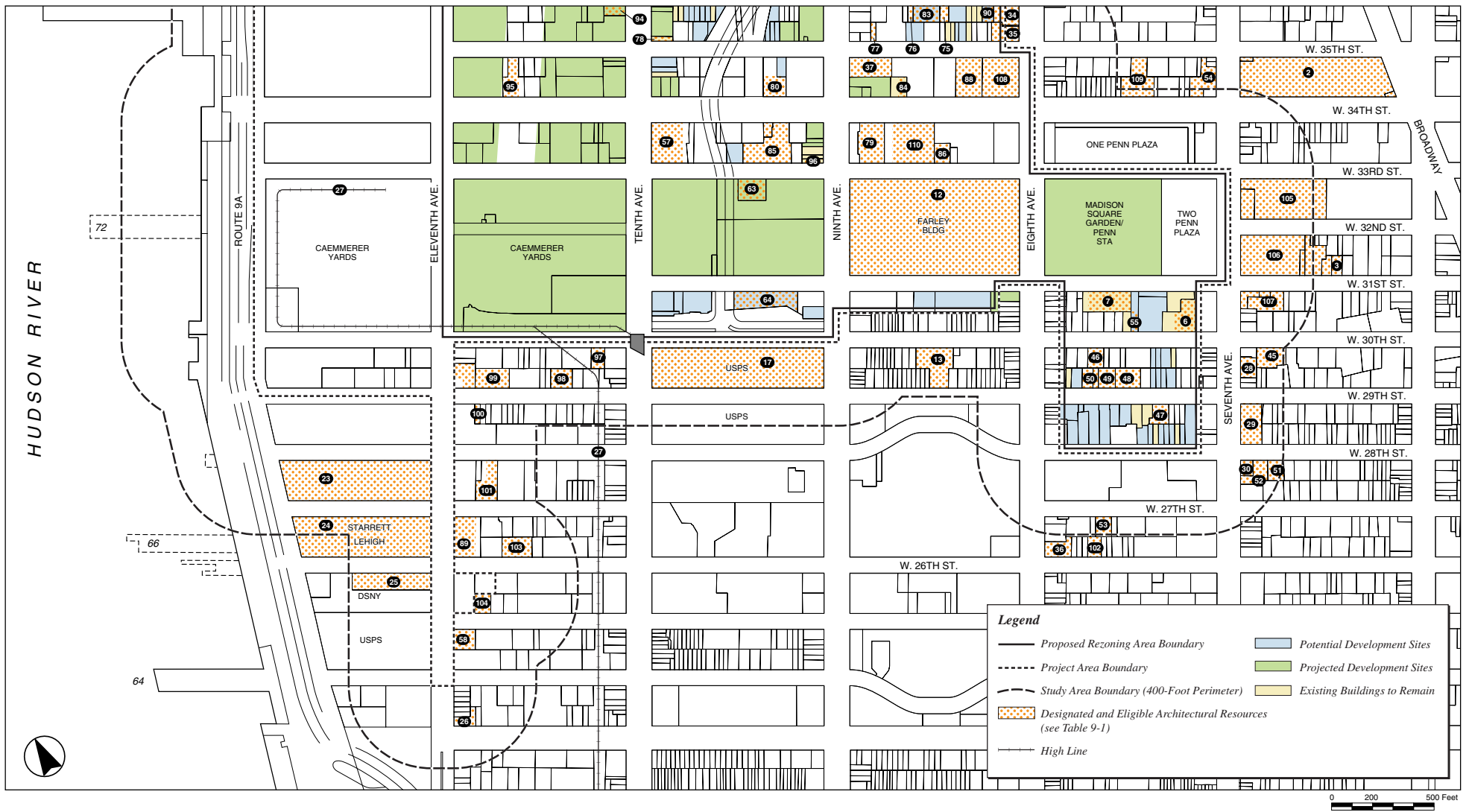

**Architectural Resources and Development Sites South of West 36th Street**  
**Figure 9-72**





Farley Building (12). Existing view west on 33rd Street 111



Farley Building (12). Proposed view west on 33rd Street 112

**Architectural Resources  
Contextual Images**  
Figure 9-73



Hill Building (56). Existing view northwest on Tenth Avenue 113



Hill Building (56). Proposed view northwest on Tenth Avenue 114

**Architectural Resources**  
**Contextual Images**  
Figure 9-74



Model Tenements (72). Existing view west on 42nd Street 115



Model Tenements (72). Proposed view west on 42nd Street 116

**Architectural Resources  
Contextual Images**

Figure 9-75