

Parks

Grand & Lafayette Streets DEP Site

Located at Grand and Lafayette Streets
in the Borough of Manhattan.

Landmarks Preservation Commission Public Hearing
June 25, 2019
Alex Zervos, NYC Parks

Total Budget: \$1.696m
Mayor, Bill de Blasio (DEP) - \$1m FY18
City Council District 1, Margaret Chin - \$626,000 FY20
Borough President, Gale Brewer - \$70,000 FY 20
*Additional funding to be secured \$656,000

Project Size: 0.29ac



Goals

- Create a new passive open space for the public
- Provide a variety of seating areas
- Provide opportunities for temporary art exhibits
- Retain DEP routine and emergency access to existing infrastructure

NEW YORK CITY WATER TUNNELS AND DISTRIBUTION AREAS

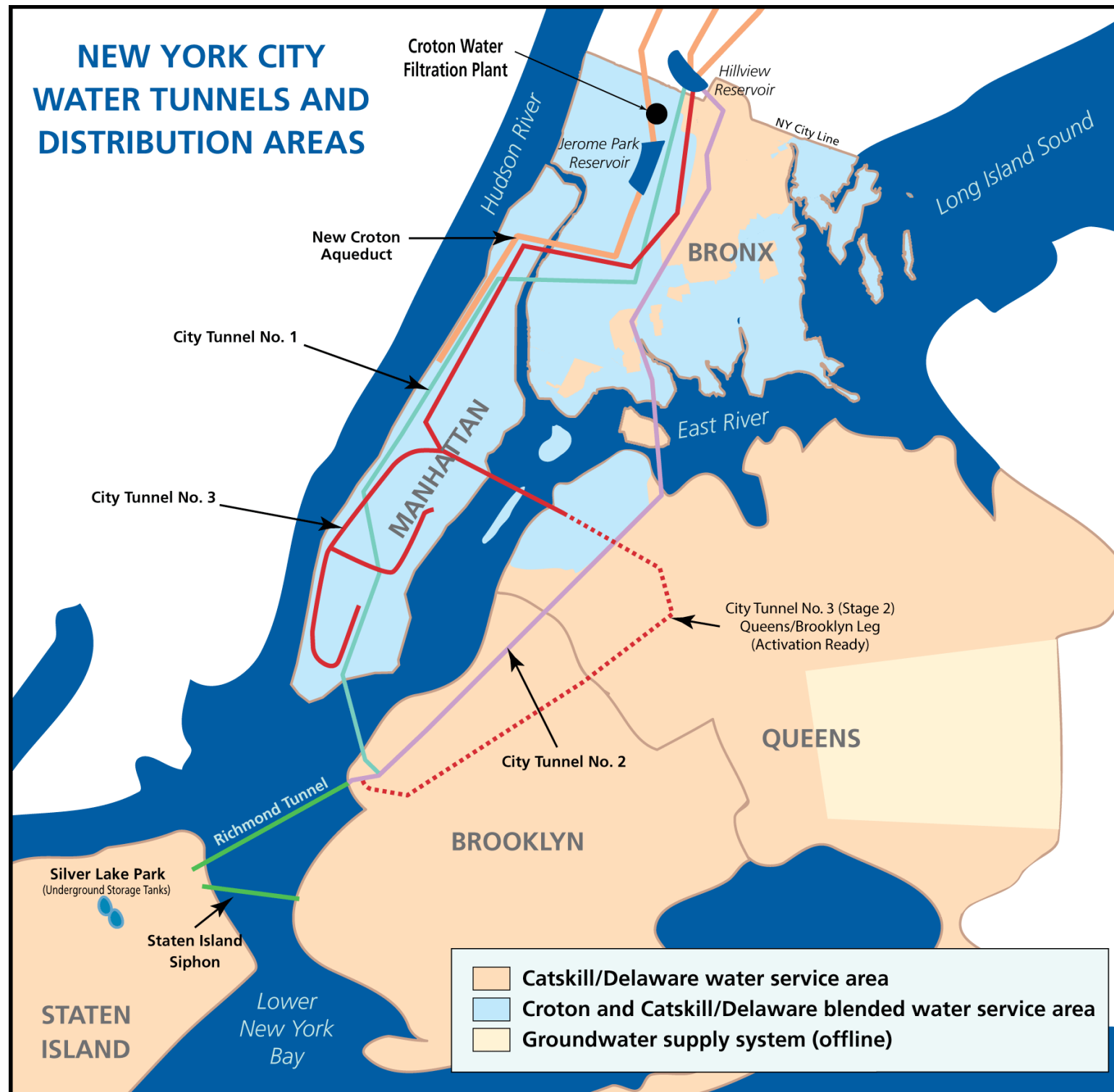



CITY

2 MI
N

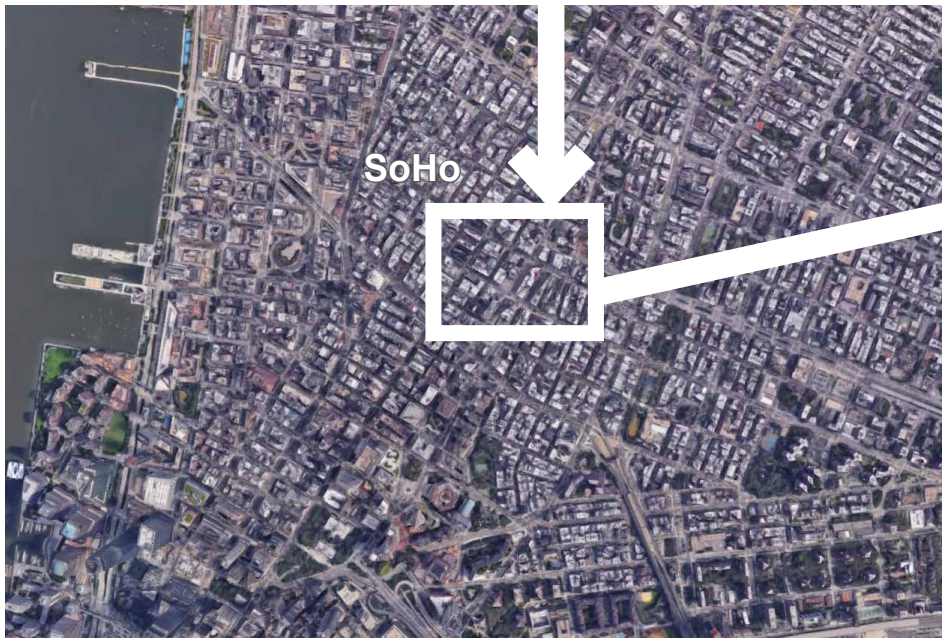

NEIGHBORHOOD

1000 FT
N

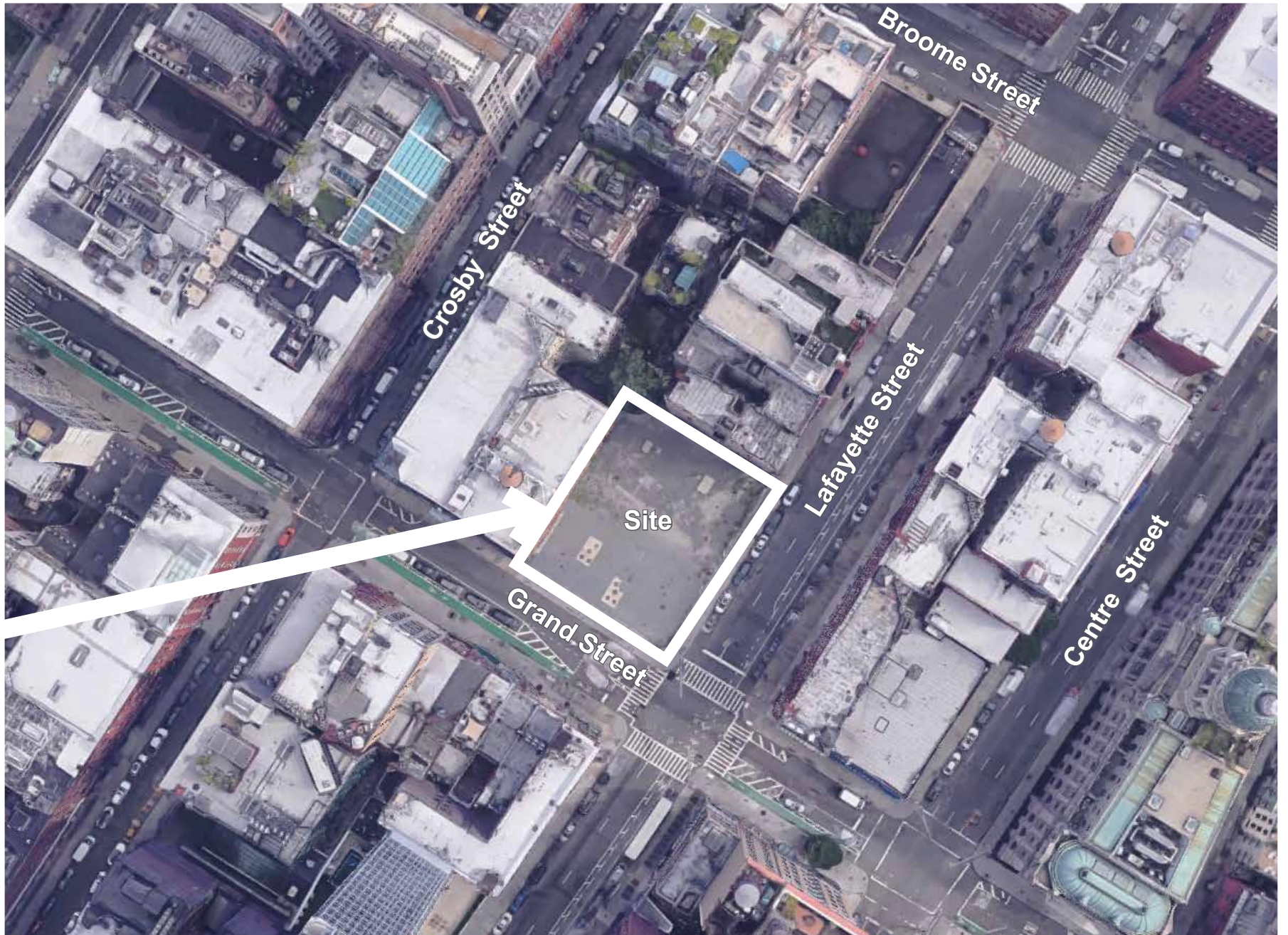

SITE

0' 25' 50' 125' N



NYC Parks

Grand & Lafayette Streets | Site Location

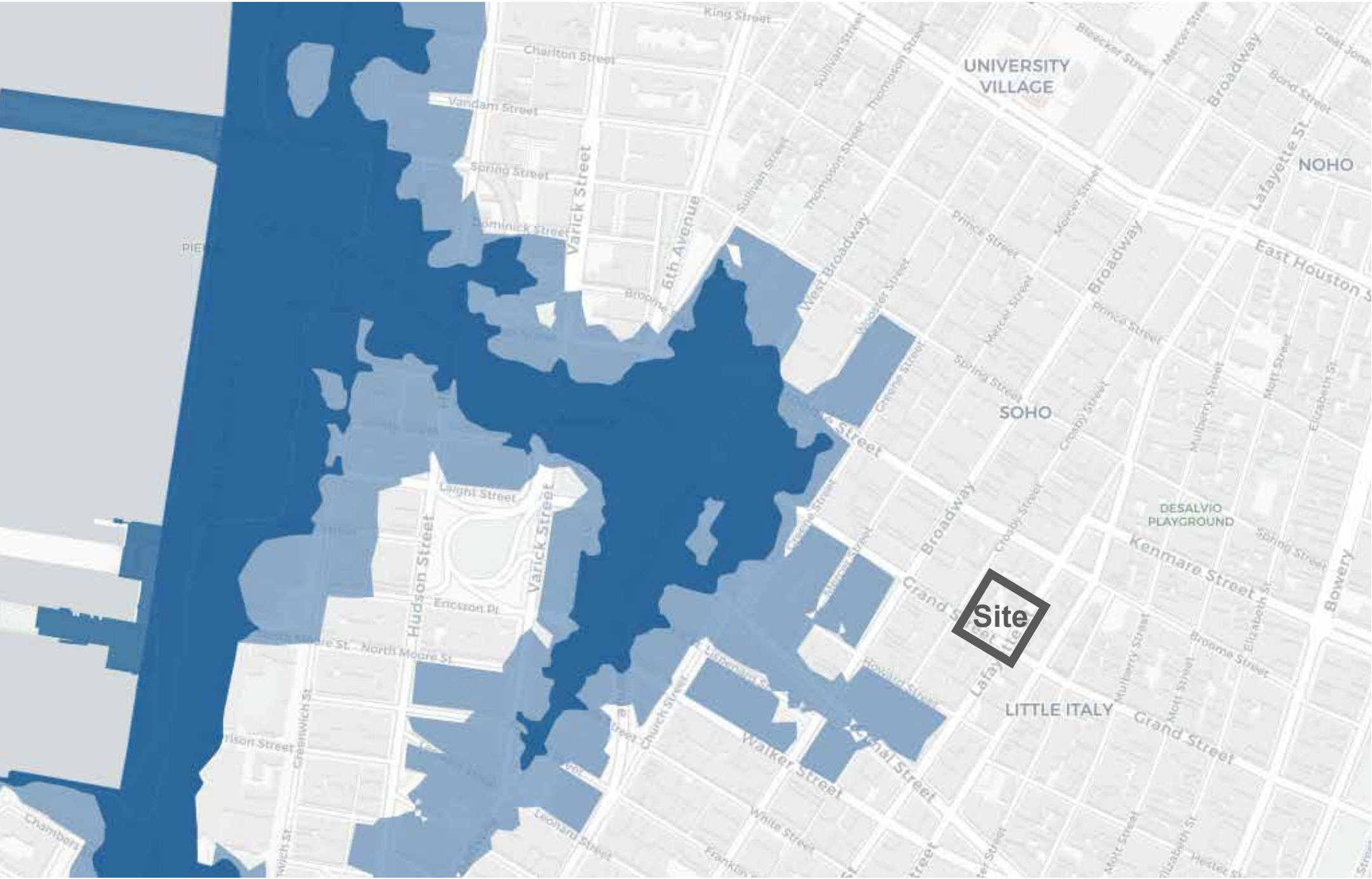

Flood Hazard Zones

2015 Preliminary 100-year Floodplain

1% Annual Chance Floodplain (100 Year Floodplain) The area that has a 1% chance of flooding in any given year.

2050s Projected 100-year Floodplain

The potential areas that could be impacted by the 100-Year flood in the 2050s based on projections of the high-estimate 90th percentile sea level rise scenario (NYC Panel on Climate Change (NPCC) 2015 data).



NYC Parks

Grand & Lafayette Streets | Flood Risk

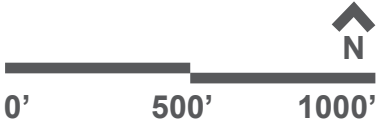

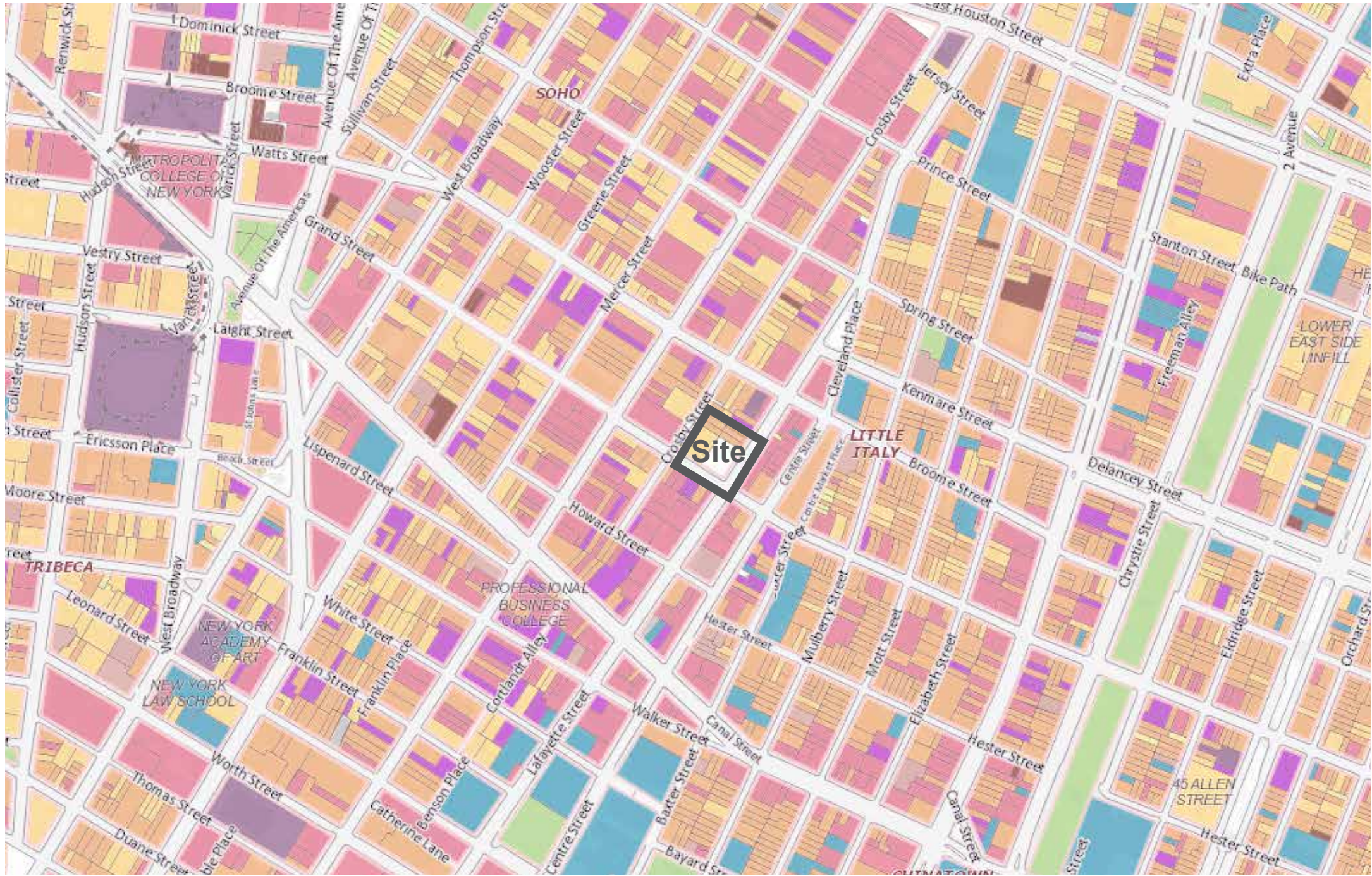

Land Use Categories

- 1 And 2 Family Residential
- Multi-Family Residential
- Mixed Use
- Open Space And Outdoor Recreation
- Commercial
- Institutional
- Industrial
- Parking
- Transportation / Utilities
- Vacant Lots



NYC Parks

Grand & Lafayette Streets | Surrounding Land Use

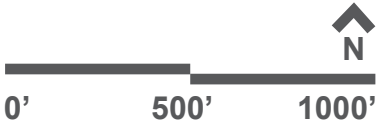

- Vesuvio Playground**
- Basketball Courts
- Handball Courts (3)
- Playground
- Bathroom
- Spray Showers
- Outdoor Pool
- Multi-purpose synthetic turf field

Spring Street Park

Duarte Square

Tribeca Park

Collect Pond Park

Petrosino Square

Sara D. Roosevelt Park
Basketball Courts
Handball Courts (4)
Playgrounds
Soccer Fields
Spray Showers

Columbus Park
Basketball Courts
Playgrounds
Bathrooms
Spray Showers
Multi-purpose synthetic turf field



Grand & Lafayette Streets | Neighborhood Context

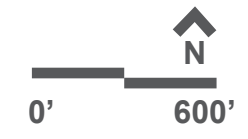

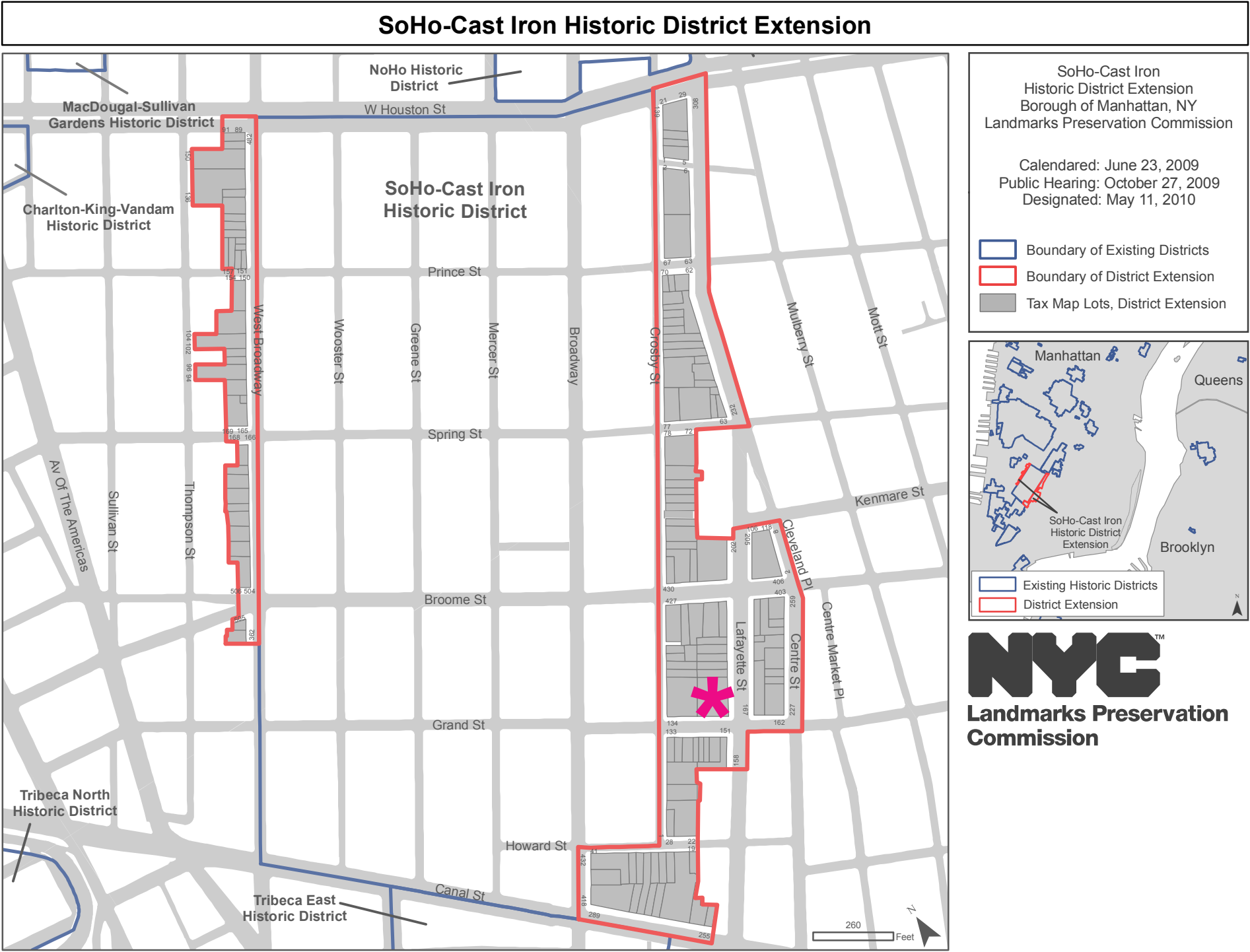

LEGEND

 Site Location

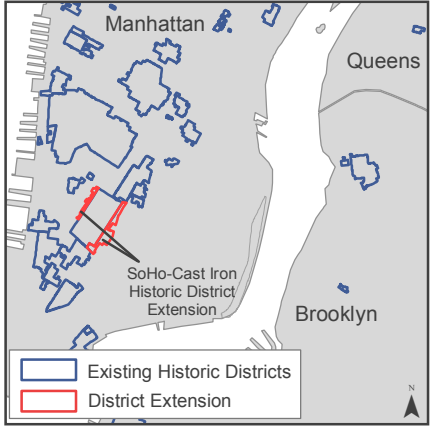



1937 (demolished between 1958 and 1966)



2004



NYC Parks

Grand & Lafayette Streets | Site History



Site Street View - Intersection at Grand and Lafayette Streets



Grand & Lafayette Streets | Site Photos

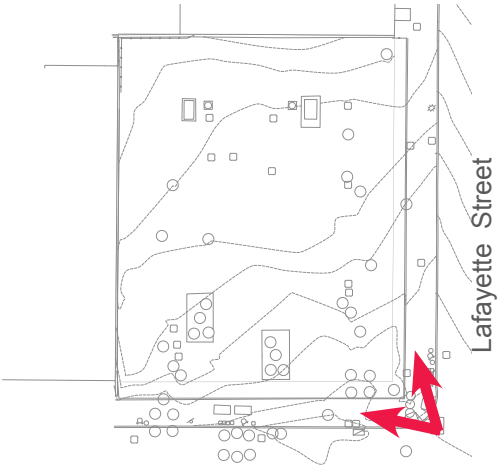

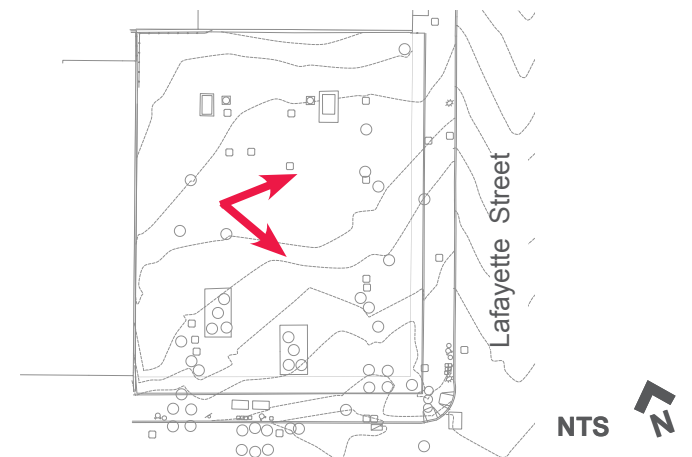

Grand & Lafayette Streets | Site Photos

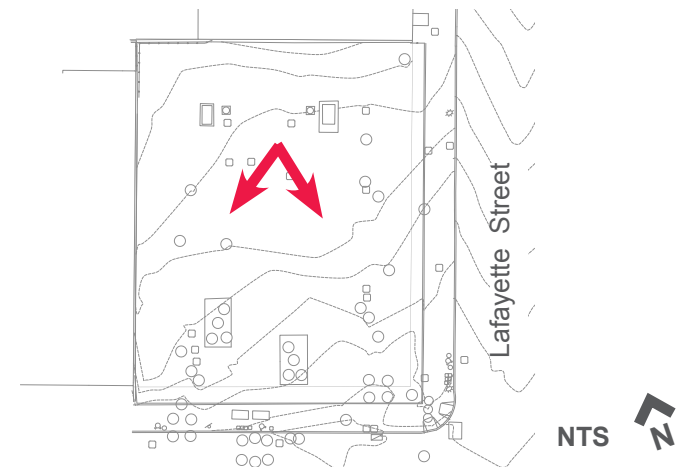

Grand & Lafayette Streets | Site Photos

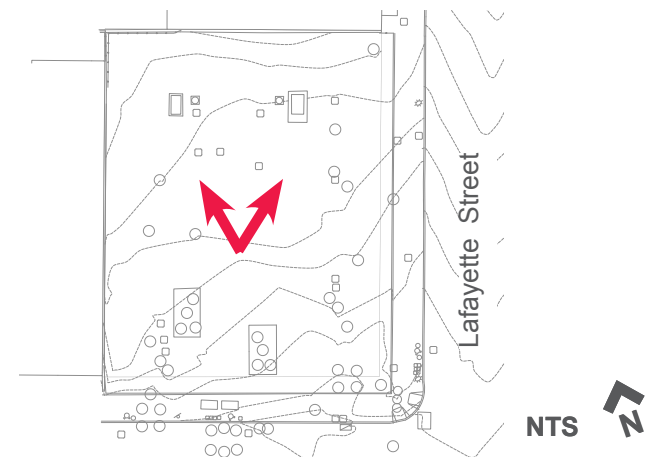
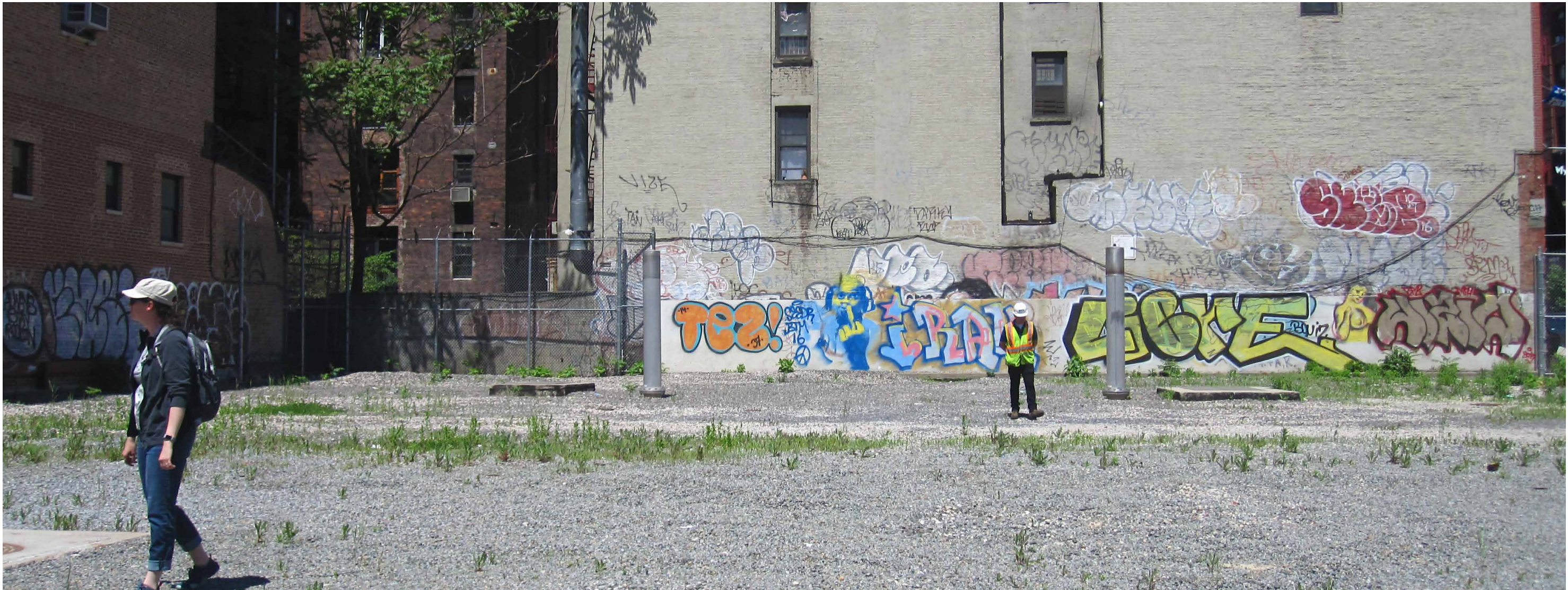

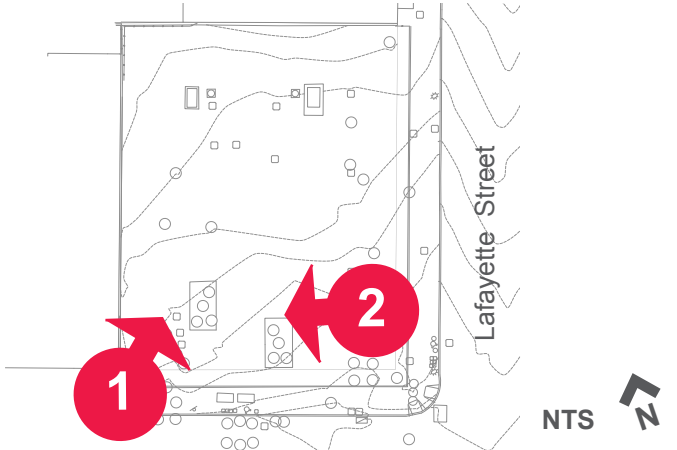
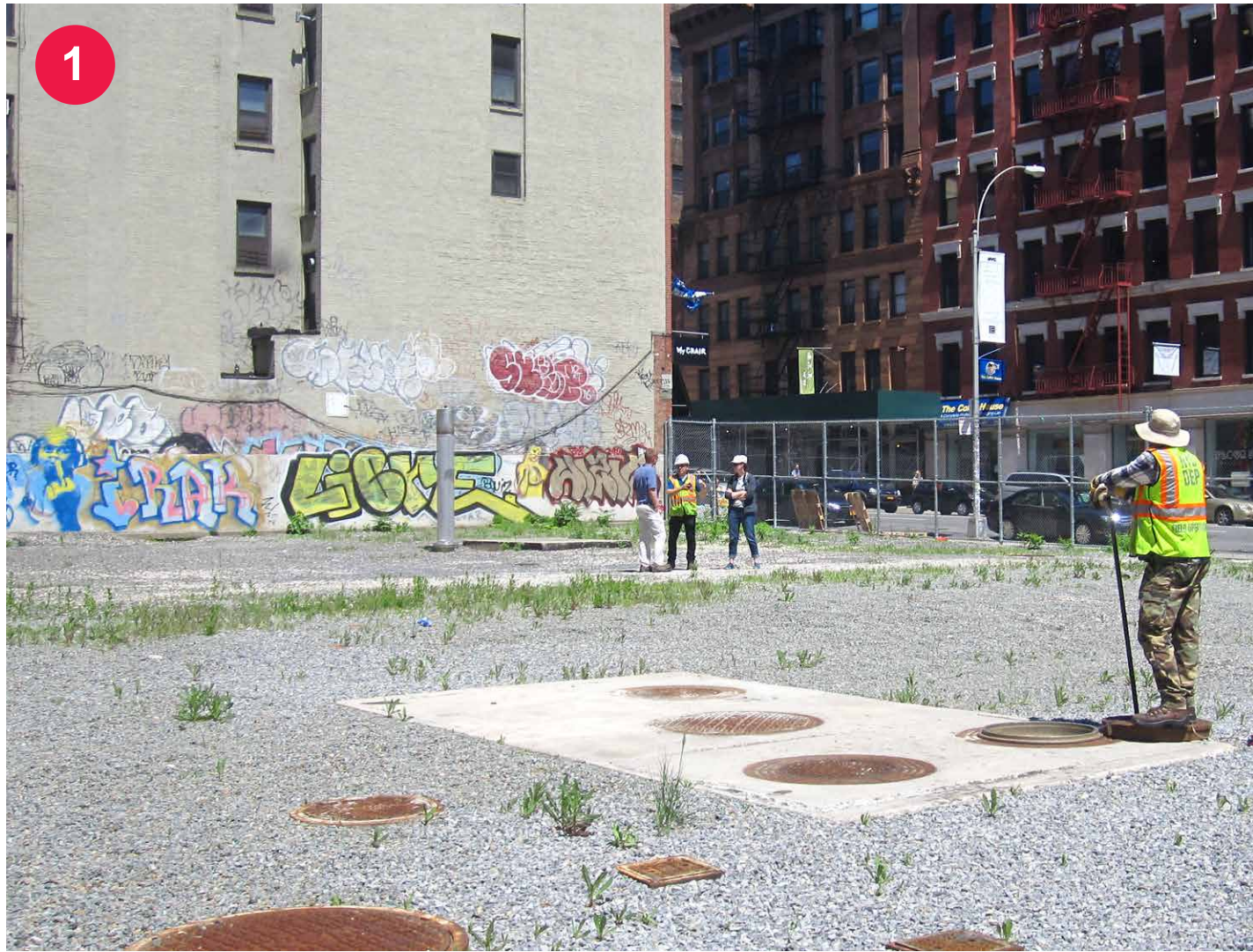

Grand & Lafayette Streets | Site Photos

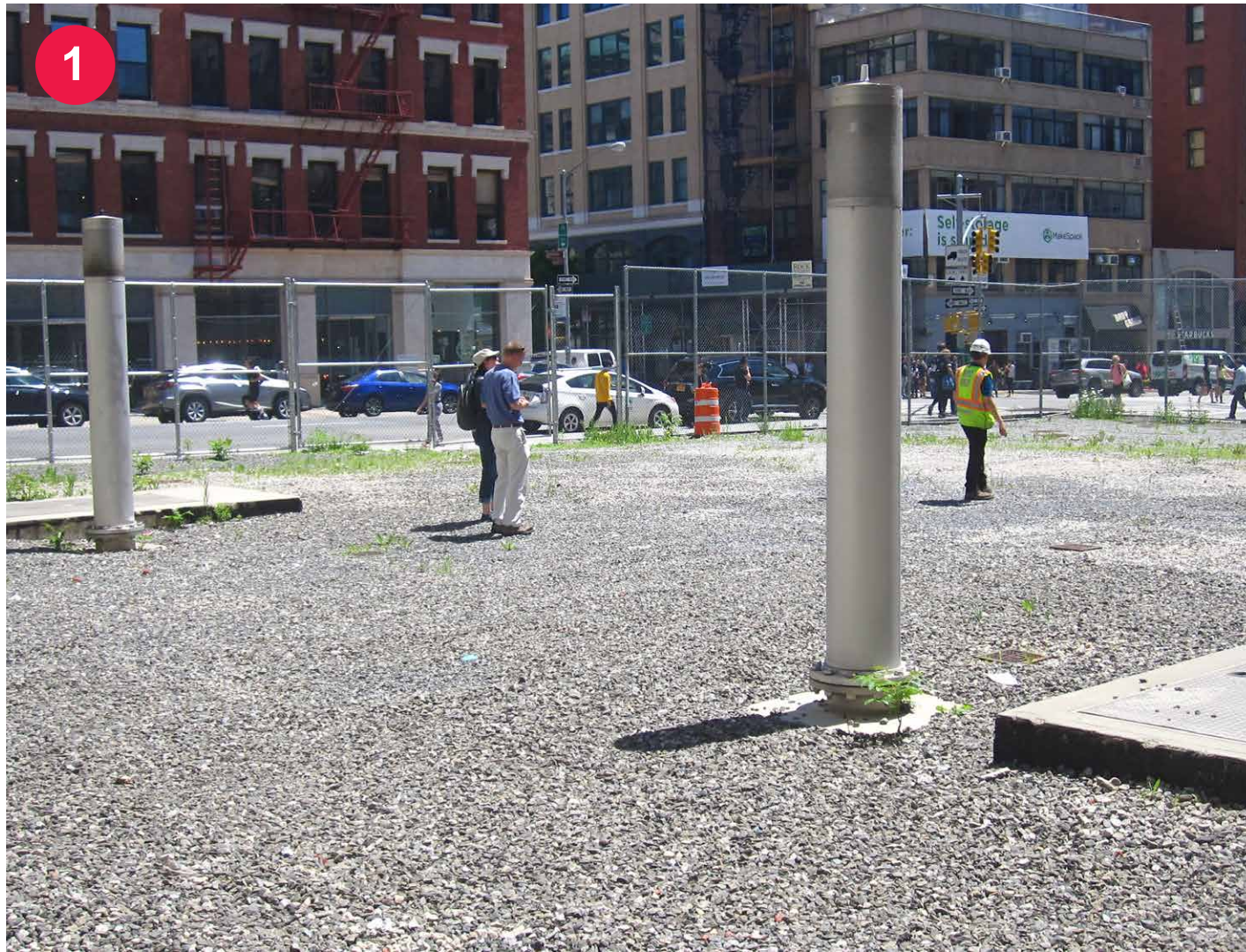

Grand & Lafayette Streets | Site Photos

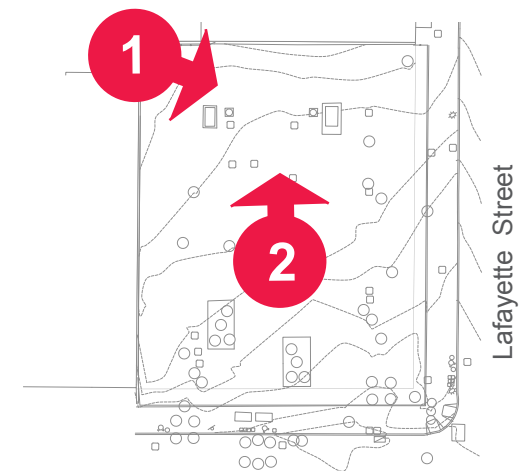

NTS

MARCH 21

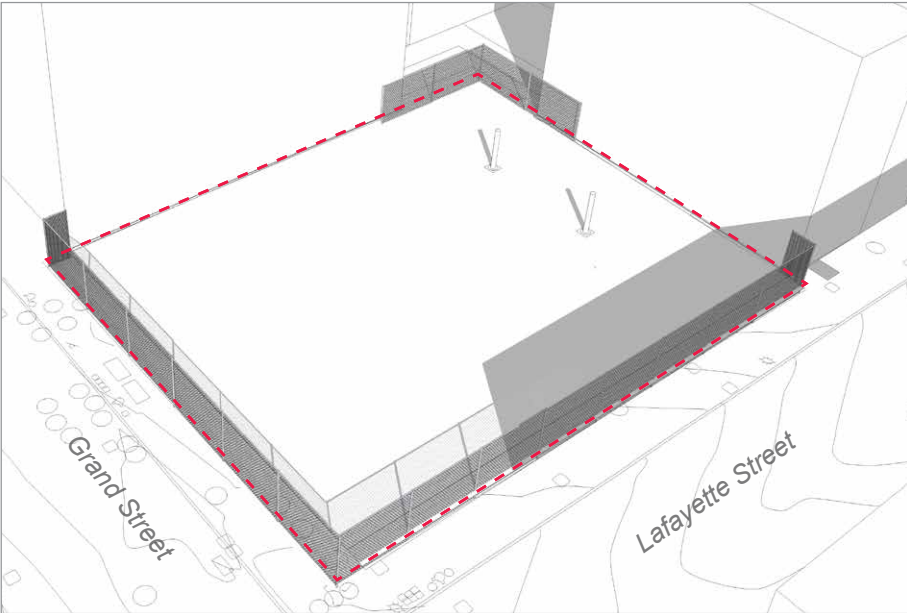

9am

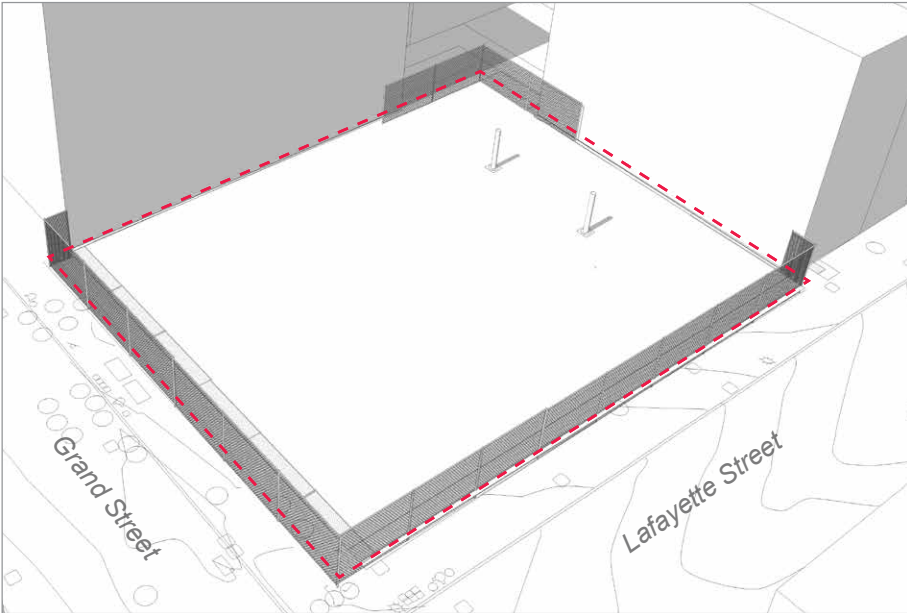

Noon

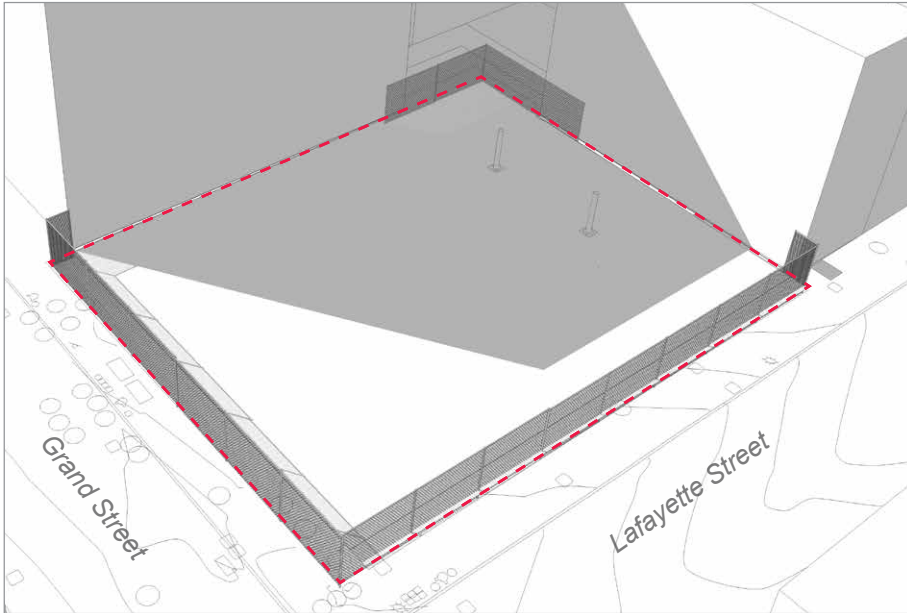

3pm

JUNE 21

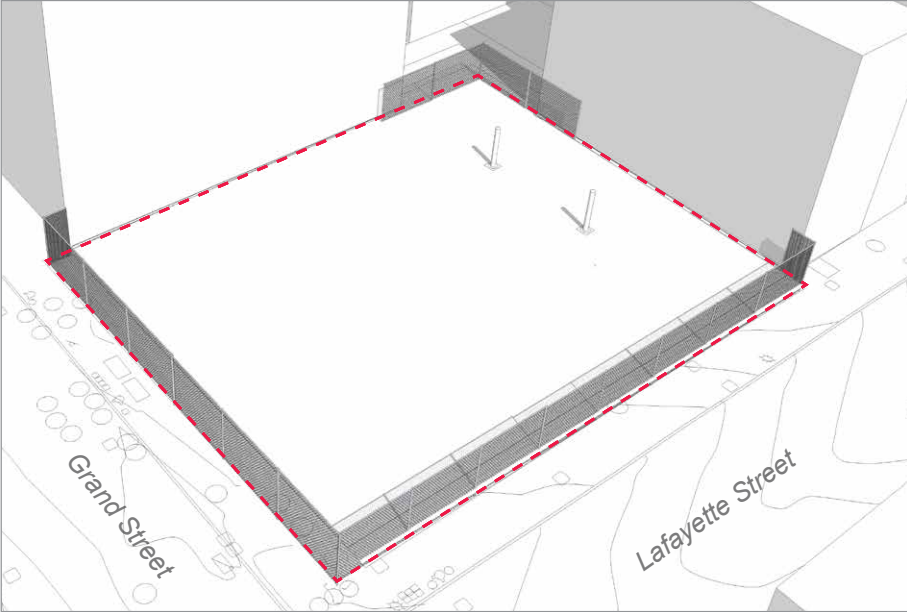

9am

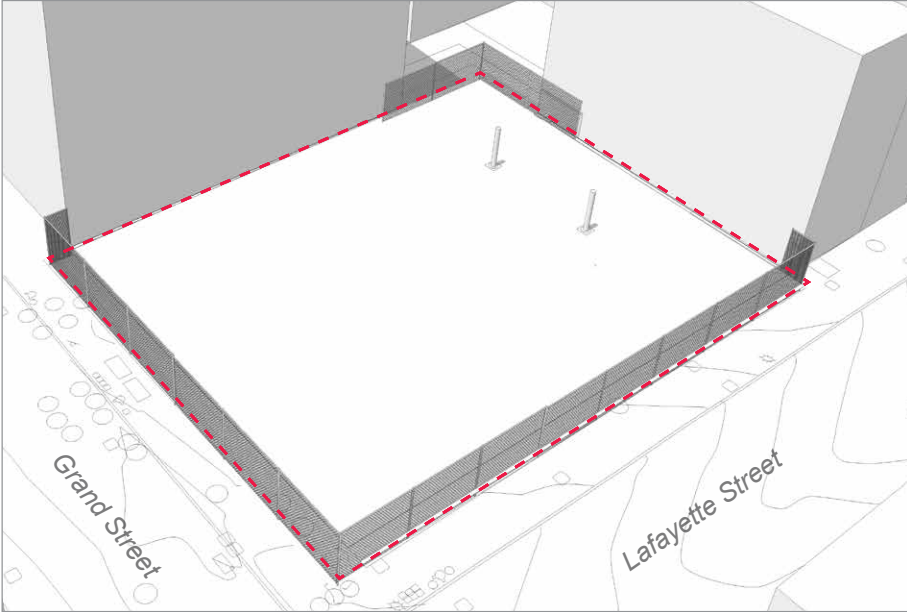

Noon

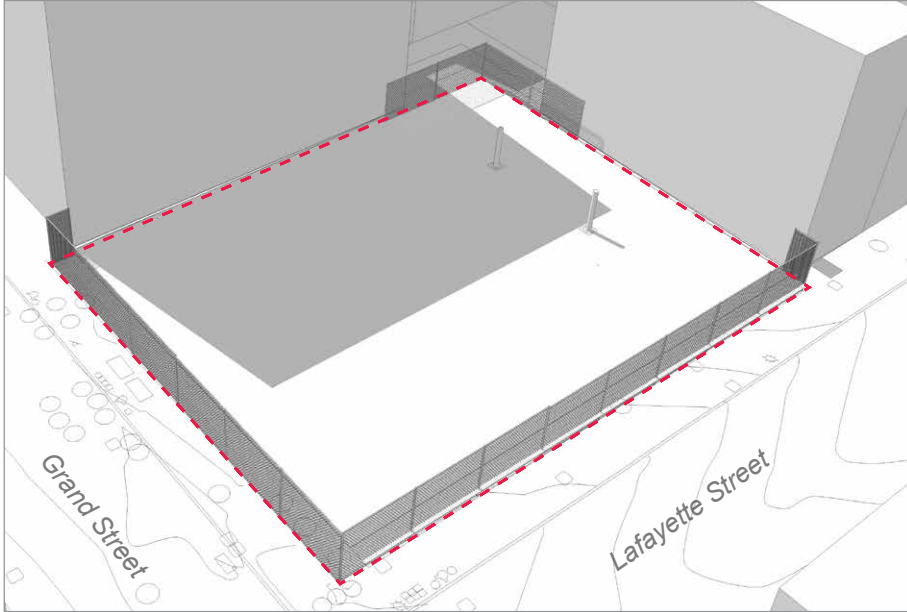

3pm



NYC Parks

Grand & Lafayette Streets | Site Analysis - Sun-Shade Model



SEPTEMBER 21

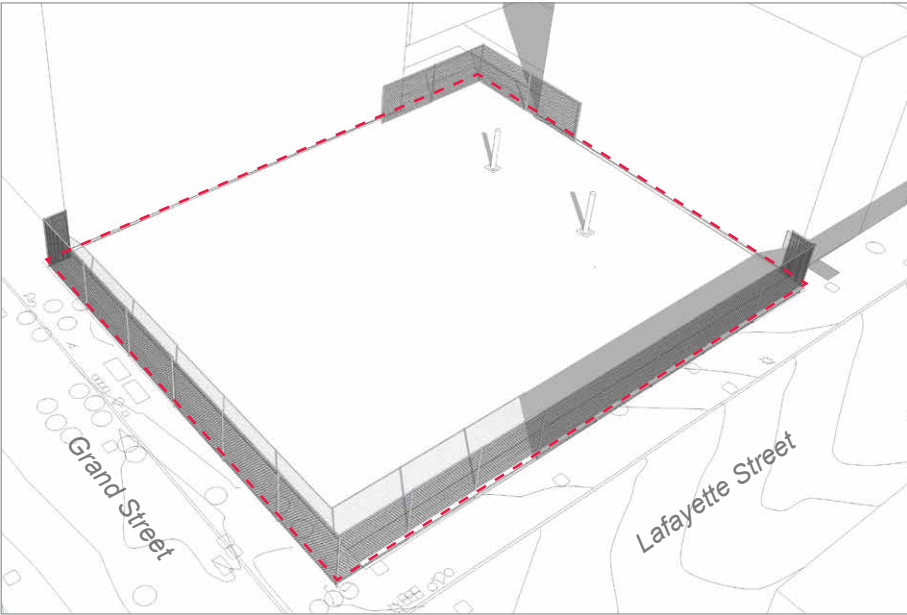

9am

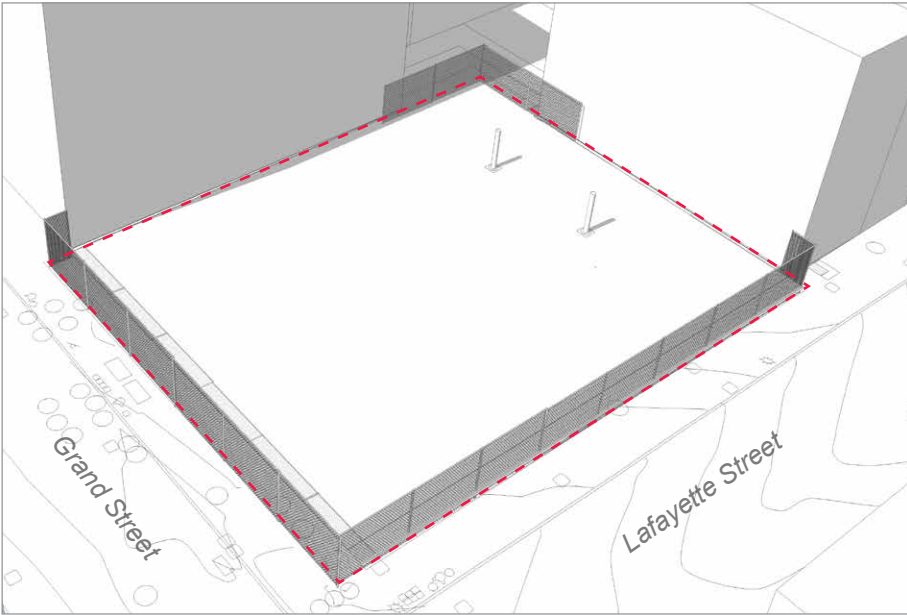

Noon

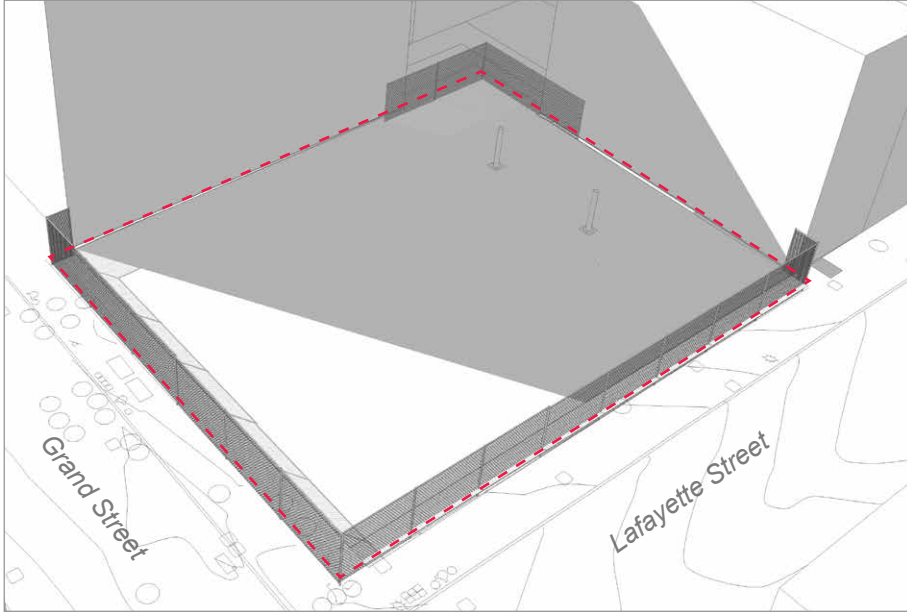

3pm

DECEMBER 21

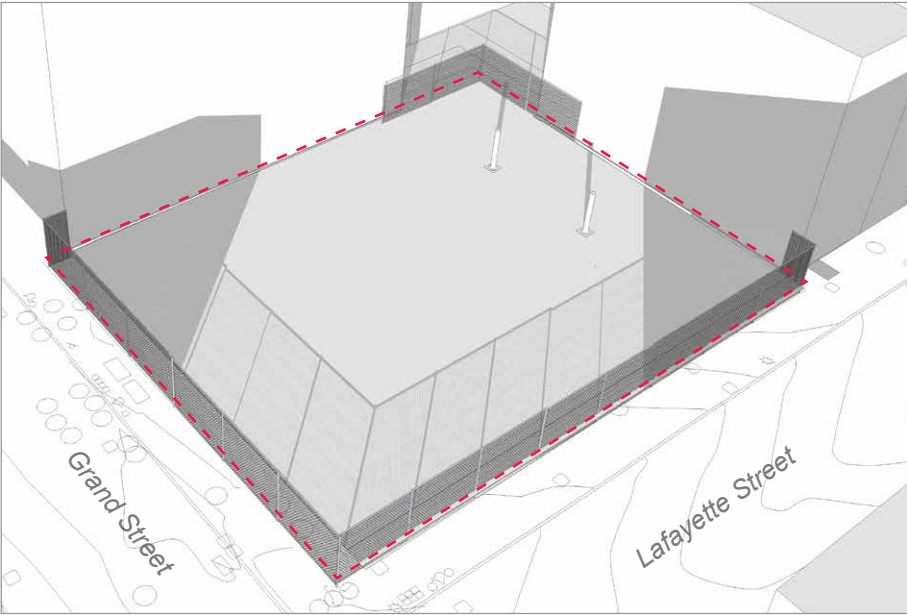

9am

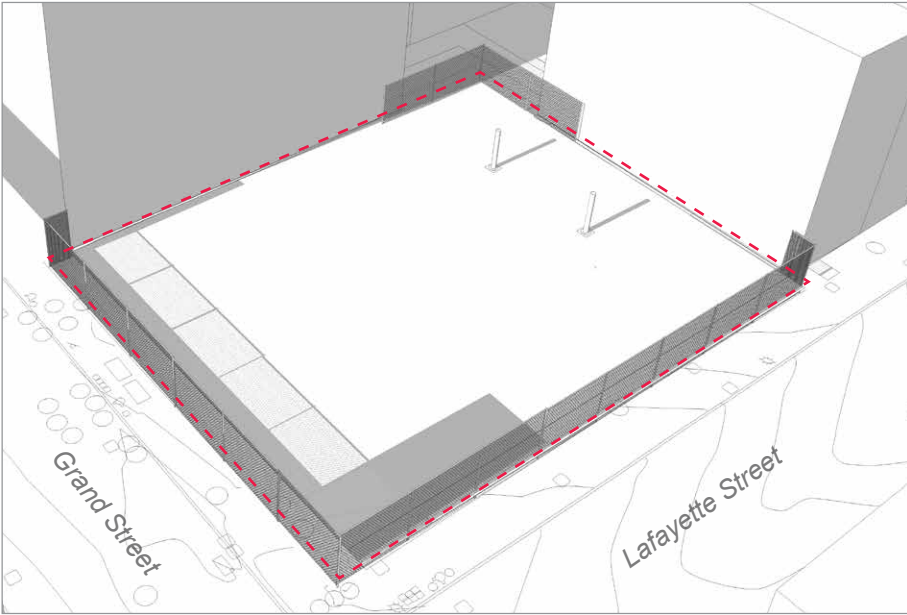

Noon

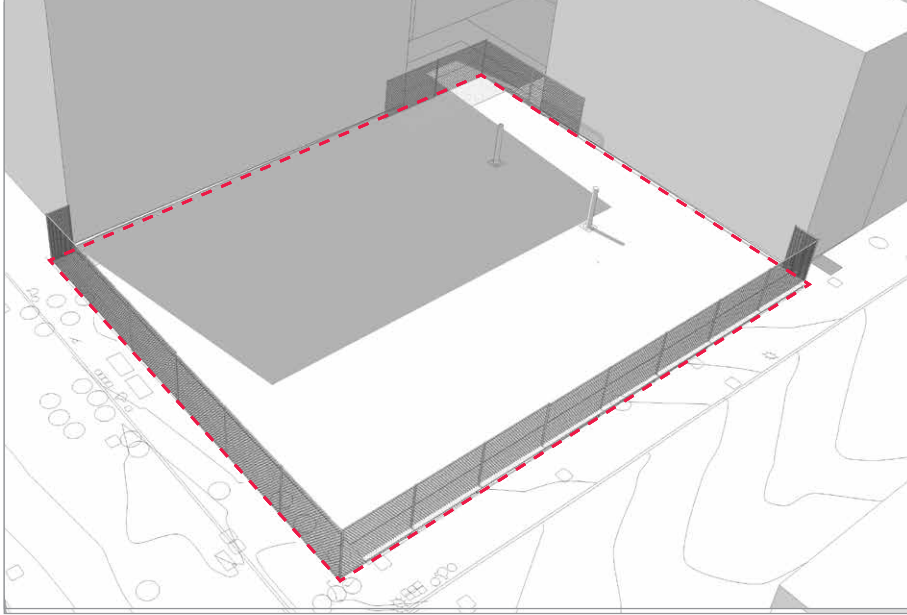

3pm



NYC Parks



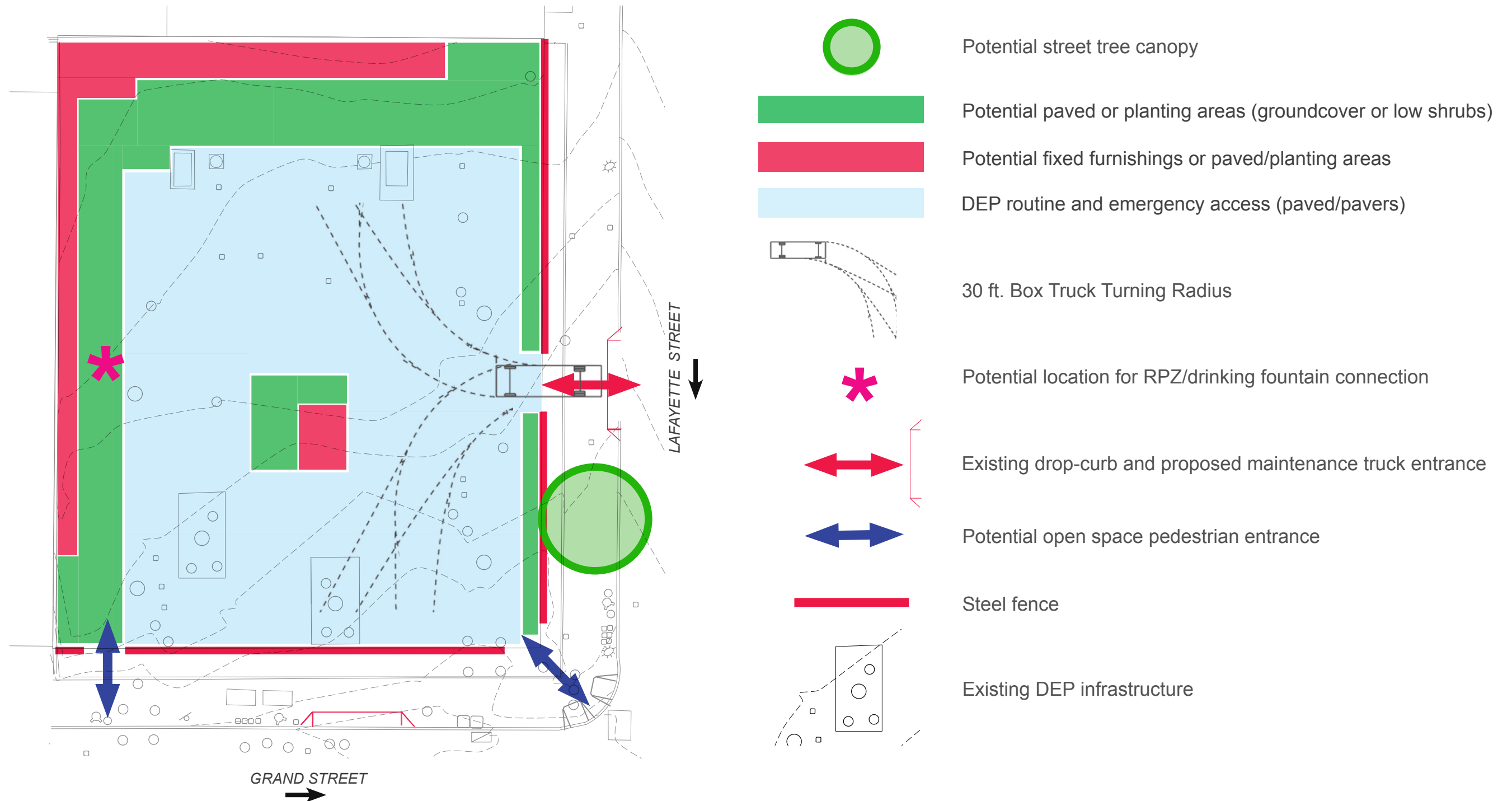



Grand & Lafayette Streets | Schematic Perspective

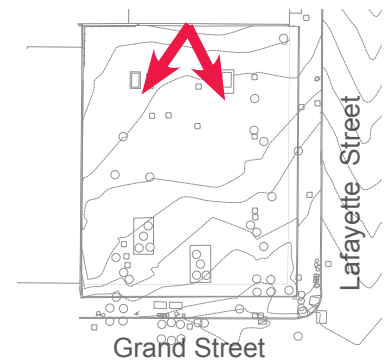

NTS

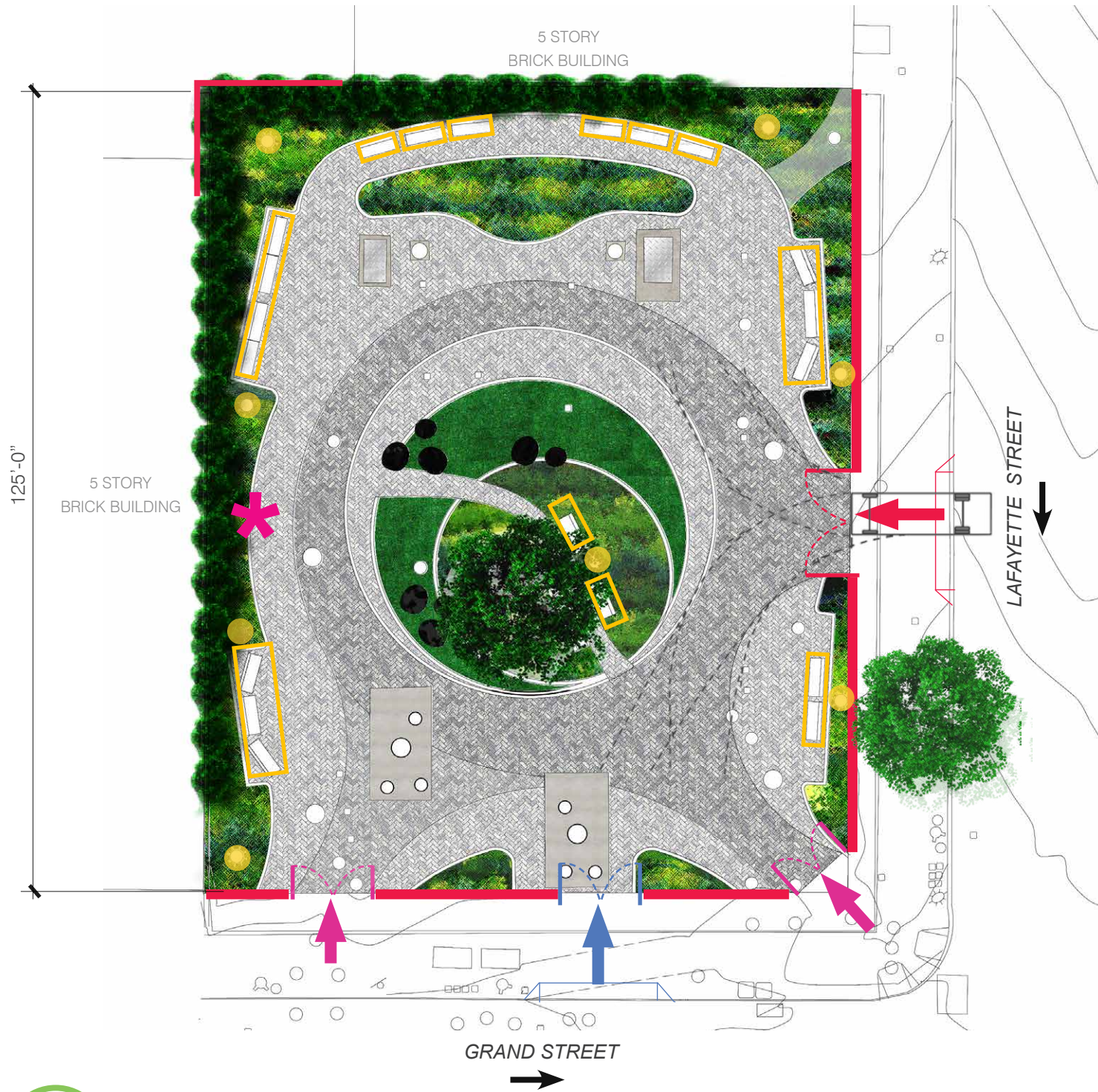

Proposed tree

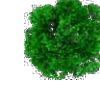

Proposed columnar tree



Fixed concrete encased infrastructure



Planted buffer



Synthetic turf with flush concrete curb
GFRP moveable 'pebble' seating*



Permeable paving (commercial vehicle tolerant)
with flush concrete curb



Existing manholes/valves in permeable paving



Existing covers in concrete pad



Security lighting

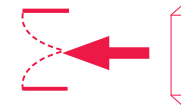

16'-0" wide double gate for maintenance truck
with existing drop-curb



10'-6" wide double gate pedestrian entrance

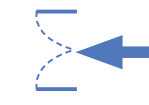

12'-0" wide double gate vehicular entrance
with existing curb



5'-0" ht. steel fence

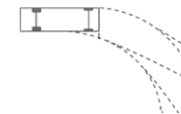

30 ft. Box truck turning radius



Backed benches



Drinking fountain

* final location to be coordinated with DEP



NYC Parks

Grand & Lafayette Streets | Schematic Plan



NYC Parks

Grand & Lafayette Streets | Schematic Isometric





Grand & Lafayette Streets | Schematic Perspective

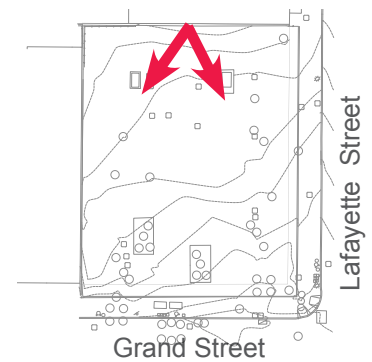

NTS



IRON BENCHES



TYPE B IRON LIGHTPOLE



SOLAR POWERED TRASH RECEPTACLES



BOTTLE FILLER HI-LO DRINKING FOUNTAIN



SYNTHETIC TURF



SEATING

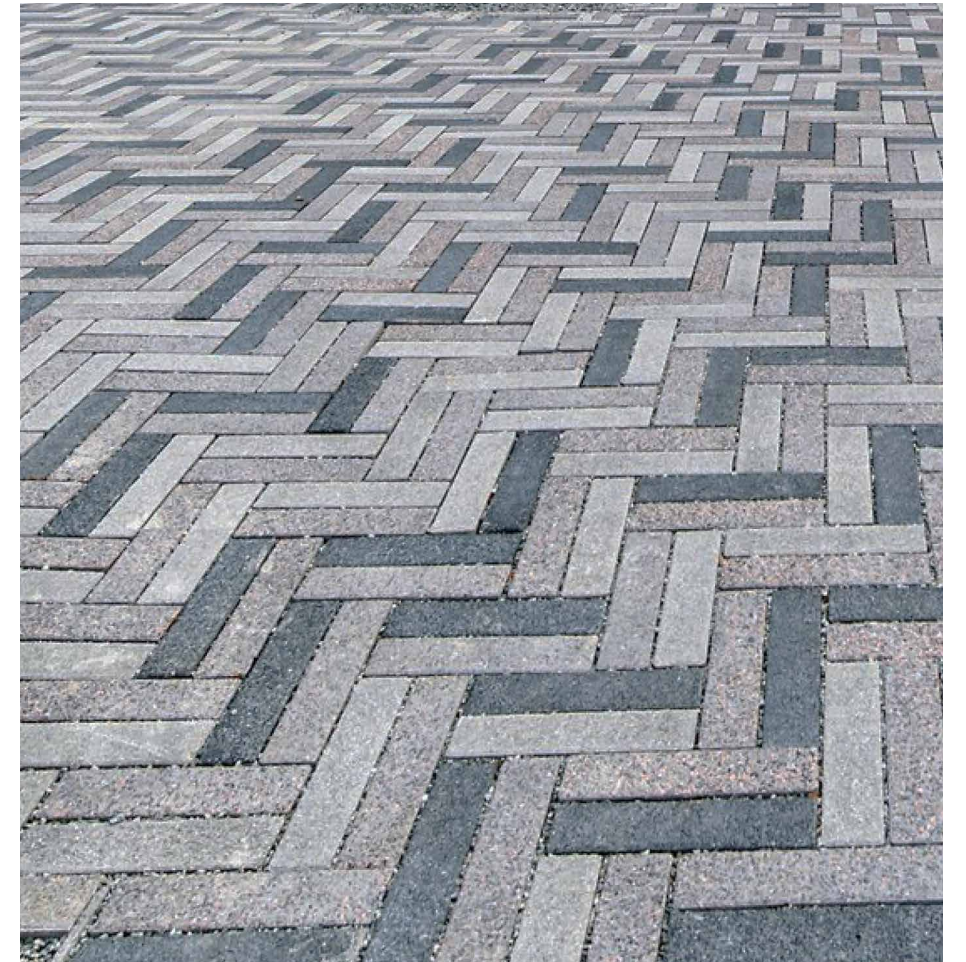

PERMEABLE PAVERS

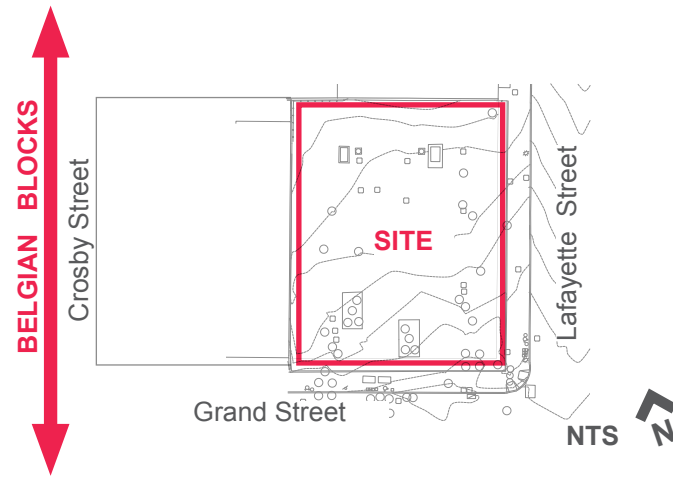

SOHO CAST IRON DISTRICT - NEARBY BELGIAN BLOCKS



CROSBY STREET



ADA COMPLIANT CONCRETE PERMEABLE PAVERS



NYC Parks

Grand & Lafayette Streets | Pavement



STEEL PICKET PERIMETER FENCE



NYC Parks

Grand & Lafayette Streets | Fence



FENCE - CONCRETE CURB

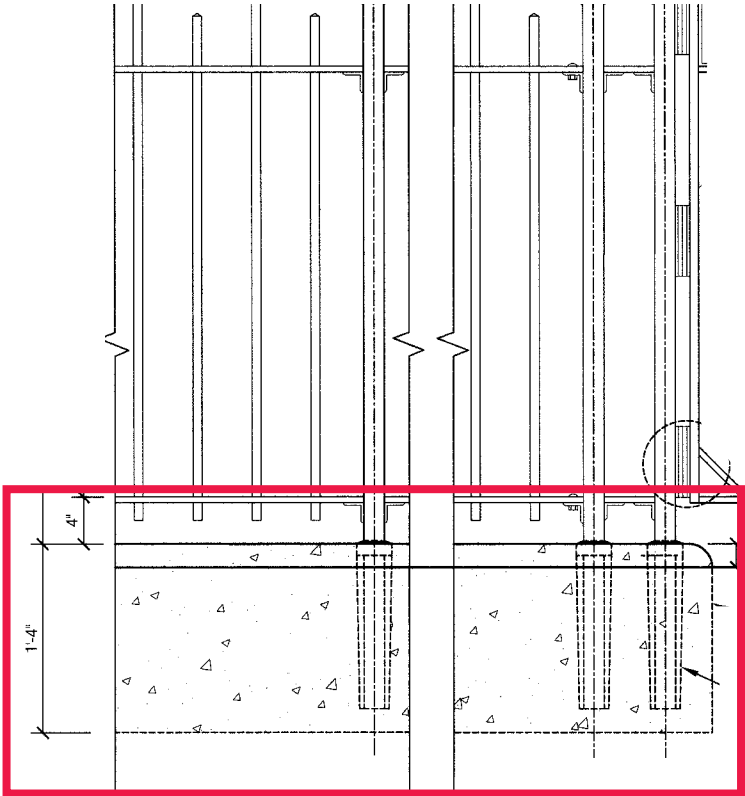



CONCRETEWORKS - GFRC MOVEABLE SITE FURNISHINGS

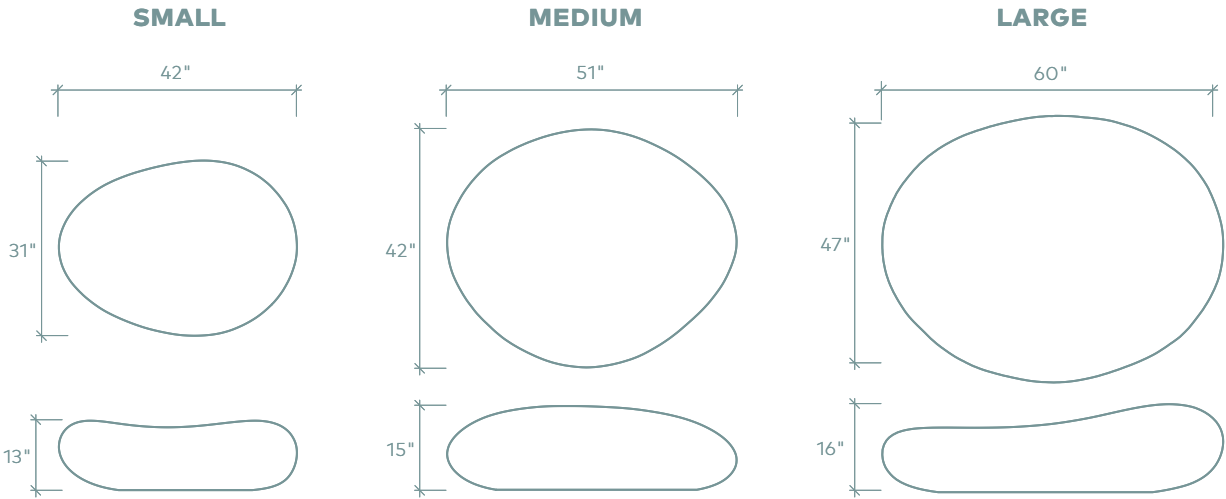

WEIGHTS

| | |
|--------|---------|
| Small | 130 lbs |
| Medium | 230 lbs |
| Large | 300 lbs |



Eastern White Cedar
Thuja occidentalis 'Emerald Green'



Shumard Red Oak
Quercus shumardii



Little Henry Sweetpire
Itea virginica 'Little Henry'



Otto Luyken Cherry Laurel
Prunus laurocerasus 'Otto Luyken'



Showy Goldenrod
Solidago speciosa

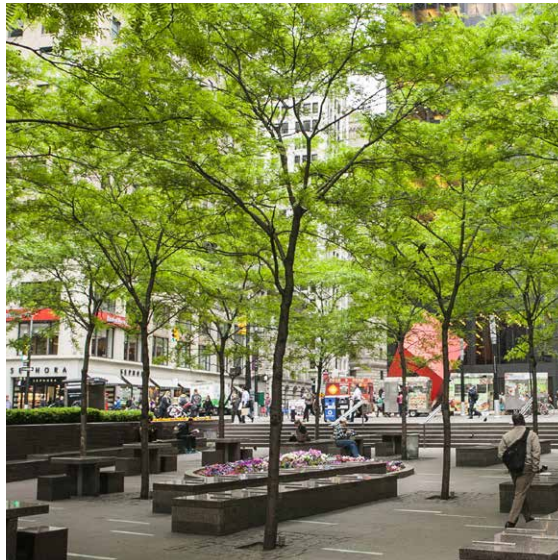

Thornless Honey Locust
Gleditsia triacanthos



Shadblow Serviceberry
Amelanchier canadensis



Mapleleaf Viburnum
Viburnum acerifolia

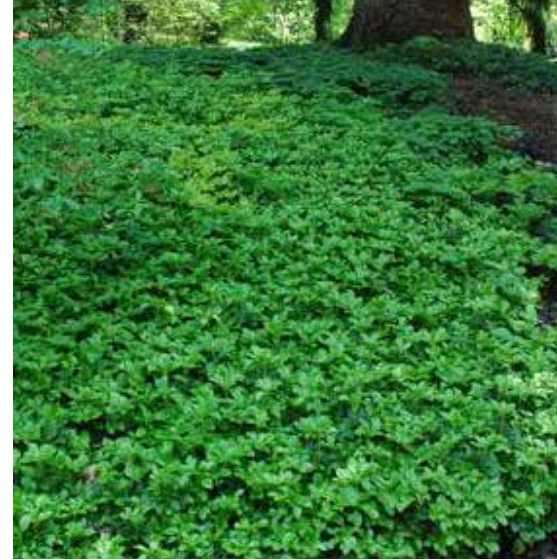

Green Sheen Pachysandra
Pachysandra terminalis 'Green Sheen'



Foamflower
Monarda fistulosa

Springfield Lake Bluebelt

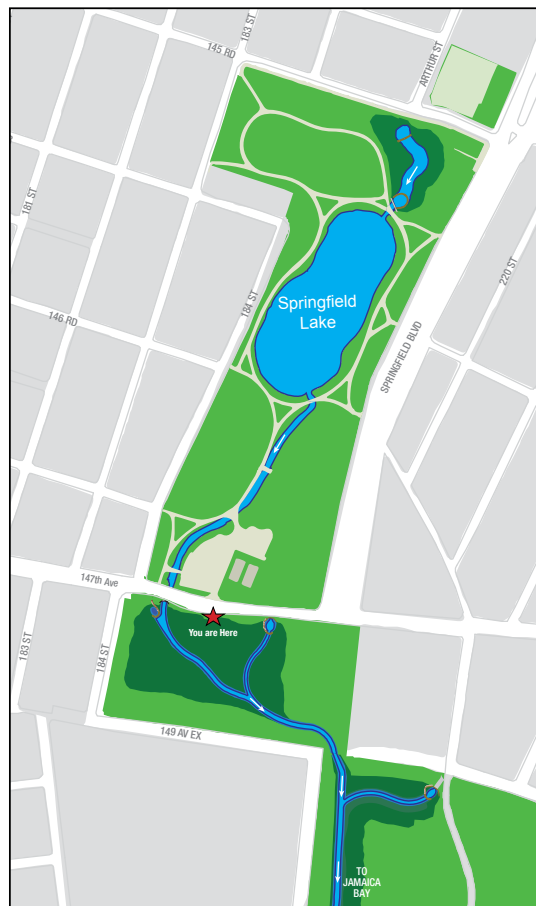

The Springfield Lake Bluebelt is a natural drainage system consisting of three constructed freshwater and tidal wetlands that collect, store, and filter stormwater from the neighborhood's storm sewers. As it flows over roofs, sidewalks, and streets, rain and melted snow pick up and carry along pollutants such as oils, chemicals, bacteria, and sediments. If this polluted stormwater is discharged directly into the city's waterways, it can damage water quality and the wildlife that lives in these habitats.

The Bluebelt captures the stormwater and slows its flow, directing it through a series of channels, weirs, wetlands, and pools. Because the wetlands temporarily store the stormwater, the Bluebelt helps reduce chronic street flooding in the surrounding neighborhood. Additionally, as the stormwater moves through the Bluebelt, it is naturally filtered of pollutants that would otherwise flow directly into Jamaica Bay and endanger its water quality and wildlife.

What Can You Do to Protect the Bluebelt and Jamaica Bay?

- ✓ Pick up pet waste and dispose of it in garbage cans.
- ✓ Keep litter, leaves, and debris out of street gutters and storm drains.
- ✓ Keep septic systems operational.
- ✓ Report illegal pipe connections that divert toilet water to storm sewers.
- ✓ Apply lawn and garden fertilizers and pesticides sparingly and according to directions.
- ✓ Dispose of used oil, antifreeze, paints, and other household chemicals properly—never pour them in storm drains!

For more information or to report a problem at the Springfield Lake Bluebelt, call 311.

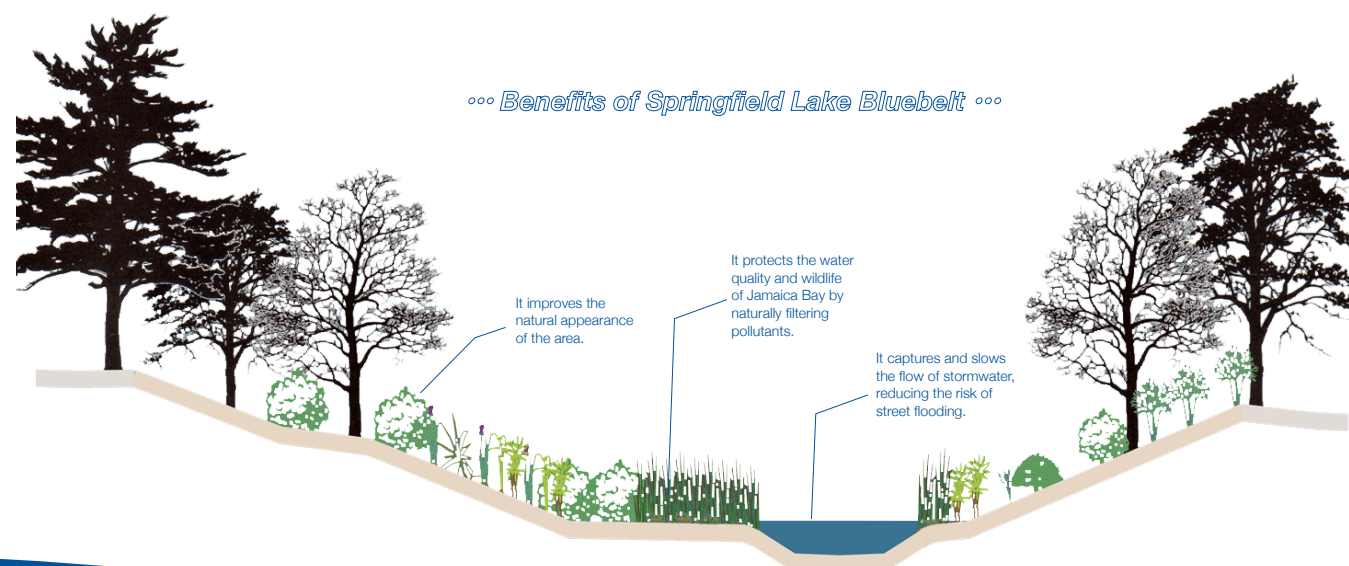

NYC Parks

Grand & Lafayette Streets | Signage Precedent



Existing Permeability: **99%**

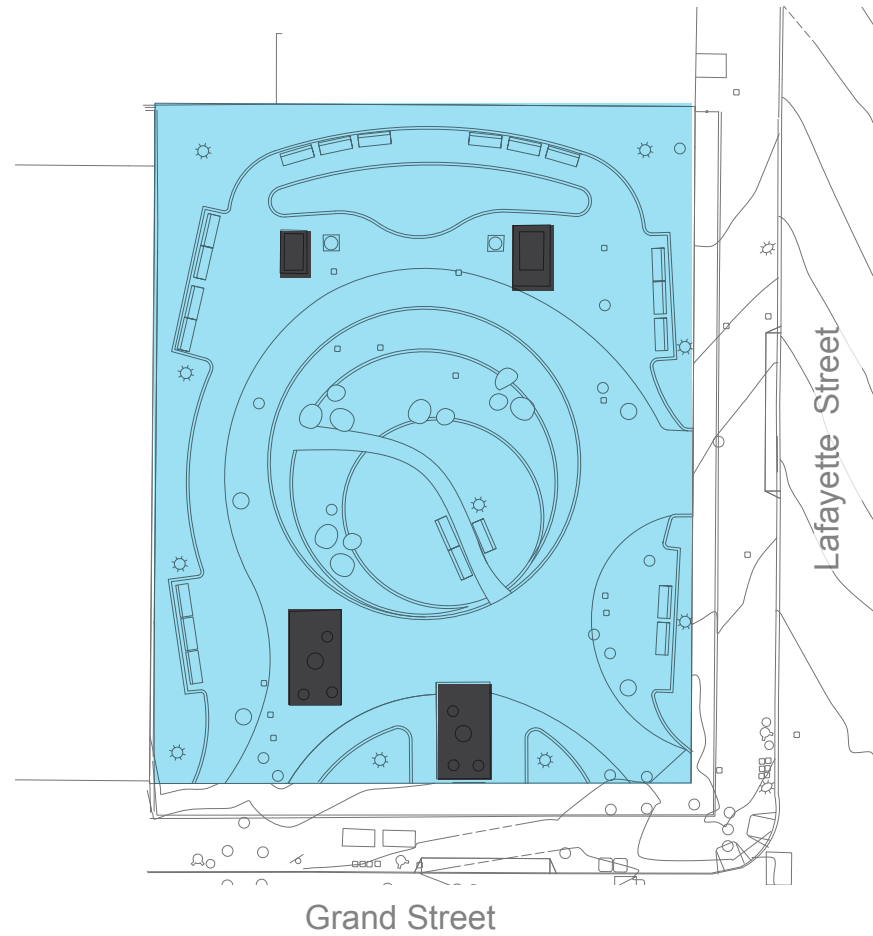

Proposed Permeability: **99%**



SUSTAINABLE PRACTICES

- Maximize permeable surfaces
- Reduce storm water runoff
- Use recycled content material
- Use regional materials
- Supply outdoor spaces for social interaction
- Provide healthy growing conditions
- Provide views of vegetation for mental restoration
- Utilize site appropriate resilient plant material
- Use non-invasive, native plant material



Thank You!

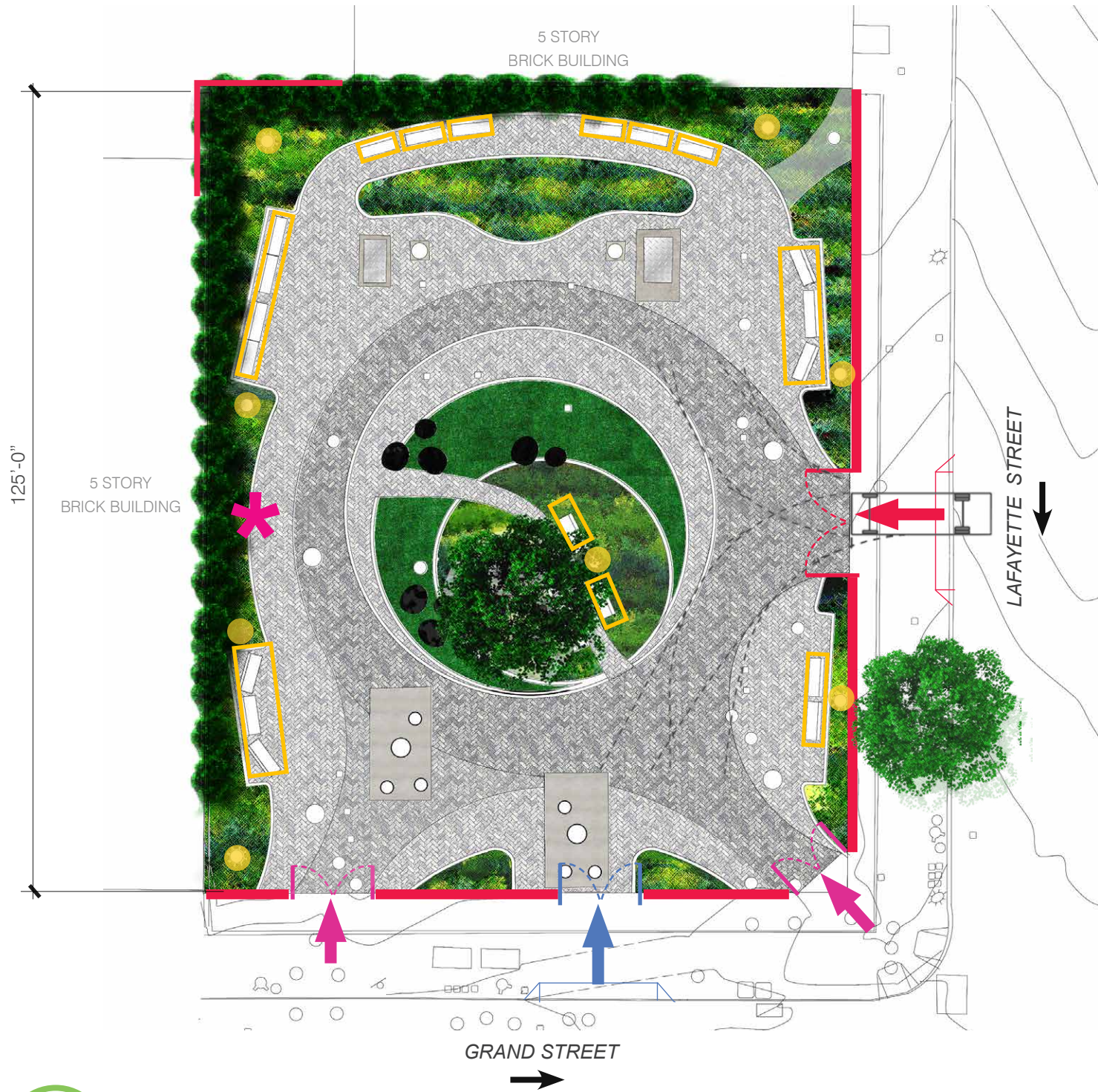

Proposed tree

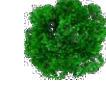

Proposed columnar tree



Fixed concrete encased infrastructure



Planted buffer



Synthetic turf with flush concrete curb
GFRC moveable 'pebble' seating*



Permeable paving (commercial vehicle tolerant)
with flush concrete curb



Existing manholes/valves in permeable paving



Existing covers in concrete pad



Security lighting

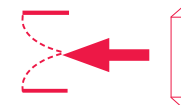

16'-0" wide double gate for maintenance truck
with existing drop-curb



10'-6" wide double gate pedestrian entrance

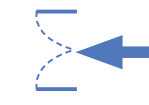

12'-0" wide double gate vehicular entrance
with existing curb



5'-0" ht. steel fence

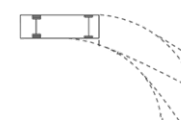

30 ft. Box truck turning radius



Backed benches



Drinking fountain

* final location to be coordinated with DEP



NYC Parks

Grand & Lafayette Streets | Schematic Plan