



THE CITY OF NEW YORK
 MANHATTAN COMMUNITY BOARD NO. 3
 59 East 4th Street - New York, NY 10003
 Phone: (212) 533-5300 - Fax: (212) 533-3659
 www.cb3manhattan.org - info@cb3manhattan.org

Dominic P. Berg, Board Chair

Susan Stetzer, District Manager

Community Board 3 Liquor License Application Questionnaire

Please bring the following items to the meeting:

NOTE: ALL ITEMS MUST BE SUBMITTED FOR APPLICATION TO BE CONSIDERED.

- Photographs of the inside and outside of the premise.
- Schematics, floor plans or architectural drawings of the inside of the premise.
- A proposed food and or drink menu.
- Petition in support of proposed business or change in business with signatures from residential tenants at location and in buildings adjacent to, across the street from and behind your proposed location. Petition must give proposed hours and method of operation. For example: restaurant, sports bar, combination restaurant/bar.
- Letter of notice of proposed business to block, tenant or neighborhood association if one exists. E-mail the CB3 office at **info@cb3manhattan.org** for help to find block associations.
- Photographs of proof of conspicuous posting of meeting with newspaper showing date.
- If applicant has been or is licensed anywhere in City, letter from applicable community board indicating history of complaints and other comments.

Check which you are applying for:

- new liquor license
- alteration of an existing liquor license
- corporate change
- upgrade of an existing liquor license
- sale of assets
- * Transfer of existing license.

If applying for sale of assets, you must bring letter from current owner confirming that you are buying business or have the seller come with you to the meeting.

Type of license: Tavern Wine License (beer & wine) Is location currently licensed? Yes No

If alteration, describe nature of alteration: N/A

Previous or current use of the location: Tavern

Corporation and trade name of current license: MHLC INC DBA MINI BAR

APPLICANT:

Name of applicant and all principals: Shervin's World Inc
Shervin Nassi as President

Trade name (DBA): _____

Premise address and cross streets: 131 East 7th Street. NY, NY 10009. Cross Streets :Avenue A and 1st Avenue

PREMISE:

Type of building and number of floors: ATTACHED 5 FLOOR MIXED USE BUILDING

Do you have or plan to install French doors accordion doors or windows?

Will you agree to close any doors and windows at 10:00 P.M. every night? Yes No

Will there be TVs/monitors? Yes No (If Yes, how many?) _____

Will premise have music? Yes No

If Yes, what type of music? Live musician DJ Juke box Tapes/CDs/iPod

If other type, please describe _____

What will be the music volume? Background (quiet) Entertainment level

Please describe your sound system: _____

Will you host promoted events, scheduled performances or any event at which a cover fee is charged? If Yes, what type of events or performances are proposed? _____

How do you plan to manage vehicular traffic and crowds on the sidewalk caused by your establishment? Please attach plans.

Will there be security personnel? Yes No (If Yes, how many and when) _____

How do you plan to manage noise inside and outside your business so neighbors will not be affected? Please attach plans.

Do you have or plan to install sound-proofing?

APPLICANT HISTORY:

Has this corporation or any principal been licensed previously? Yes No

If yes, please indicate name of establishment: _____

Address: _____ Community Board # _____

Dates of operation: _____

If you answered "Yes" to the above question, please provide a letter from the community board indicating history of complaints or other comments.

Has any principal had work experience similar to the proposed business? Yes No If Yes, please attach explanation of experience or resume.

Does any principal have other businesses in this area? Yes No If Yes, please give trade name and describe type of business _____

Has any principal had SLA reports or action within the past 3 years? Yes No If Yes, attach list of violations and dates of violations and outcomes, if any.

Attach a separate diagram that indicates the location (**name and address**) and total number of establishments selling/serving beer, wine (B/W) or liquor (OP) for 2 blocks in each direction. Please indicate whether establishments have On-Premise (OP) licenses. Please label streets and avenues and identify your location. Use letters to indicate **Bar, Restaurant**, etc. The diagram must be submitted with the questionnaire to the Community Board before the meeting.

Will any outside area or sidewalk cafe be used for the sale or consumption of alcoholic beverages?
(includes roof & yard) Yes No If Yes, describe and show on diagram: _____

Does premise have a valid Certificate of Occupancy and all appropriate permits, including certificate
of occupancy of back or side yard intended for commercial use? Yes No

Indoor Certificate of Occupancy _____ Outdoor Certificate of Occupancy _____

* see attached letter of no objection

Do you plan to apply for Public Assembly permit? Yes No

Zoning designation (check zoning using map: <http://gis.nyc.gov/doitt/nycitymap/>):

MIXED USE/RESTAURANT

Is this premise wheel chair accessible? Yes No

PROPOSED METHOD OF OPERATION:

What type of establishment will this be (i.e.: restaurant, bar, performance space, club, hotel)?

TAVERN

Will any other business besides food or alcohol service be conducted at premise? Yes No

If yes, please describe what type: _____

What are the proposed days/hours of operation? (Specify days and hours each day and hours of
outdoor space) 9AM-1AM, 7 DAYS

Number of tables? 3 Number of seats at tables? 22 Seats

How many stand-up bars/ bar seats are located on the premise? 1

(A **stand up bar** is any bar or counter (whether with seating or not) over which a patron can order,
pay for and receive an alcoholic beverage)

Describe all bars (length, shape and location): L shape bar, see attached diagram for sizes

Any food counters? Yes No If Yes, describe: _____

Does premise have a full kitchen Yes No?

Does it have a food preparation area? Yes No (If any, show on diagram)

Is food available for sale? Yes No If yes, describe type of food and submit a menu

PLEASE SEE ATTACHED MENU

What are the hours kitchen will be open? _____

Will a manager or principal always be on site? Yes No If yes, which? _____

How many employees will there be? _____

LOCATION:

How many licensed establishments are within 1 block? _____

How many licensed establishments are within 500 feet? _____

Is premise within a 500 foot radius of 3 or more establishments with OP licenses? Yes No

How many On-Premise (OP) liquor licenses are within 500 feet? _____

Is premise within 200 feet of any school or place of worship? Yes No

If there is a school or place of worship within 200 feet of your premise on the same block, submit a block plot diagram or area map showing its location in proximity to your premise and indicate the distance and name and address of the school or house of worship.

please see attached

COMMUNITY OUTREACH:

If there are block associations, neighborhood or tenant associations in the immediate vicinity of your location, you must contact them. **Please attach proof (copies of letters and poster) that you have advised these groups of your application with sufficient time for them to respond to your notice.** You may contact the Community Board at info@cb3manhattan.org for any contact information that is on file.

Petitions should clearly state the name, address, license for which you are applying, and the hours and method of operation of your establishment at the top of each page. (Attach additional sheets of paper as necessary).

APPLICANT: SHERVIN'S WORLD, INC
131 E 7TH STREET, NEW YORK NY 10009

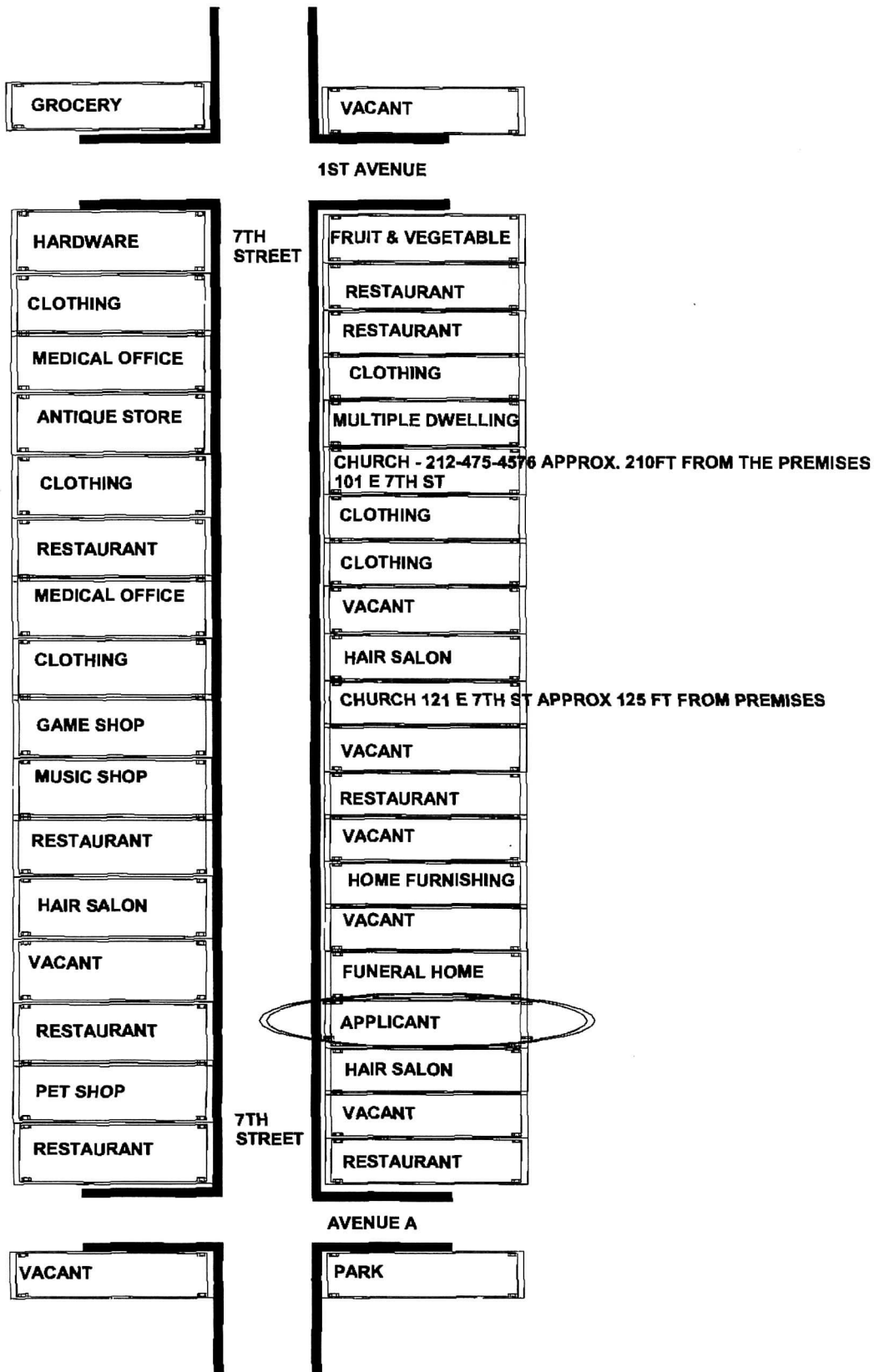

APPLICANT: SHERVIN'S WORLD INC
131 EAST 7TH STREET
NEW YORK, NY 10009

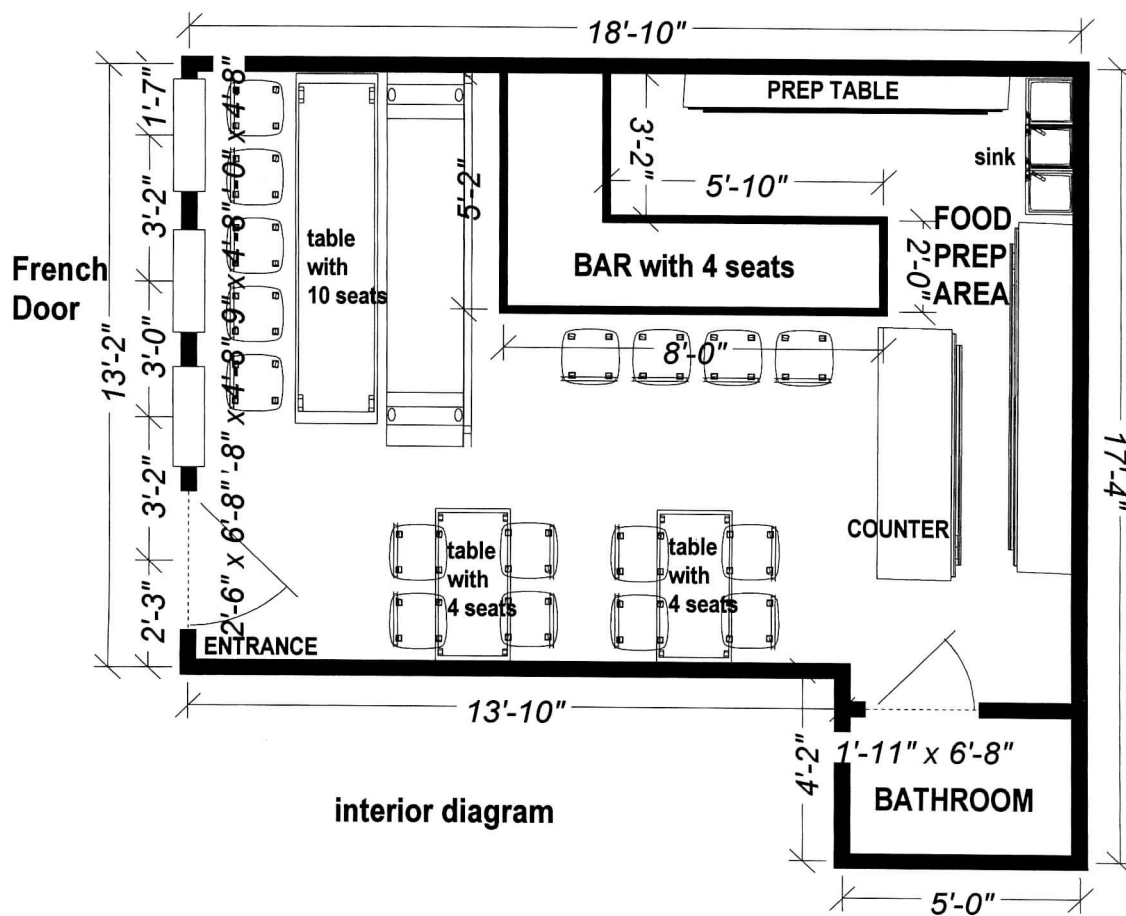

interior diagram

PRINTED MENU
131 E 71ST STREET, NY NY

****BREAKFAST ITEMS****

- *MUFFINS \$2.50
- *BAGELS \$2.00 WITH CREAM CHEESE \$2.50
- *ENGLISH MUFFIN \$2.00
- *EGG SANDWICH \$4.00
- *CROISSANTS \$2.50
- *YOGURT WITH FRESH FRUIT \$
- *YOGURT WITH GRANOLA \$
- *CEREAL HOT/COLD \$
- *OAT MEAL \$4.00
- *MINI WHEATS \$4.00

****SANDWICHES / PANINIS** \$8.95**

- *PROSCIUTTO, PROVALONE, BASIL, PESTO
- *MOZZERELLA, TOMATO, BASIL
- *VIRGINIA HAM, BRIE, HONEY MUSTARD
- *SMOKE TURKEY, CRANBERRIES
- *TUNA SALAD, TOMATO, CHEDDAR
- *BACON, LETTUCE, TOMATO, MAYO

****SOUPS & SALADS****

- *SOUP OF THE DAY (VARIES) \$6.00
- *MIXED GREEN \$6.00
- *CAESER WITH SHAVED PARMIGLIANO \$8.00
- *CAESER WITH CHICKEN \$11.00

****DESERT****

- *SOUR CREAM APPLE PIE / A LA MODE \$6.00 / + \$2.00
- *KEY LIME PIE \$6.00
- *CARROT CAKE \$6.00
- *HOT FUDGE SUNDAE \$6.00
- *BROWNIE SUNDAE \$7.50
- *PEANUT BUTTER / CHOCOLATE CHEESE CAKE \$7.50
- *MILK SHAKE EXTRA THICK, CHOCOLATE, VALLILA, STRAWBERRY \$4.00

****SMOOTHIES** \$7.00**

- *BANANAS
- *STRAWBERRY
- *BLUEBERRY
- *PEACH
- *PEANUT BUTTER
- *PROTIEN BOOSTERS / POWER
- _MUSCLE MILK VANNILA/CHOCOLATE
- _WHEY PROTEIN VANNILA/CHOCOLATE

****HOT BEVERAGES****

- *CAFFEE/TEA \$2.00 / \$2.50
- *AMERICANO \$2.50 / \$3.00
- *ESPRESSO \$2.50
- *CAPPUCCINO \$3.50 / \$4.50
- *LATTE \$3.50 / \$4.00
- *CAFÉ MOCHA \$3.75 / \$4.25
- *STEAMED MILK \$2.50 / \$3.00
- *ESPRESSO SHOT \$1.50

****COLD BEVERAGES****

- *ICED COFFEE OR TEA \$2.50 / \$3.00
- *ICED CAPPUCCINO \$4.00 / \$4.50
- *ICED LATTE \$4.00 / \$4.50
- *CHOCOLATE MILK \$2.50 / \$3.00
- *BOTTLED WATER \$2.00
- SPARKLING WATER \$2.25
- SOFT DRINKS (COKE, DIET COKE, SPRITE, GILGERALE) \$2.00

SHERVIN'S

CAFE

BEERS

Abita Strawberry
Blanche De Bruxelles
Stella Artois
East India Pale Ale
White UFO
Fuller's London Pride
Firestone Union Jack
Southampton India Pale Ale

7
7
8
7
7

REDS

Bagiola Toscana (Italy) 9/29
Broquel Malbec (Argentina) 11/38
Callaway Cabernet Sauvignon (California) 9/31
Callia Shiraz (San Juan) 10/35
Hahn Pinot Noir (California) 10/35
HI Garnacha (Spain) 8/28
Jacobs Creek Shiraz Cabernet (Australia) 10/36
Rabbit Ridge Merlot (California) 11/37

WINES

WHITES:

Errazuriz Estate Chardonnay (Chile) 9/32
Ponzi Pinot Gris (Oregon) 11/35
Triennes Sainte Fleur Viognier (France) 12/4
Veramonte Sauvignon Blanc (Chile) 9/32

Rose:
MUGA (SPAIN) 11/36

PROSECCO:
IL TORCHIO (Italy) 12/42

FOOD

Guacamole+Chips	10
Spinach Artichoke Dip	10
Cheese Quesadilla	10



04 02 2012



04.02.2012



04.02.2012

131

ATTENTION RESIDENTS & NEIGHBORS
PLEASE TO OPEN &
BY THE FOLLOWING CONDITIONS
YOUR CONTRACT, IN ORDER TO OBTAIN THE
MONEY TO BUY THE UNIT AT 10:00 AM
ON MONDAY, MAY 10, 2010 AT 10:00 AM
PLEASE RESIDE AT THE EAST 5TH STREET





NYC Department of Buildings
280 Broadway, New York, NY 10007

Robert Limandri, Acting Commissioner

Dileep Khedekar, P.E.
Deputy Borough Commissioner
Manhattan Borough Office, 3rd Fl.
Phone: (212) 566-0019
Fax: (212) 566-5575
E-mail: dileepk@buildings.nyc.gov

June 5, 2008

New York State Liquor Authority
Division of Alcoholic Beverages Control
105 West 125th Street – 5th Floor
New York, NY 10027

RE: LETTER OF NO OBJECTION
131 EAST 7TH STREET
Block #: 435; Lot #: 37
Manhattan

To Whom It May Concern:

The Department has No Objection to an Eating and Drinking Establishment, Use Group 6, Non- Place of Assembly, for less than Seventy-Five (75) persons on the First Floor of the above referenced premises.

However, any new construction must be filed with this department.

This is based upon department records; Block # 435 Lot # 37, Copies of HPD "I" Cards & Sanborn Map.

Sincerely,

Dileep Khedekar, P.E.
Deputy Borough Commissioner
Manhattan

Dk/ks

Cc: Christopher M. Santulli, P.E., Borough Commissioner, Manhattan
Ginio Topino, Plan Examiner
LNO File
Premises File