

THE CITY OF NEW YORK
 MANHATTAN COMMUNITY BOARD 3
 59 East 4th Street - New York, NY 10003
 Phone: (212) 533-5300 - Fax: (212) 533-3659
 www.cb3manhattan.org - info@cb3manhattan.org

Gigi Li, Board Chair

Susan Stetzer, District Manager

Community Board 3 Liquor License Application Questionnaire

Please bring the following items to the meeting:

NOTE: ALL ITEMS MUST BE SUBMITTED FOR APPLICATION TO BE CONSIDERED.

- Photographs of the inside and outside of the premise.
- Schematics, floor plans or architectural drawings of the inside of the premise.
- A proposed food and or drink menu.
- Petition in support of proposed business or change in business with signatures from residential tenants at location and in buildings adjacent to, across the street from and behind your proposed location. Petition must give proposed hours and method of operation. For example: restaurant, sports bar, combination restaurant/bar. (petition provided)
- Letter of notice of proposed business to block or tenant association if one exists. E-mail the CB3 office at **info@cb3manhattan.org** for help to find block associations.
- Photographs of proof of conspicuous posting of meeting with newspaper showing date.
- If applicant has been or is licensed anywhere in City, letter from applicable community board indicating history of complaints and other comments.

Check which you are applying for:

- new liquor license alteration of an existing liquor license corporate change

Check if either of these apply:

- sale of assets upgrade (change of class) of an existing liquor license

Today's Date: Sunday, March 10th, 2013

If applying for sale of assets, you must bring letter from current owner confirming that you are buying business or have the seller come with you to the meeting.

Type of license: Full Liquor Licence (OP) Is location currently licensed? Yes No

If alteration, describe nature of alteration: Upgrade to Full Liquor License (OP)

Previous or current use of the location: Restaurant

Corporation and trade name of current license: Jersey Boys LLC, dba Pizzeria de Santo

APPLICANT:

Premise address: 173 Ludlow Street, New York, NY, 10002

Cross streets: Ludlow Street between E. Houston and Stanton Streets

Name of applicant and all principals: Jersey Boys LLC: Luigi Piscopo, Howard Buck, Guido Venitucci

Trade name (DBA): Tre

PREMISE:

Type of building and number of floors: Mixed Residential and Commercial, 5 Floors

Will any outside area or sidewalk cafe be used for the sale or consumption of alcoholic beverages? (includes roof & yard) Yes No If Yes, describe and show on diagram: Backyard patio for up to 18 guests to dine 5PM to 10PM. No music is played in backyard patio.

Does premise have a valid Certificate of Occupancy and all appropriate permits, including certificate of occupancy for back or side yard intended for commercial use? Yes No
Indoor Certificate of Occupancy 100 Outdoor Certificate of Occupancy 50
(fill in maximum NUMBER of people permitted)

Do you plan to apply for Public Assembly permit? Yes No
Zoning designation (check zoning using map: <http://gis.nyc.gov/doitt/nycitymap/> - please give specific zoning designation, such as R8 or C2):
C4 - 4A

Is this premise wheel chair accessible? Yes No

PROPOSED METHOD OF OPERATION:

What type of establishment will this be (i.e.: restaurant, bar, performance space, club, hotel)?
Restaurant

Will any other business besides food or alcohol service be conducted at premise? Yes No
If yes, please describe what type: _____

What are the proposed days/hours of operation? (Specify days and hours each day and hours of outdoor space) INDOOR (ALL YEAR) Monday - Friday 5PM to 11PM, Saturday & Sunday 12PM - 11PM
OUTDOOR (SEASONAL) Monday - Friday 5PM to 10PM, Saturday & Sunday 12PM - 10PM

Number of tables? 20 Number of seats at tables? 2 - 4

How many stand-up bars/ bar seats are located on the premise? 6
(A **stand up bar** is any bar or counter (whether with seating or not) over which a patron can order, pay for and receive an alcoholic beverage)

Describe all bars (length, shape and location): 1 Bar: 7 Feet Long, Rectangular, Center

Any food counters? Yes No If Yes, describe: _____

Does premise have a full kitchen Yes No?

Does it have a food preparation area? Yes No (If any, show on diagram)

Is food available for sale? Yes No If yes, describe type of food and submit a menu

Traditional Neopolitan Cuisine including Street Foods, Salads, Pastas, and Entrees

What are the hours kitchen will be open? Monday - Friday 5PM to 11PM, Saturday & Sunday 12PM - 11PM

Will a manager or principal always be on site? Yes No If yes, which? Manager & Principal

How many employees will there be? 5

Do you have or plan to install French doors accordion doors or windows?

Will you agree to close any doors and windows at 10:00 P.M. every night? Yes No

Will there be TVs/monitors? Yes No (If Yes, how many?) 1

Will premise have music? Yes No

If Yes, what type of music? Live musician DJ Juke box Tapes/CDs/iPod

If other type, please describe Ambient (INDOOR ONLY)

What will be the music volume? Background (quiet) Entertainment level

Please describe your sound system: 5 Speakers, Directional

Will you host promoted events, scheduled performances or any event at which a cover fee is

charged? If Yes, what type of events or performances are proposed? No

How do you plan to manage vehicular traffic and crowds on the sidewalk caused by your establishment? Please attach plans.

Will there be security personnel? Yes No (If Yes, how many and when) _____

How do you plan to manage noise inside and outside your business so neighbors will not be affected? Please attach plans.

Do you have or plan to install sound-proofing?

APPLICANT HISTORY:

Has this corporation or any principal been licensed previously? Yes No

If yes, please indicate name of establishment: _____

Address: _____ Community Board # _____

Dates of operation: _____

If you answered "Yes" to the above question, please provide a letter from the community board indicating history of complaints or other comments.

Has any principal had work experience similar to the proposed business? Yes No If Yes, please attach explanation of experience or resume.

Does any principal have other businesses in this area? Yes No If Yes, please give trade name and describe type of business _____

Has any principal had SLA reports or action within the past 3 years? Yes No If Yes, attach list of violations and dates of violations and outcomes, if any.

Attach a separate diagram that indicates the location (**name and address**) and total number of establishments selling/serving beer, wine (B/W) or liquor (OP) for 2 blocks in each direction. Please indicate whether establishments have On-Premise (OP) licenses. Please label streets and avenues and identify your location. Use letters to indicate **Bar, Restaurant**, etc. The diagram must be submitted with the questionnaire to the Community Board before the meeting.

LOCATION:

How many licensed establishments are within 1 block? _____ 4

How many licensed establishments are within 500 feet? _____ 3

Is premise within a 500 foot radius of 3 or more establishments with OP licenses? Yes No

How many On-Premise (OP) liquor licenses are within 500 feet? _____ 2

Is premise within 200 feet of any school or place of worship? Yes No

If there is a school or place of worship within 200 feet of your premise on the same block, submit a block plot diagram or area map showing its location in proximity to your premise and indicate the distance and name and address of the school or house of worship.

COMMUNITY OUTREACH:

If there are block associations or tenant associations in the immediate vicinity of your location, you must contact them. **Please attach proof (copies of letters and poster) that you have advised these groups of your application with sufficient time for them to respond to your notice.** You may contact the Community Board at info@cb3manhattan.org for any contact information.

Please use provided petitions, which clearly state the name, address, license for which you are applying, and the hours and method of operation of your establishment at the top of each page. (Attach additional sheets of paper as necessary).

ATTENTION RESIDENTS & NEIGHBORS

Jersey Boys LLC/Tre 212.353.3353

Company/DBA Name and Contact Number for Questions

Plans to open a

Restaurant

(Please choose)

Bar/Restaurant/Club/Grocery/Liquor Store/Wholesaler,
Please indicate if there will be a Sidewalk Café or Backyard Garden

at the following location

173 Ludlow Street, NY, NY 10002

Street Number and Street Name

This establishment is seeking a license to serve

Beer/Wine & Liquor

Beer & Wine or Beer/Wine & Liquor

There will be an opportunity for public comment on

[date and time field]

[location and address field]

(P): 212.353.3353 (E): INFO@TRENEWYORK.COM

Applicant Contact Information

At COMMUNITY BOARD 3

SLA & DCA Licensing Committee Meeting

info@cb3manhattan.org - www.cb3manhattan.org

173 LUDLOW STREET
AFTER ALTERATION

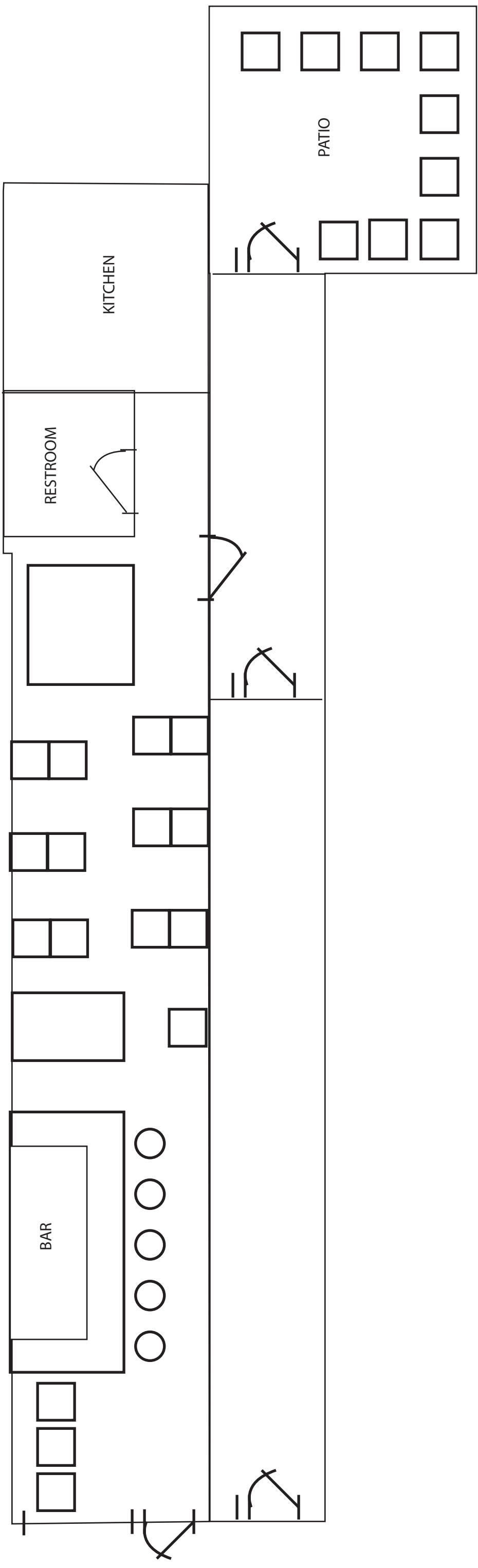

FRONT



173 Ludlow Street
New York, NY 10002
212.353.3353
www.trenewyork.com

- **VEHICULAR & CROWD TRAFIC:** In addition to a visible sign, management and restaurant hosts personally manage any guests that linger in front of the restaurant by asking to respect our neighbors and minimize noise. Tre restaurant will not impact vehicular traffic on Ludlow Street.
- **NOISE MANAGEMENT:** Tre only plays ambient music inside the restaurants and closes seasonal windows by 10PM.
- **SECURITY STRATEGY:** Tre restaurant will not serve any person visibly intoxicated and will train all staff to identify intoxicated patrons.