



THE CITY OF NEW YORK  
MANHATTAN COMMUNITY BOARD 3

59 East 4th Street - New York, NY 10003  
Phone: (212) 533-5300 - Fax: (212) 533-3659  
www.cb3manhattan.org - info@cb3manhattan.org

Gigi Li, Board Chair

Susan Stetzer, District Manager

**Sidewalk Café License Application Questionnaire**

**Fill out completely or application will not be considered.**

Bring 6 copies (double sided) of this questionnaire to the SLA & DCA Licensing Committee meeting to be considered. Otherwise the Committee will write to the DCA notifying the agency of your failure to cooperate with the community review process. This application must also be completed and returned to the Community Board office as soon as possible.

For maximum public notification of your application, display the enclosed poster a in a visible location on the outside of your establishment and adjacent buildings for 7 DAYS prior to the meeting

Check which you are applying for:

- a new sidewalk café license for an  enclosed  unenclosed café.
- an alteration of an existing sidewalk license
- a renewal of an existing sidewalk license

When you return this form, you must include the following attachments:

- Photographs of the inside and outside of your establishment
- Schematics/floor plans of the inside of your establishment and sidewalk café schematics
- Petition signatures from residents in surrounding buildings

Name of Corporation: PLAN A GROUP DBA: FORGTMENOT

Address: 138 DIVISION ST Cross Streets: LUDLOW / FORCHARD

Applicant's Name on DCA Documents: MARIOS TSIPTISIS / ABBY SIERRAS

Applicant's Address: 138 DIVISION ST.

Telephone: 917 4287335 / 6467073195 E-Mail: 138DIVISION@gmail.com

Describe nature of alteration, if applicable: \_\_\_\_\_

Is this establishment handicap accessible?  Yes  No If "Yes" please attach photo.

Hours of Operation (indicate if different for sidewalk or back yard): 12-1AM

Seating Capacity Inside	Tables: <u>5</u>	Chairs: <u>12</u>	Bar Stools: <u>7-8</u>
Seating Capacity Sidewalk	Tables: <u>4</u>	Chairs: <u>16</u>	Bar Stools: _____
Seating Capacity Backyard	Tables: <u>0</u>	Chairs: <u>0</u>	Bar Stools: <u>0</u>
TOTALS	<u>9</u>	<u>28</u>	<u>8</u>

Has this corporation or any principal been licensed previously?  Yes  No

If yes, please indicate name of establishment: \_\_\_\_\_

Address: \_\_\_\_\_ Community Board #: \_\_\_\_\_

Cross Street: \_\_\_\_\_ Dates: \_\_\_\_\_

How many sidewalk cafés are within 1 block? NONE Please use the schematic below to indicate the location and total number of sidewalk cafés within this one block area. (LES ENFANTS WAS BUT NOW CLOSED)

	A V E				
	STREET				

If there are block associations or merchant associations or tenant associations in the immediate vicinity of your location, you must contact them. **Please attach proof (copy of letter or poster) that you have advised these groups of your application. Petitions should clearly state the name, address, license for which you are applying, the hours and method of operation of your establishment at the top of each page.**

Attach additional sheets of paper for any additional information.

**PLEASE NOTE:**

Community Board 3 requests that Sidewalk Cafés cease operation no later than midnight on weekends and 11 p.m. on weekdays. We urge you to consider closing at 11 p.m. and 10 p.m. respectively. Unenclosed sidewalk cafés (railings, chairs, and tables) must be removable and put away at the end of each night. Until you receive your license from the city, you are not licensed to operate your sidewalk café and may be fined for doing so.

For full regulations governing sidewalk cafés, please consult the City Code, Article 1, Chapter 4, Sections 14-11 through 14-43. (Available from the Department of Consumer Affairs.)

PETITION FOR UNENCLOSED CAFE LISENCE ON  
138 DIVISION ST. / PLAN A GROUP / FORGIME

<u>NAME</u>	<u>ADDRESS</u>	<u>SIGNATURE</u>
<u>Vijay K. Sigdel</u>	<u>136 Division St. #8</u>	<u>Vijay K. Sigdel</u>
<u>Robin Page</u>	<u>15 Orchard St #4</u>	<u>[Signature]</u>
<u>Charlotte Malmof</u>	<u>15 Orchard St. #4</u>	<u>C. Malmof</u>
<u>Steffan Lavine</u>	<u>134 Division Street</u>	<u>[Signature]</u>
<u>Kiki Karamintzas</u>	<u>23 Rutgers St</u>	<u>[Signature]</u>
<u>Ollie Hammett</u>	<u>30 CANAL ST #2A</u>	<u>[Signature]</u>
<u>Hennelle Hammett</u>	<u>30 CANAL ST #2A</u>	<u>[Signature]</u>
<u>Henry Hammett</u>	<u>30 CANAL ST #2A</u>	<u>[Signature]</u>
<u>Sane Heikkonen</u>	<u>155 HENRY ST #103</u>	<u>[Signature]</u>
<u>Abentya Shramko</u>	<u>1123 Brightons</u>	<u>[Signature]</u>
<u>Christopher Mitchell</u>	<u>105 Henry St Apt #103</u>	<u>[Signature]</u>
<u>Chang Hu</u>	<u>134 Division ST</u>	<u>[Signature]</u>
<u>ERIC WRENW</u>	<u>168 HALL ST.</u>	<u>[Signature]</u>
<u>Dale Garrahan Jackson</u>	<u>675 Water St.</u>	<u>D Jackson</u>
<u>Eve Rosa</u>	<u>180 South St. 101</u>	<u>[Signature]</u>
<u>Lindsey Hafnagel</u>	<u>213 E. Broadway #2R</u>	<u>[Signature]</u>
<u>Peni Hafnagel</u>	<u>213 E Broadway</u>	<u>[Signature]</u>
<u>Cole Hafnagel</u>	<u>213 E Broadway</u>	<u>Cole Hafnagel</u>

NAME ADDRESS SIGNATURE

Andy Boock 347 Grand St

Sampurna Koondial 185 Ave C

J. Vollmer 136 Div

CASS JONES 219 MADISON

MATTHEW COLON 219 MADISON

Eric Schwasser 347 W 57th 35B

Katherine Carey 347 W 57th 35B

Brandon Rozblatt 12 Cudlow St.

Alexandra DePersia 21 Cudlow St

David Schneider 43 Kitchin Rd

Elizabeth Buncher 236 Riverwood Dr. New Hope, PA 18938

Tyrone Williams 134 Division St

Sue Zdan 213 E. Broadway

Saffay Jon 22 Essex

JASON ASTON 41 Orchard St. 3A

Michael Little 43 ORCHARD ST

Mae Warren 47 Monroe Street #3

Daniel James 47 Monroe St #3









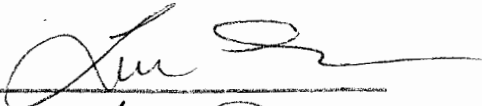

Justin Molina 47 Monroe #3

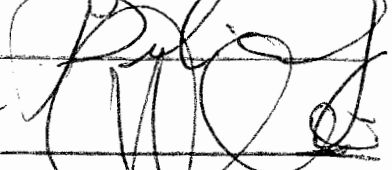
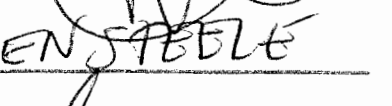
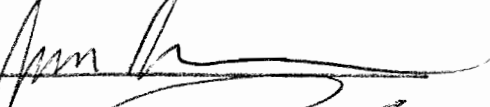
Ethan Davison 91 Allen St

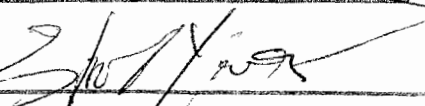
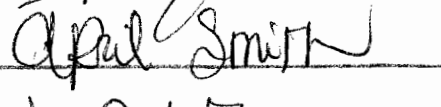
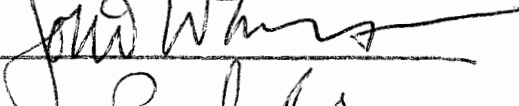
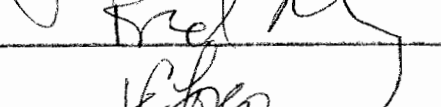
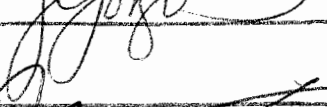
Melanie Gagecc 11 Eldridge St. #4B

Melanie Gagecc

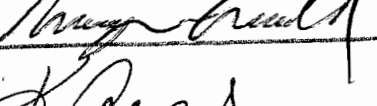
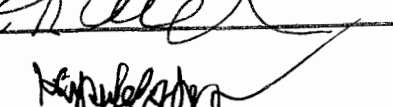
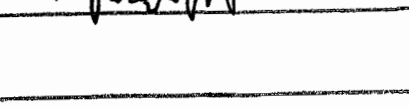
NAME	ADDRESS	SIGNATURE
Arlena Basilio	1 West Street	Jena Basilio
J.D. MONGEAU	15 PIKE ST.	J.D. Mongeau
Jessica Mongeau	15 PIKE ST.	Jessica Mongeau
K.A. Aamonsen	15 PIKE ST. APT 3C	K.A.
FREDRICK AAMSEN	15 PIKE ST. APT 3C	Fredrick
WALTER ADAMS	169 East Bway	Walter Adams
Iyabo Boyd	350 West 85th St	Iyabo Boyd
Robert Goldkind	22 Ave C	Robert
Ella Goldkind	22 Ave C	Ella
<del>ANN AMATO</del>	<del>173rd St</del>	<del>Ann Amato</del>
Alex Redmond	23 Orchard	Alex Redmond
Cecilia Bye	25 Orchard	Cecilia Bye
Pili Weeber	25 Orchard	Pili Weeber
Julia Zinshtein	201 Allen Street	Julia Zinshtein
Olga Kavardakova	81 Eldridge	Olga Kavardakova
MARLENE ALLEN	101 ALLEN	Marlene Allen
TILER VIGIL	110 LUDLOW HZ	Tiler Vigil
YASSIE J. RAULI	124 NILE ST NYC	Yassie J. Rauli
DANIEL KIM	54 ALLEN ST	Daniel Kim
Taj Alwan	73 Spring St	Taj Alwan
Scott D. GARRY	123 ALLEN ST	Scott D. Garry

<u>NAME</u>	<u>ADDRESS</u>	<u>SIGNATURE</u>
Louis Standby	75 Canal St	
LIEF HANSEN	153 Canal St	
Puli Weeber	25 Orchard St	
Yvon Gonzalez	376 CHARLES ST	
Or Steele	24 Ludlow	JEN STEELE
Jacob Brown	27 Ludlow	
Florian Roth	69 Bruce	
SEAN CURSRY	132 Division	
SHAWN YAGECIC	11 ELDRIDGE	
April Smith	11 Eldridge	April Smith
Jodie Warbet	457 FDR Dr.	
Frederick Perlberg	10 Rutgers St.	
Joey Longo	21 Ludlow	
Jaime Waxman	29 Ludlow	
Anthony Ore	139 Eldridge	
HAYDN DAVIES	139 ELDRIDGE	
MARWEX MAYN	49 WOOD ST 10A	
Nancy Cook	49 Ludlow St 10A	
Kate Archer	92 Orchard St	
Harrison Palevsky	54 Orchard St	

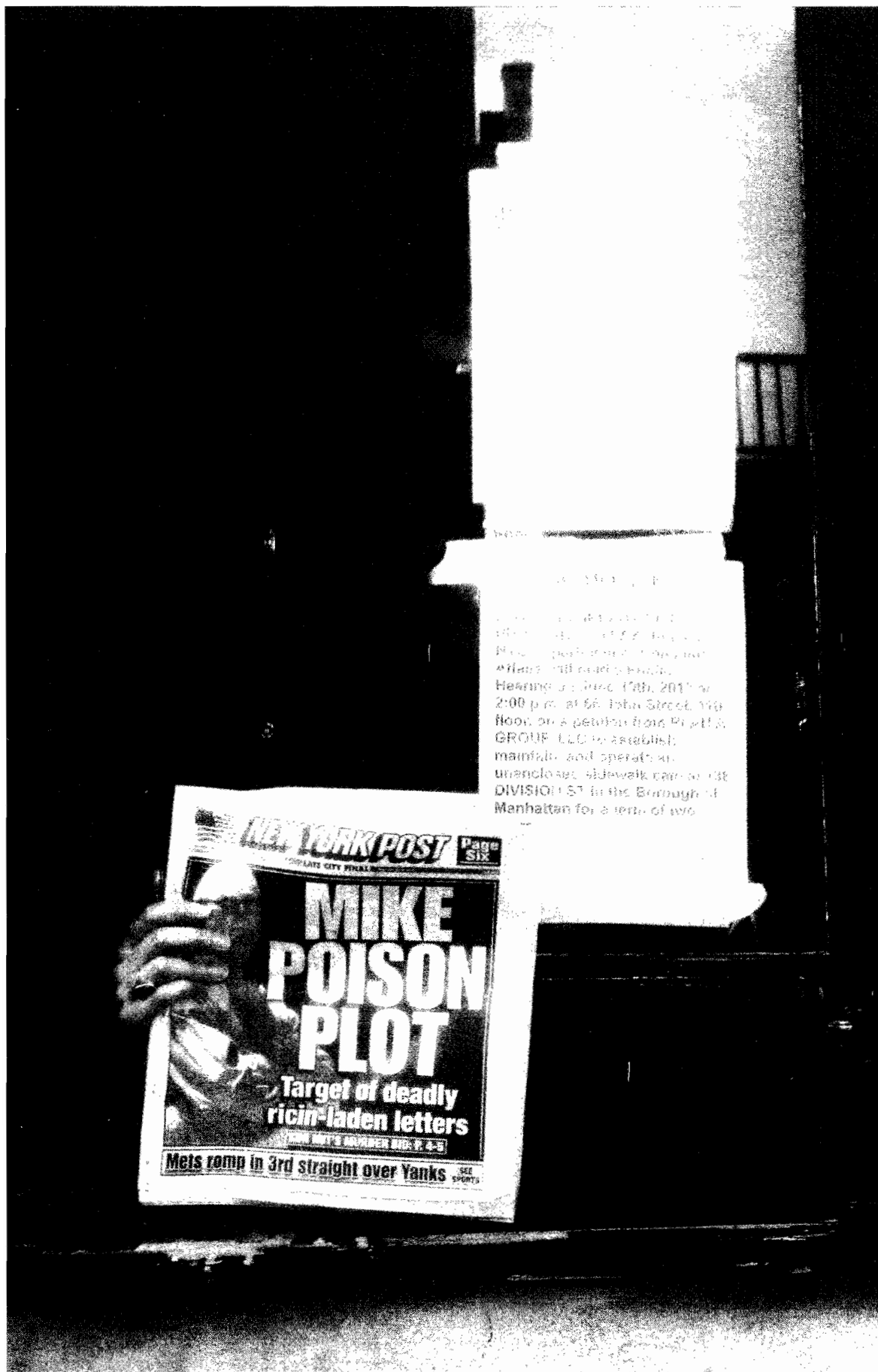









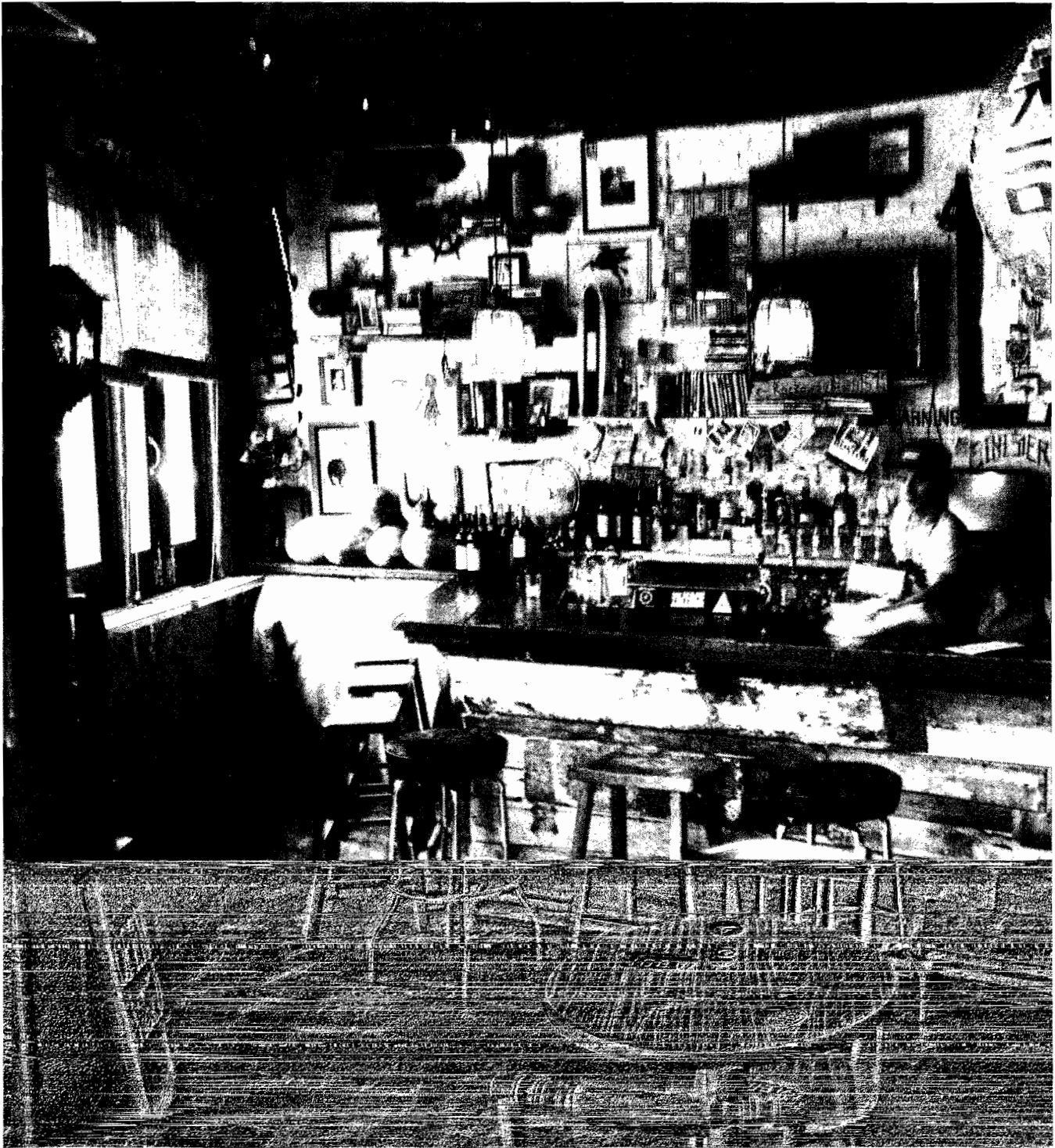

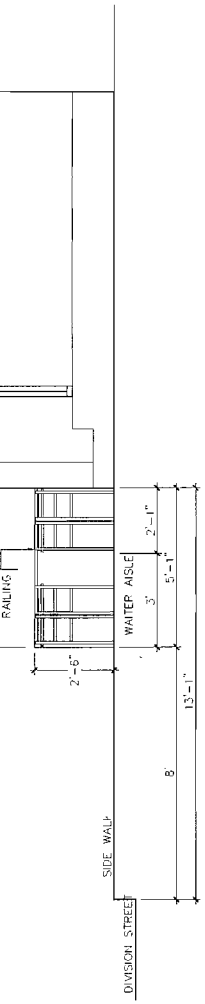

**SECTION**  
SCALE: 3/8" = 1'-0"

**PLOT PLAN**  
NOT TO SCALE

WORK AREA : OPEN SPACE  
BUILDING : EXIST'G 6 STORIES COM. & RES. BLDG  
BLOCK : 294 LOT : 28  
ZONE : C6-2G MAP : 12D

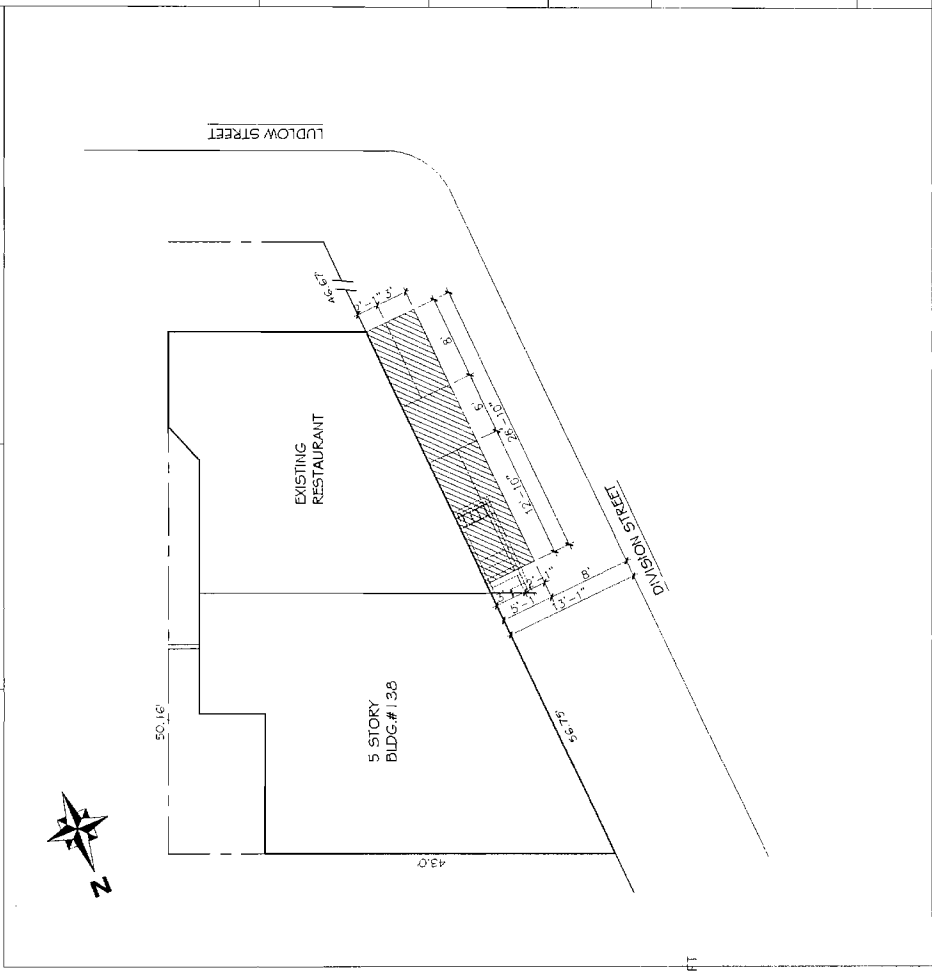

- TABLE DIMENSION : 24" X 18"  
- EMENT - NUMBER OF TABLE : 4  
- CT - NUMBER OF CHAIRS : 16  
- TOTAL SIDEWALK CAFE SQUARE FOOTAGE : 134 SQ FT  
- 30" HIGH RAILINGS SURROUNDING ALL CAFE BEATING BOARD, NO TREE GUARDS  
- SIDE WALK CAFE  
- 2'-6" HIGH  
- ALL  
- 10T

REVISIONS NUMBER	DATE	BIS JOB NUMBER



**DRAFT MASTER ENGINEERING P.C.**  
35-28 41st STREET  
LONG ISLAND CITY NY 11101  
TEL: 718-433-2550  
FAX: 718-706-6119

PROJECT :  
**UNENCLOSED SIDE WALK CAFE**  
138 DIVISION STREET  
MANHATTAN 10002  
REFURNISH EXISTING STORE & INSTALL NEW PLUMBING & FIRE SUPPRESSION SYSTEM AND EX-HAUST SYSTEM FOR NEW RESTAURANT.

WORK FLOOR :  
**OPEN SPACE**

DRAWING TITLE :

PLAN, ELEVATION, SECTION & PLOT PLAN	
Anthony Gorbali PE 111 Stuyvesant Avenue # 674142	DATE : 04/09/2012
	PROJECT NO. : /2012
	DRAWING BY : JJO
	CHECK BY : ANTHONY GORBALI
	DRAWING NO. : A-001.00
	1 OF 1

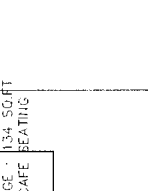

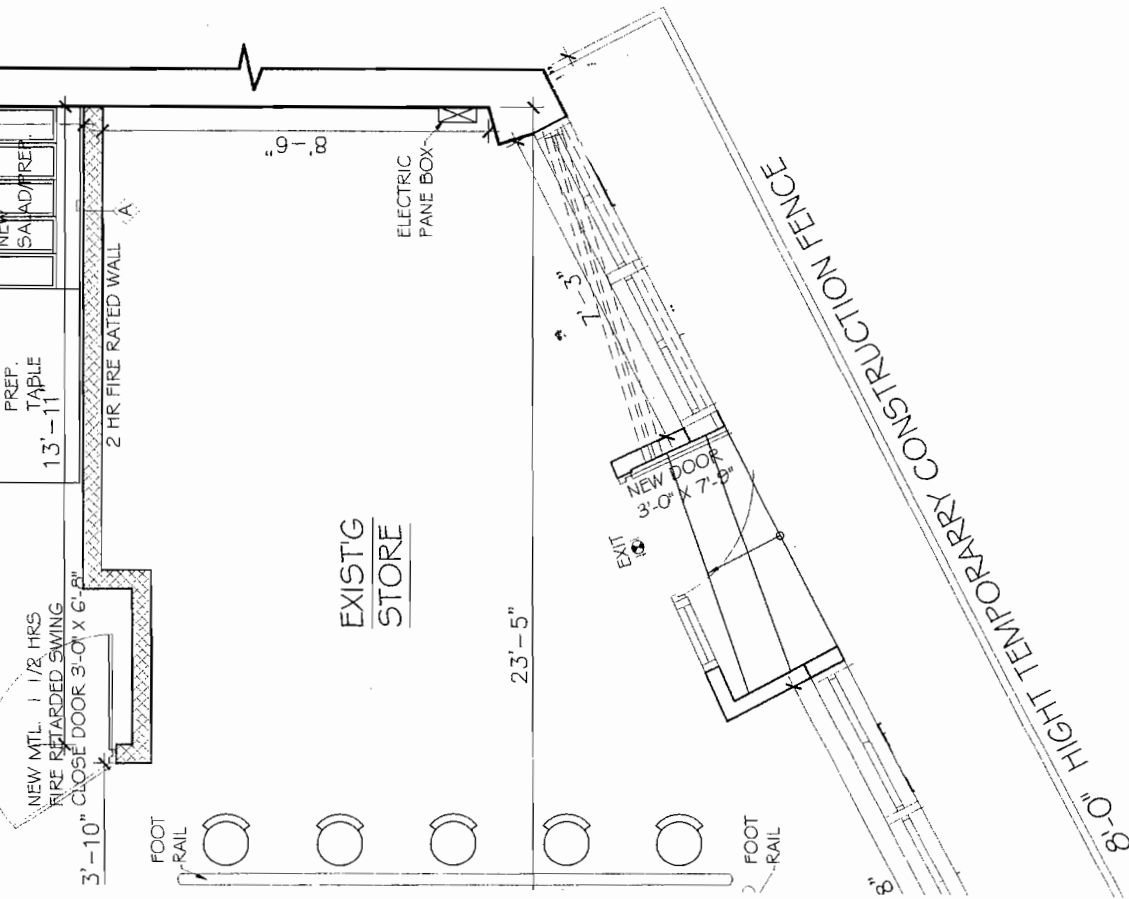

**PARTIAL FIRST FLOOR PLAN**

SCALE: 1/4" = 1'-0"