



THE CITY OF NEW YORK
 MANHATTAN COMMUNITY BOARD 3
 59 East 4th Street - New York, NY 10003
 Phone: (212) 533-5300 - Fax: (212) 533-3659
 www.cb3manhattan.org - info@cb3manhattan.org

Gigi Li, Board Chair

Susan Stetzer, District Manager

Community Board 3 Liquor License Application Questionnaire

Please bring the following items to the meeting:

NOTE: ALL ITEMS MUST BE SUBMITTED FOR APPLICATION TO BE CONSIDERED.

- Photographs of the inside and outside of the premise.
- Schematics, floor plans or architectural drawings of the inside of the premise.
- A proposed food and or drink menu.
- Petition in support of proposed business or change in business with signatures from residential tenants at location and in buildings adjacent to, across the street from and behind proposed location. Petition must give proposed hours and method of operation. For example: restaurant, sports bar, combination restaurant/bar. (petition provided)
- Notice of proposed business to block or tenant association if one exists. You can find community groups and contact information on the CB 3 website:
http://www.nyc.gov/html/mancb3/html/communitygroups/community_group_listings.shtml
- Photographs of proof of conspicuous posting of meeting with newspaper showing date.
- If applicant has been or is licensed anywhere in City, letter from applicable community board indicating history of complaints and other comments.

Check which you are applying for:

- new liquor license alteration of an existing liquor license corporate change

Check if either of these apply:

- sale of assets upgrade (change of class) of an existing liquor license

Today's Date: 5.4.2014

If applying for sale of assets, you must bring letter from current owner confirming that you are buying business or have the seller come with you to the meeting.

Is location currently licensed? Yes No Type of license: _____

If alteration, describe nature of alteration: _____

Previous or current use of the location: _____

Corporation and trade name of current license: _____

APPLICANT:

Premise address: CHO-KO RESTAURANT INC.

Cross streets: 3RD & 4TH ST

Name of applicant and all principals: WEN YING JIN

Trade name (DBA): _____

PREMISE:

Type of building and number of floors: Mixed Use 4 STORY

Will any outside area or sidewalk cafe be used for the sale or consumption of alcoholic beverages? (includes roof & yard) Yes No If Yes, describe and show on diagram: _____

Does premise have a valid Certificate of Occupancy and all appropriate permits, including for any back or side yard use? Yes No What is maximum NUMBER of people permitted? _____

Do you plan to apply for Public Assembly permit? Yes No

What is the zoning designation (check zoning using map: <http://gis.nyc.gov/doitt/nycitymap/> - please give specific zoning designation, such as R8 or C2): _____

PROPOSED METHOD OF OPERATION:

Will any other business besides food or alcohol service be conducted at premise? Yes No

If yes, please describe what type: _____

What are the proposed days/hours of operation? (Specify days and hours each day and hours of outdoor space) MONDAY - SUNDAY 12pm - 11pm

Number of tables? 4 Number of seats at tables? 4

How many stand-up bars/ bar seats are located on the premise? 0
(A **stand up bar** is any bar or counter (whether with seating or not) over which a patron can order, pay for and receive an alcoholic beverage)

Describe all bars (length, shape and location): _____

Does premise have a full kitchen Yes No?

Does it have a food preparation area? Yes No (If any, show on diagram)

Is food available for sale? Yes No If yes, describe type of food and submit a menu

JAPANESE NOODLE

What are the hours kitchen will be open? 12pm - 11pm

Will a manager or principal always be on site? Yes No If yes, which? _____

How many employees will there be? 2 - 4

Do you have or plan to install French doors accordion doors or windows?

Will there be TVs/monitors? Yes No (If Yes, how many?) _____

Will premise have music? Yes No

If Yes, what type of music? Live musician DJ Juke box Tapes/CDs/iPod

If other type, please describe _____

What will be the music volume? Background (quiet) Entertainment level

Please describe your sound system: RECORDED MUSIC

Will you host any promoted events, scheduled performances or any event at which a cover fee is charged? If Yes, what type of events or performances are proposed and how often? _____

How do you plan to manage vehicular traffic and crowds on the sidewalk caused by your establishment? Please attach plans. (Please do not answer "we do not anticipate congestion.")

Will there be security personnel? Yes No (If Yes, how many and when) _____

How do you plan to manage noise inside and outside your business so neighbors will not be affected? Please attach plans.

Do you have or plan to install sound-proofing?

APPLICANT HISTORY:

Has this corporation or any principal been licensed previously? Yes No

If yes, please indicate name of establishment: _____

Address: _____ Community Board # _____

Dates of operation: _____

If you answered "Yes" to the above question, please provide a letter from the community board indicating history of complaints or other comments.

Has any principal had work experience similar to the proposed business? Yes No If Yes, please attach explanation of experience or resume.

Does any principal have other businesses in this area? Yes No If Yes, please give trade name and describe type of business _____

Has any principal had SLA reports or action within the past 3 years? Yes No If Yes, attach list of violations and dates of violations and outcomes, if any.

Attach a separate diagram that indicates the location (**name and address**) and total number of establishments selling/serving beer, wine (B/W) or liquor (OP) for 2 blocks in each direction. Please indicate whether establishments have On-Premise (OP) licenses. Please label streets and avenues and identify your location. Use letters to indicate **Bar, Restaurant**, etc. The diagram must be submitted with the questionnaire to the Community Board before the meeting.

LOCATION:

How many licensed establishments are within 1 block? 2

How many On-Premise (OP) liquor licenses are within 500 feet? 2

Is premise within 200 feet of any school or place of worship? Yes No

COMMUNITY OUTREACH:

Please see the Community Board website to find block associations or tenant associations in the immediate vicinity of your location for community outreach. Applicants are encouraged to reach out to community groups. Also use provided petitions, which clearly state the name, address, license for which you are applying, and the hours and method of operation of your establishment at the top of each page. (Attach additional sheets of paper as necessary).

We are including the following questions to be able to prepare stipulations and have the meeting be faster and more efficient. Please answer per your business plan; do not plan to negotiate at the meeting.

1. I agree to close any doors and windows at 10:00 P.M. every night?
2. I will not have DJs, live music, promoted events, any event at which a cover fee is charged, scheduled performances, more than ___ DJs/ promoted events per ___, more than ___ private parties per ___
3. I will play ambient recorded background music only.
4. I will not apply for an alteration to the method of operation agreed to by this stipulation without first coming before CB 3.
5. I will not seek a change in class to a full on-premise liquor license. Or my business plan is to seek an upgrade at a later date.
6. I will not participate in pub crawls or have party buses come to my establishment.
7. I will not have a happy hour. Or Happy hour will end by _____.
8. I will not have wait lines outside. There will be a staff person outside to monitor sidewalk crowds and ensure no loitering.
9. Residents may contact the manager/owner at the following phone number. Any complaints will be addressed immediately and I will revisit the above-stated method of operation if necessary in order to minimize my establishment's impact on my neighbors.

CHO KO RESTAURANT INC.
INTERIOR DIAGRAM

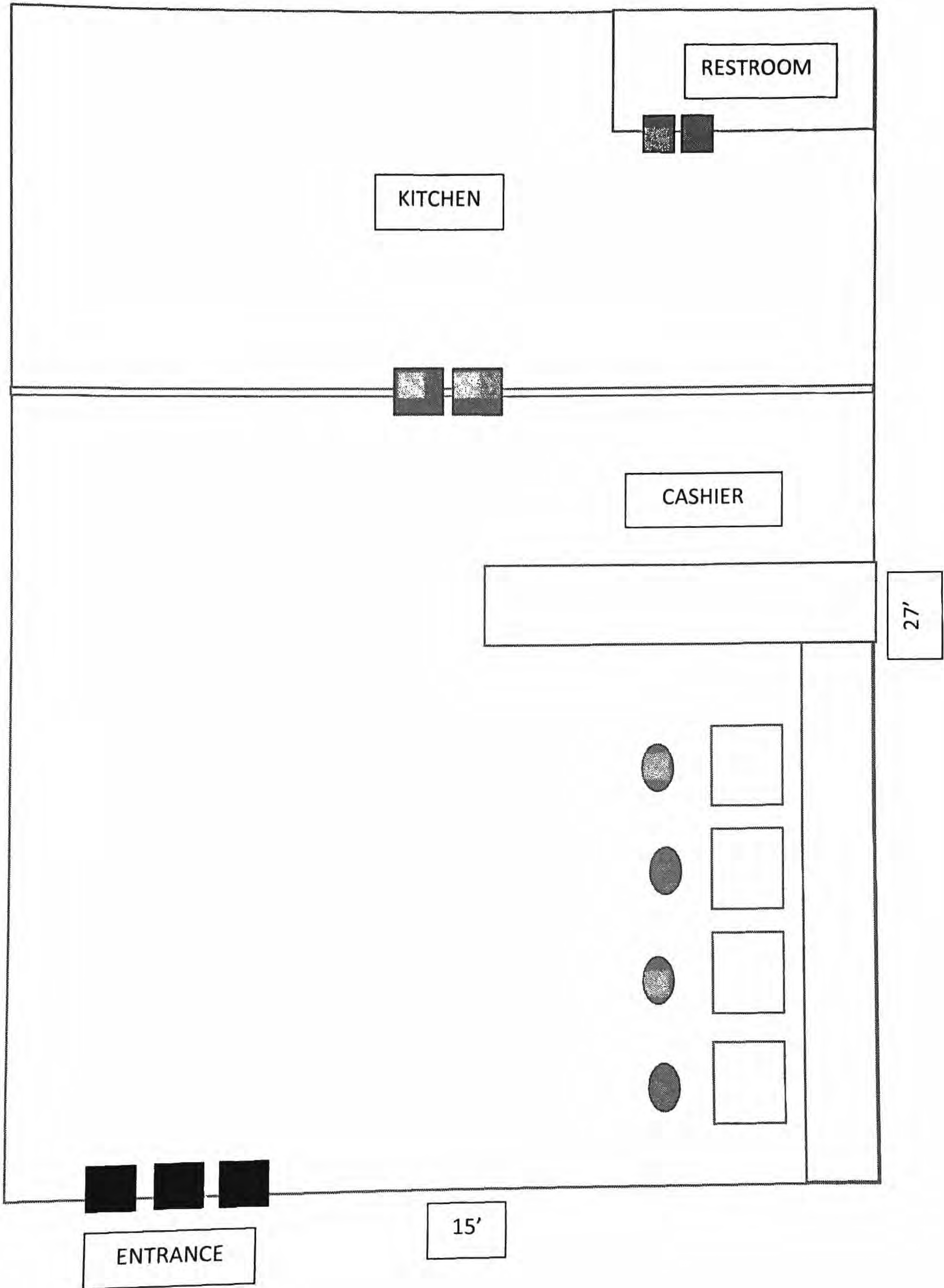

長興 CHO-KO

Japanese Restaurant

59 1st Ave New York NY 10003

(Between 3rd & 4th Street)

212-388-0885

FREE DELIVER (Min. \$10)

Delivery Hours: 12:00noon - 10:00pm

OPEN DAILY

Sun-Thur: 12:00noon - 12:00am

Fri-Sat: 12:00noon - 2:00am

APPETIZER

1. Gyoza(6pcs) 餃子 5.00
Fried dumplings w/Vegetables & pork
2. Menma メンマ 3.50
Marinated bamboo shoots, seaweed, Scallion, red pepper mix, soy sauce
3. Edamame 枝豆 3.50
Boiled soy beans
4. Chashu 焼豚 5.00
Sliced roast pork topped w/marinated scallions
5. Ban Ban Ji 棒々鶏 5.00
House Special Chicken w/marinated scallion & cucumber

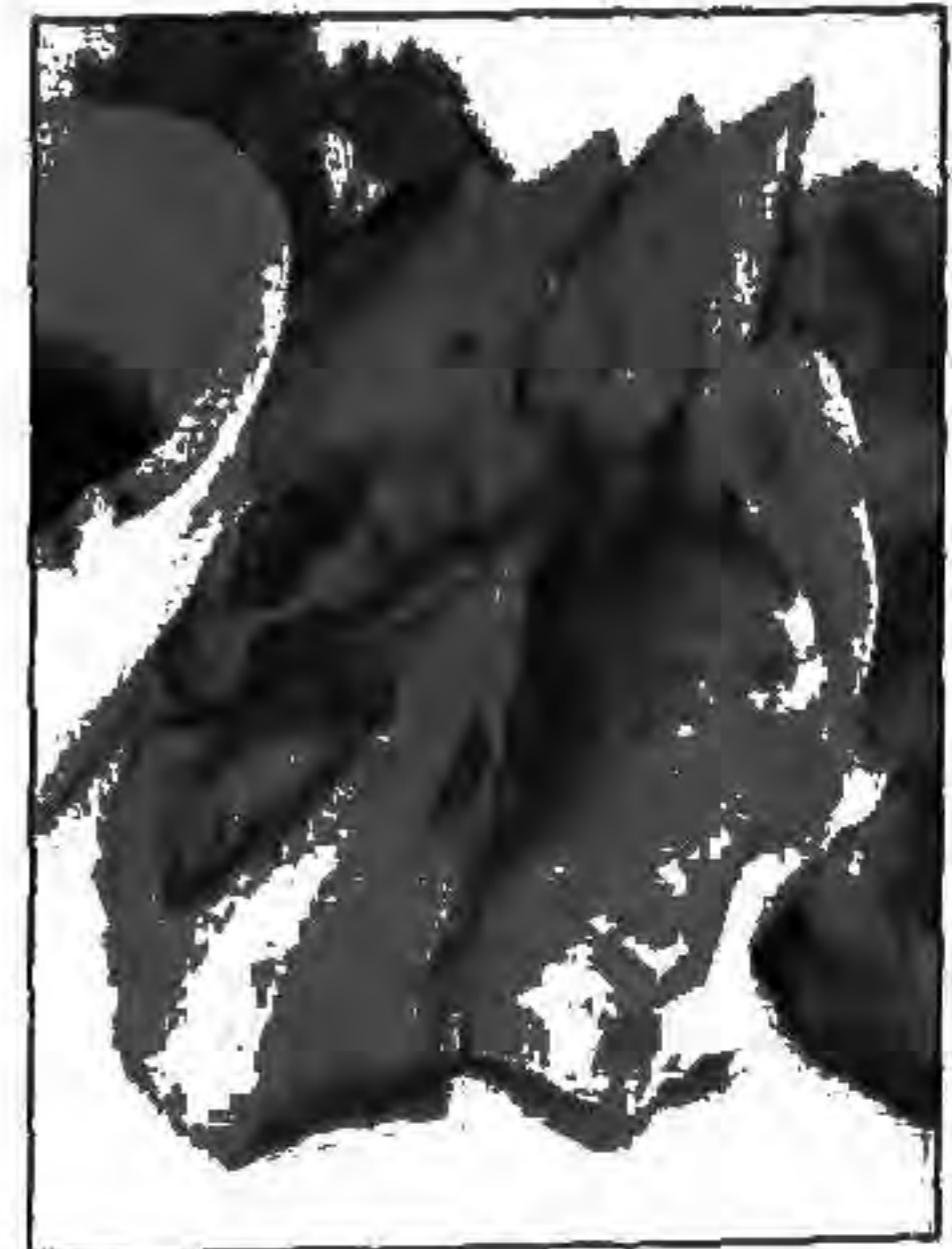

6. Kim-Chee キムチ 3.50
Chinese cabbage, radish, garlic, scallion, red pepper, anchovy sauce
7. Pork Buns(2pcs) ポークバンズ 5.00
Sliced Rasted pork belly & Vegetable steamed cake
8. Wantan(10pcs) ワンタン 5.00
Ground pork, scallion, egg & vegetables
9. Cho-Ko Salad 長興サラダ 3.50
w/lettuce, tomato, cucumber, carrot, cabbage
10. Fried Rice(half) 炒飯 (海鮮、豚肉、高菜) 5.00
Seafood or Pork or Vegetable, fried rice w/scallion & egg (Curry taste add extra \$1)
11. EBI Shumai (5pcs) エビシューマイ 6.00
Steamed Shrimp, Vegetable & mushroom dumplings
12. Pork Shumai (5pcs) 豚シューマイ 5.00
Steamed Pork, Vegetable & mushroom dumplings
13. Chicken Teriyaki チキン照り焼き 5.00
Grilled chicken w/teriyaki sauce & cucumber chicken
14. Miso Soup 味噌汁 2.00
15. Soy Sauce 醤油 1.00
16. Miso Soup 味噌スープ 1.50

NOODLE

16. Gomoku Ramen 五目ラーメン 9.00
Soy Sauce based soup topped w/vegetable, bamboo shoots, pork, chicken, squid, shrimp & boiled egg
17. Seafood Ramen 海鮮ラーメン 9.50
House Special seafood noodle soup topped w/ shrimp, squid, scallops, vegetable & boiled egg
18. Tan Tan Men 担々麺 9.50
Soy sauce sesame based soup w/ bamboo shoots, ground pork, spinach, boiled egg & scallion
19. Curry Ramen カレラーメン 9.50
Curry noodle soup topped w/ roast pork, bamboo shoots, spinach, boiled egg & scallion
20. Shoyu Ramen 醤油ラーメン 9.00
Soy sauce based noodle soup w/ bamboo shoots, boiled egg, roast pork & spinach
21. Miso Ramen 味噌ラーメン 9.50
Soy bean based noodle soup topped w/ bean sprout, cabbage, onion, crispy garlic, roast chicken & scallion
22. Ma Bo ToFu Ramen 麻婆ラーメン 9.50
Soy sauce based noodle soup topped w/ Ground pork, tofu, ginger, chili, garlic & scallion

Extra toppings エクストラトッピング

- | | |
|--------------------|------|
| Corn トウモロコシ | 1.00 |
| Butter バター | 1.00 |
| Noodle ノードル | 2.00 |
| Roast pork ローストポーク | 3.00 |

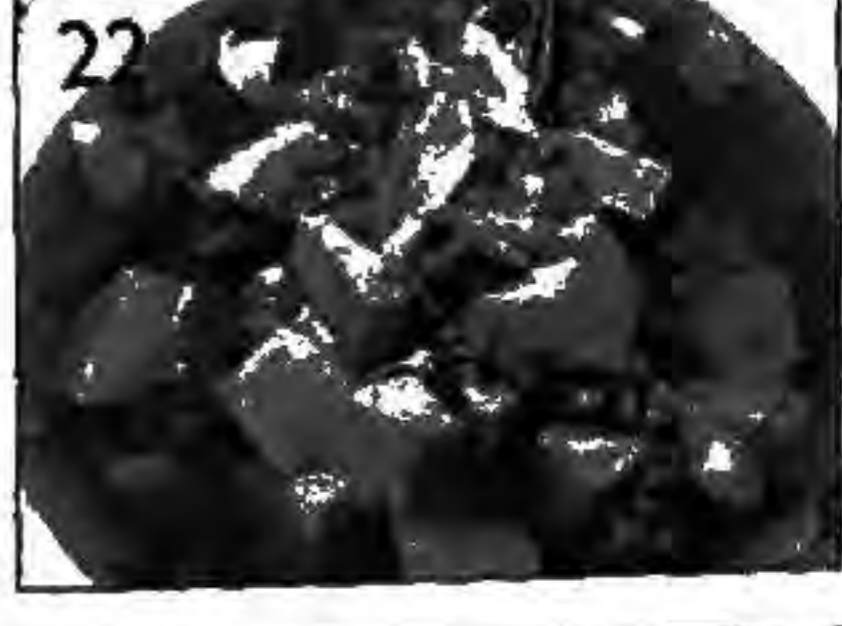
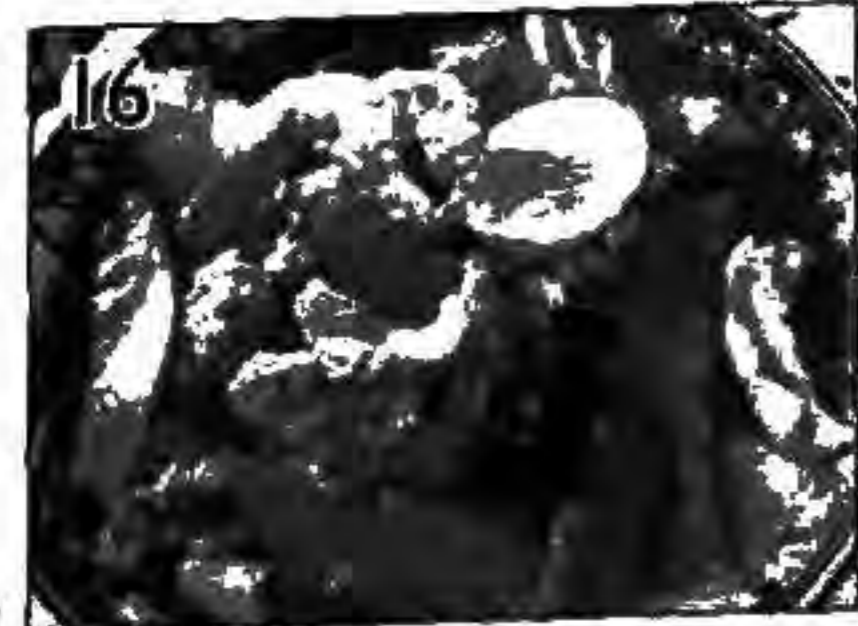

SAUTEED NOODLE Served with soup

23. Gomoku Cata Yaki Soba 五目カタ焼きそば 9.00
Sautee noodle w/pork, chicken, squid, vegetable, egg & shrimp
24. Seafood Cata Yaki Soba 海鮮カタ焼きそば 9.00
Sautee noodle w/vegetable, shrimp, squid, scallops & boiled egg

OTHER ITEMS Served with soup

25. Yaki Soba 焼きそば 8.00
Fried noodle w/ vegetable & pork
26. Gomoku Yaki Soba 五目焼きそば 9.00
Fried noodle w/ pork, chicken, squid, vegetables & egg, shrimp
27. Seafood Yaki Soba 海鮮焼きそば 9.50
Fried noodle w/ shrimp, squid, scallops, vegetable & boiled egg
28. Fried Rice 炒飯 (海鮮、豚肉、高菜) 8.00
*Seafood or pork or vegetable, fried rice w/scallion & egg
 (Curry taste add extra \$1)*
29. Niku Yasai Itame 肉野菜炒め 7.50
Fried sauce based Pork & vegetable



SUMMER ITEMS (MAS-SEPI) 夏のアイテム

30. Hiyashi Chu-ka 冷やし中華 9.50
Chilled noodle & vinegar dressing with sauce broth topped w/ Roast chicken & pork, cucumber, carrot, green onion, lettuce, tomato, sesame seeds & shrimp, mustard
31. Zha Jiang Men 炸醬麵 9.00
Chilled noodle & sauce with pork, bean sprouts, cucumber, carrot, green onion, garlic, mushroom, bamboo shoots, soybean sprouts
32. Tsuke Men つけ麺 9.50
Thick, chewy cold noodle with special sauce, pork, spinach, egg, seaweed & scallion

OVER RICE DISHES Served with soup

33. Gomoku Bowl 中華丼 8.50
Vegetable, pork, squid, chicken, egg & shrimp over steamed rice
34. Seafood Bowl 海鮮丼 9.00
Seafood, vegetable, shrimp, squid, scallops & boiled egg over rice
35. 🍷 Beef Curry ビーフカレー 9.00
Curry based topped w/beef, potatoes & carrots over rice
36. 🍷 Mabo Bowl 麻婆丼 8.50
Special cooked ground pork, tofu & scallion over rice



DESSERT

- An-Nin-Tofu 杏仁豆腐 2.75

DRINK 2.00

- | | | |
|------------|--------------------------|--------------|
| Coke | Dcoke | Bottle Water |
| Sprite | Green Tea (Hot or Cold) | |
| Ginger Ale | OoLong Tea (Hot or Cold) | |