

1a

ZONING MAP

CITY PLANNING COMMISSION
THE CITY OF NEW YORK



	1a	1c
	1b	1d

EFFECTIVE: DECEMBER 15, 1961

001

COPYRIGHTED BY THE CITY OF NEW YORK

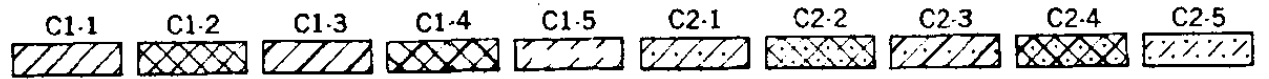
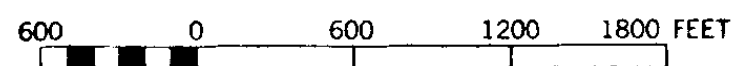
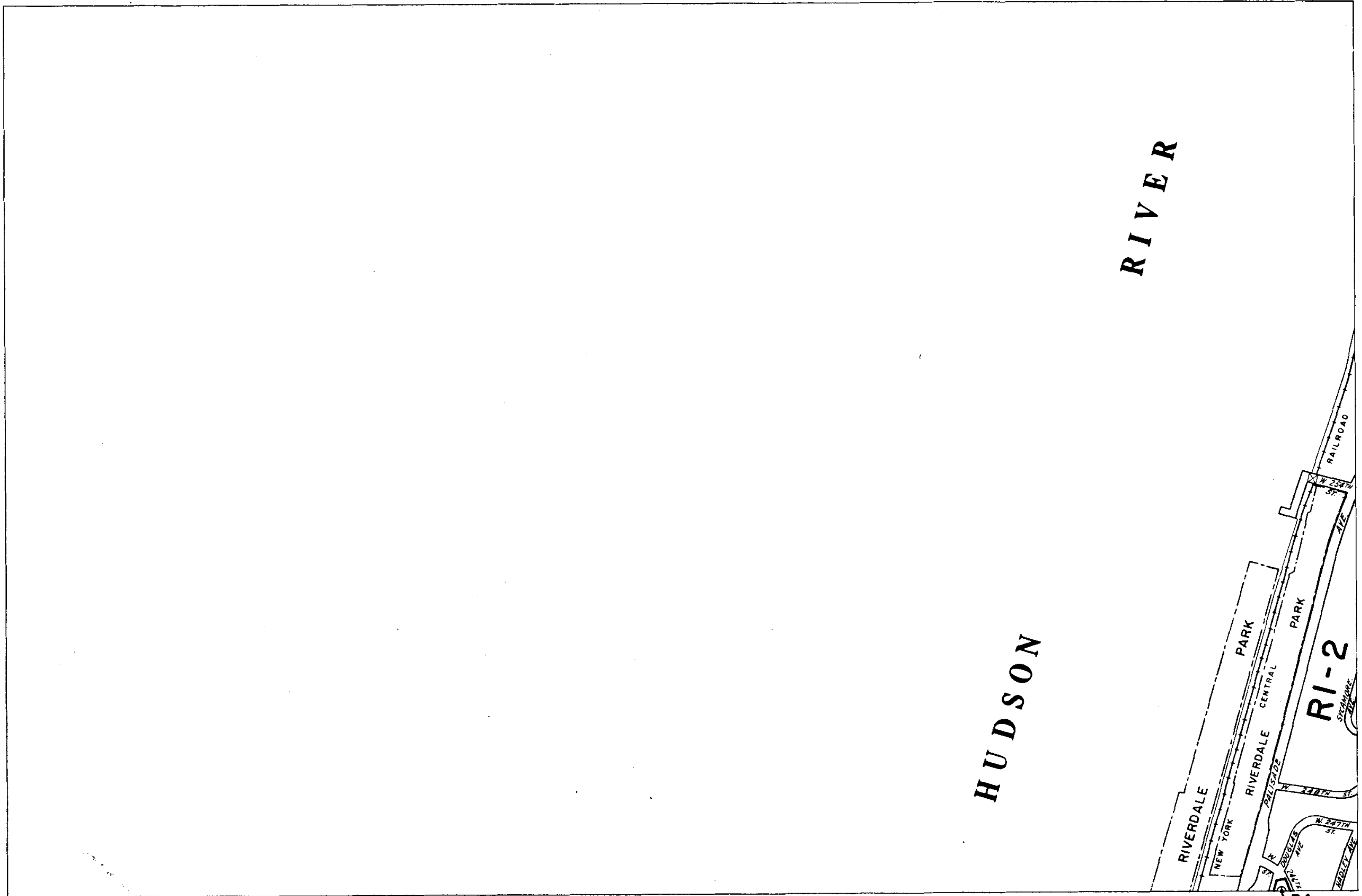

1a

ZONING MAP

CITY PLANNING COMMISSION

THE CITY OF NEW YORK



	1a	1c
	1b	1d

..... INDICATES PROPERTY
REZONED BY AMENDMENT
EFFECTIVE: DECEMBER 18, 1969

A-925

CP 20881

COPYRIGHTED BY THE CITY OF NEW YORK

002

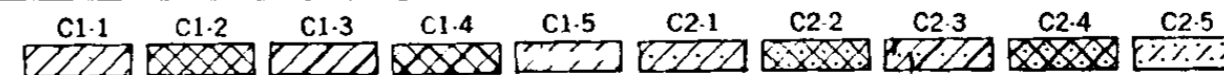
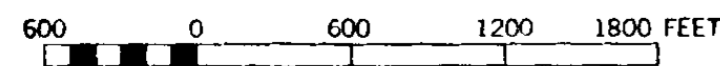
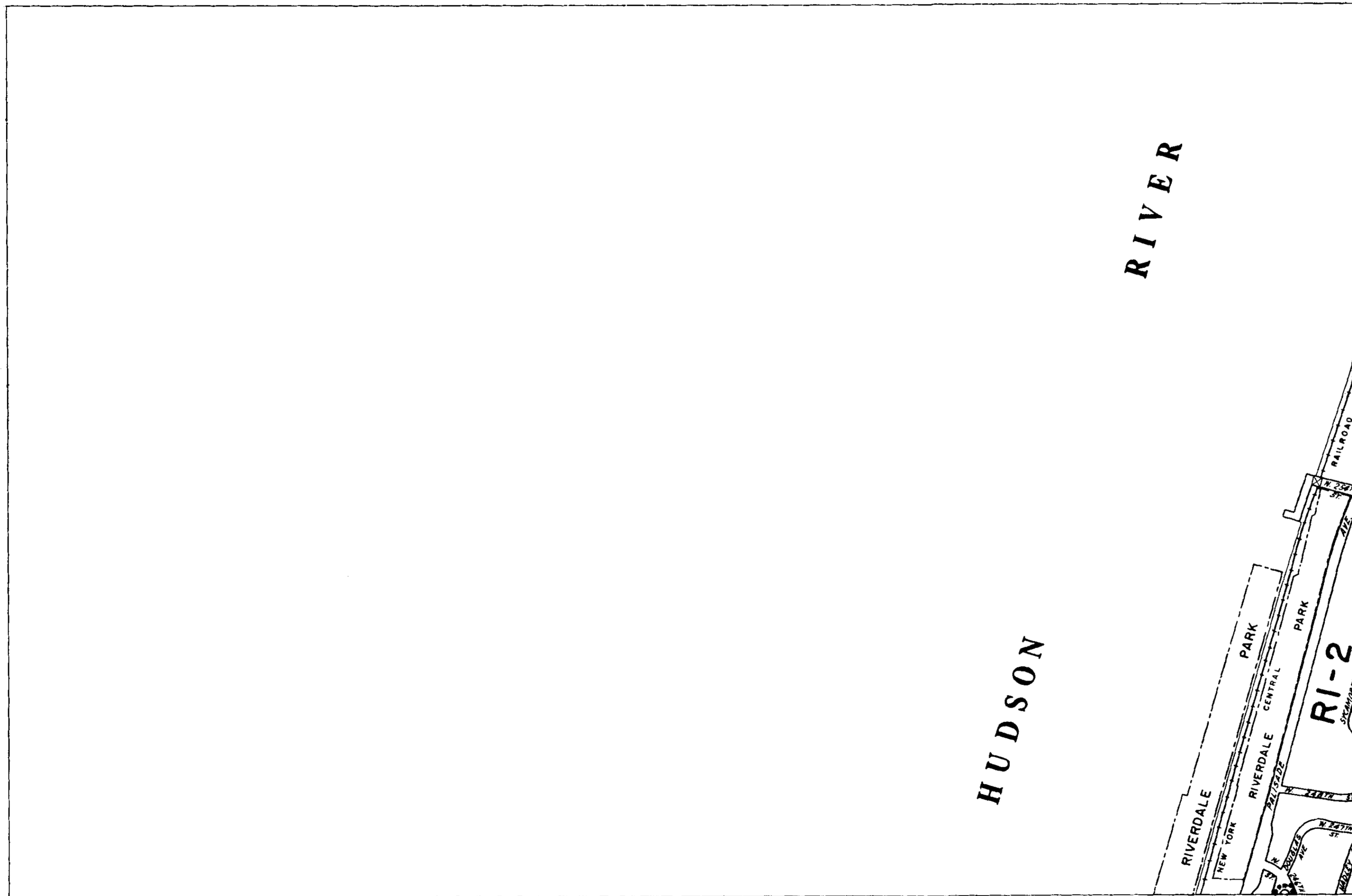

1a

ZONING MAP

CITY PLANNING COMMISSION
THE CITY OF NEW YORK

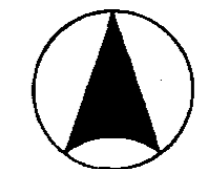

	1a	1c
	1b	1d

■ M-2 INDICATES PROPERTY
REZONED BY AMENDMENT
EFFECTIVE: MAY 21, 1975

A-1200
G 22878

COPYRIGHTED BY THE CITY OF NEW YORK

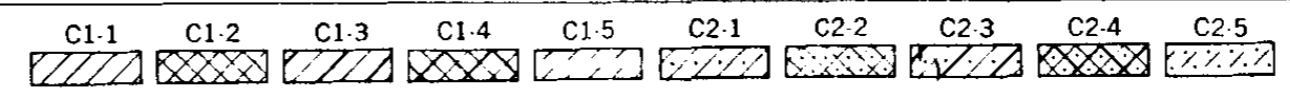
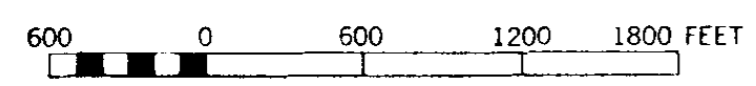
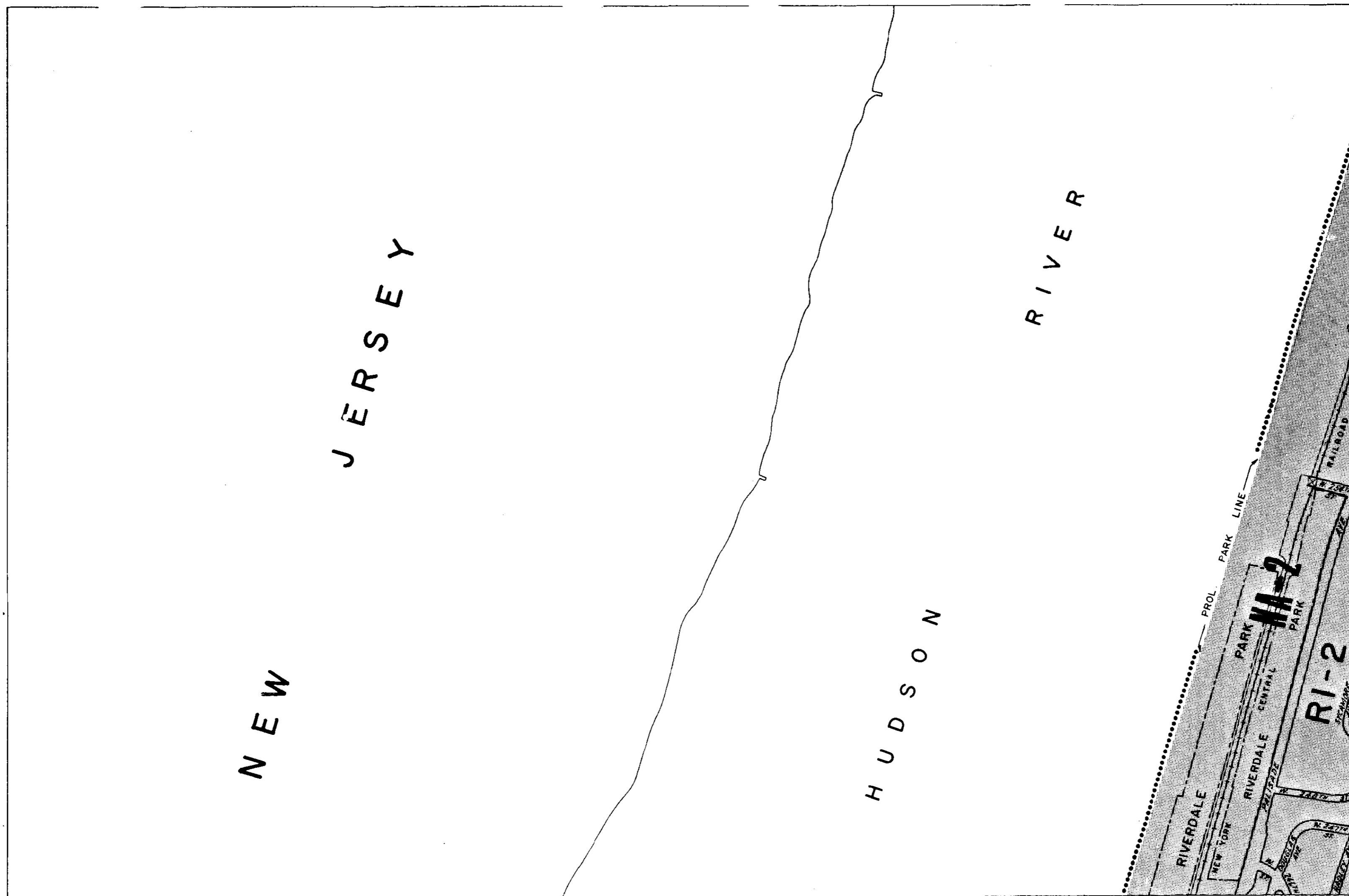

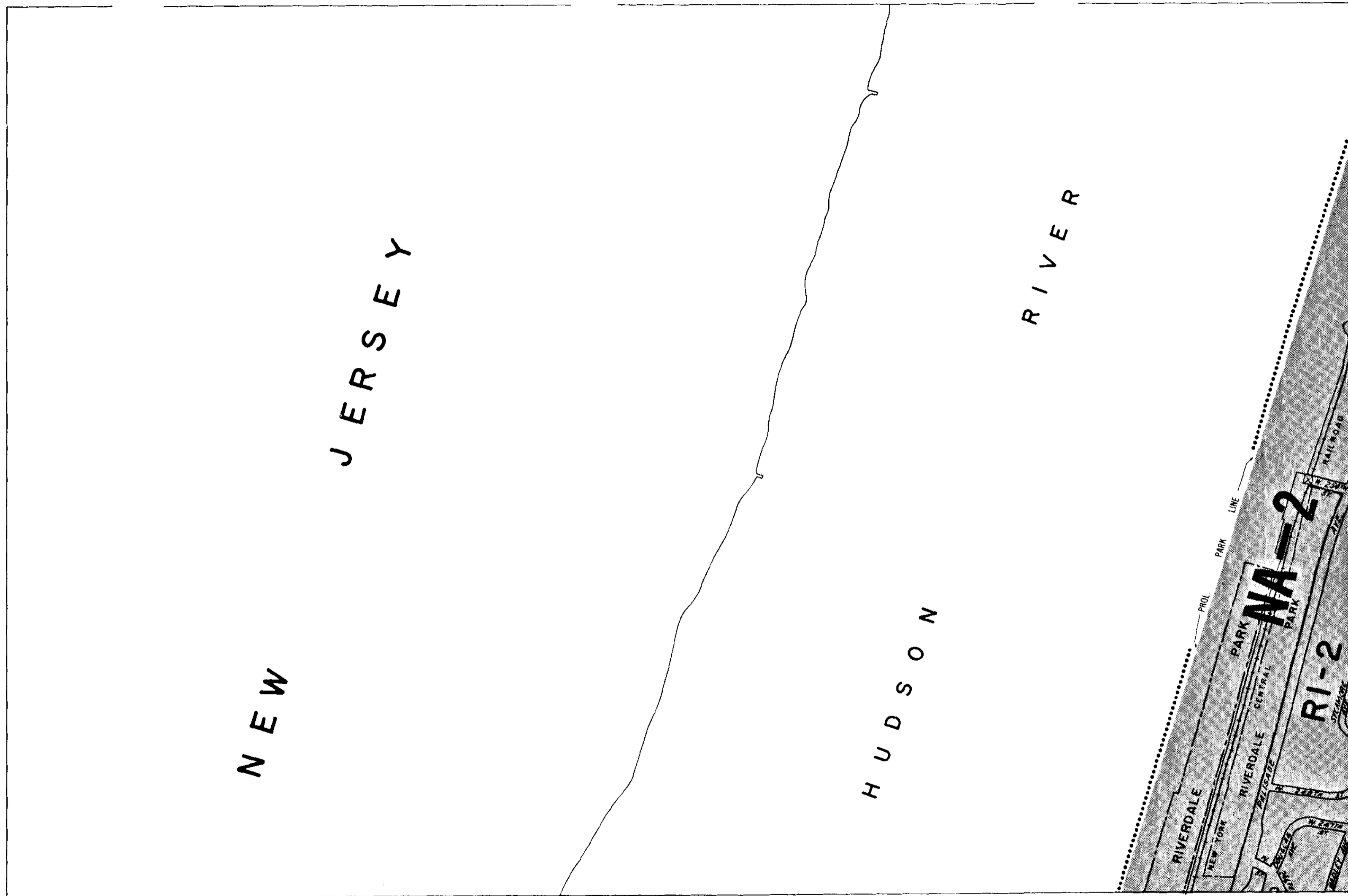

ZONING MAP

THE NEW YORK CITY PLANNING COMMISSION

MAJOR ZONING CLASSIFICATIONS



- R — RESIDENTIAL DISTRICT
- C — COMMERCIAL DISTRICT
- M — MANUFACTURING DISTRICT

The number(s) and/or letter(s) which follows an "R", "C", or "M" district designation indicates use, bulk, and other controls as described in the text of the Zoning Resolution.

SPECIAL PURPOSE DISTRICTS

The letter(s) within the shaded area designates the special purpose district as described in the text of the Zoning Resolution.

INDICATES PROPERTY REZONED BY AMENDMENT EFFECTIVE 5-21-75

CP 22878 A-1200

(D) RESTRICTIVE DECLARATION, FOR DETAIL REFER TO R.D. SHEET.

MAP KEY

	1a	1c
	1b	1d

ZONING MAP 1a

● COPYRIGHTED BY THE CITY OF NEW YORK

003R

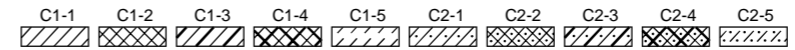
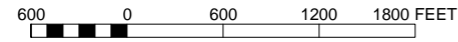
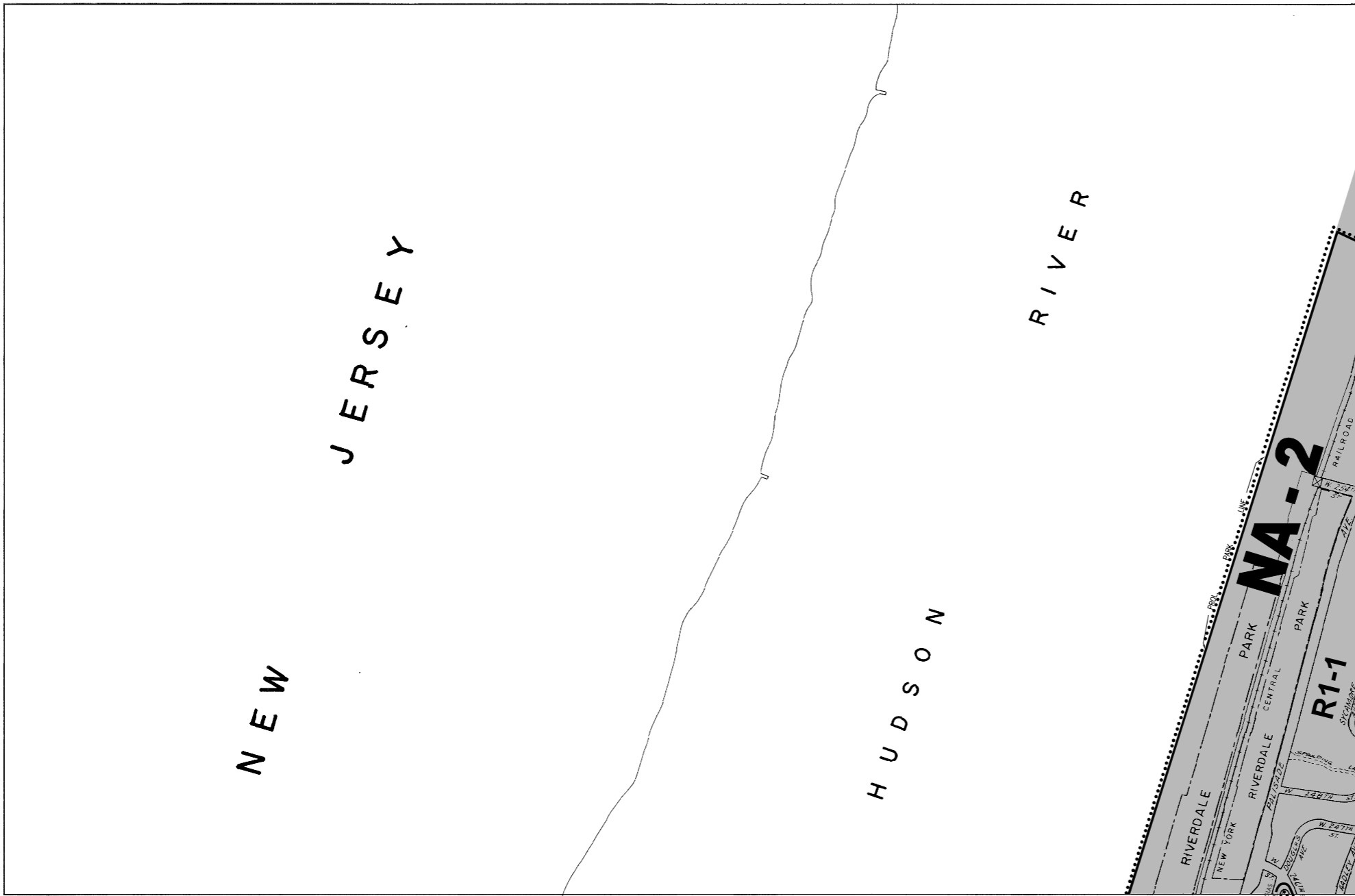

NOTE: Where no dimensions for zoning district boundaries appear on the zoning maps, such dimensions are determined in Article VII, Chapter 6 (Location of District Boundaries) of the Zoning Resolution.

ZONING MAP

THE NEW YORK CITY PLANNING COMMISSION

Major Zoning Classifications:

The number(s) and/or letter(s) that follows an **R**, **C** or **M** District designation indicates use, bulk and other controls as described in the text of the Zoning Resolution.

- R** – RESIDENTIAL DISTRICT
- C** – COMMERCIAL DISTRICT
- M** – MANUFACTURING DISTRICT

⋯ AREA(S) REZONED

EFFECTIVE DATE(S) OF REZONING:
10-11-2005 C 050480 ZMX

■ SPECIAL PURPOSE DISTRICT
The letter(s) within the shaded area designates the special purpose district as described in the text of the Zoning Resolution.

- ⓓ – RESTRICTIVE DECLARATION
- ⓔ – CITY ENVIRONMENTAL QUALITY REVIEW DECLARATION

MAP KEY

	1a	1c
	1b	1d

© Copyrighted by the City of New York

NOTE: Zoning information as shown on this map is subject to change. For the most up-to-date zoning information for this map check the Department of City Planning website: <http://www.nyc.gov/html/dcp/html/subcats/zoning.html> or contact the Zoning Information Desk at (212) 720-3291.

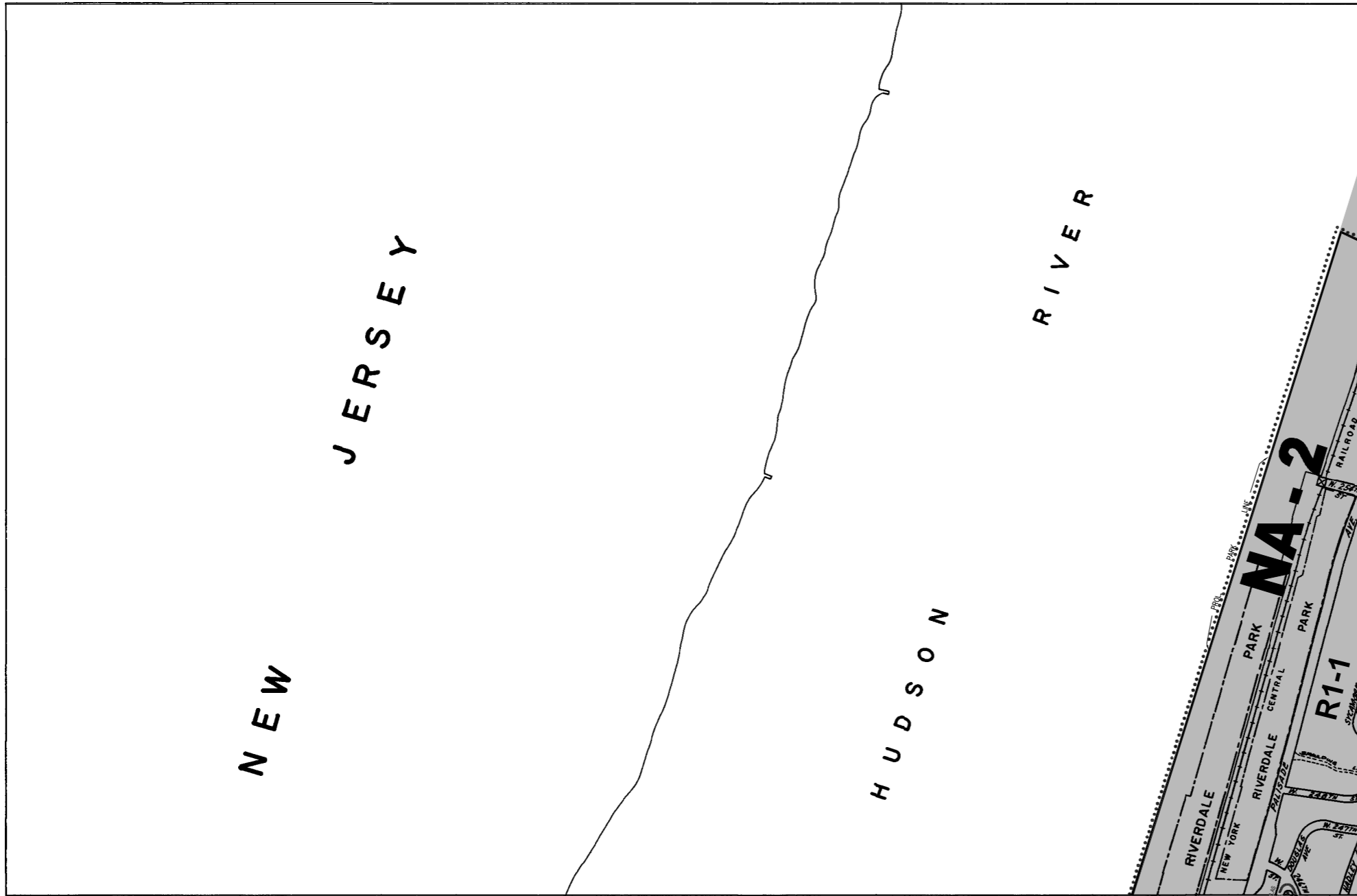

ZONING MAP

THE NEW YORK CITY PLANNING COMMISSION

Major Zoning Classifications:

The number(s) and/or letter(s) that follows an R, C or M District designation indicates use, bulk and other controls as described in the text of the Zoning Resolution.

- R – RESIDENTIAL DISTRICT
- C – COMMERCIAL DISTRICT
- M – MANUFACTURING DISTRICT

SPECIAL PURPOSE DISTRICT
The letter(s) within the shaded area designates the special purpose district as described in the text of the Zoning Resolution.

AREA(S) REZONED

Effective Date(s) of Rezoning:

10-11-2005 C 050480 ZMX

Special Requirements:

For a list of lots subject to CEQR environmental requirements, see APPENDIX C.

For a list of lots subject to "D" restrictive declarations, see APPENDIX D.

For Inclusionary Housing designated areas on this map, see APPENDIX F.

MAP KEY

	1a	1c
	1b	1d

© Copyrighted by the City of New York

ZONING MAP **1a**

600 0 600 1200 1800 FEET

- C1-1
- C1-2
- C1-3
- C1-4
- C1-5
- C2-1
- C2-2
- C2-3
- C2-4
- C2-5

NOTE: Where no dimensions for zoning district boundaries appear on the zoning maps, such dimensions are determined in Article VII, Chapter 6 (Location of District Boundaries) of the Zoning Resolution.

NOTE: Zoning information as shown on this map is subject to change. For the most up-to-date zoning information for this map, visit the Zoning section of the Department of City Planning website: www.nyc.gov/planning or contact the Zoning Information Desk at (212) 720-3291.

Metadata for Historical Zoning Maps:

Source:

These PDF maps were created from the set of past versions of each of the 126 zoning maps in the Technical Review Division's archive. This set includes map versions for each zoning map beginning with the original 1961 issue of the Zoning Resolution and ending with the current zoning map as posted in the Zoning section of the Department of City Planning website: www.nyc.gov/planning.

Scanning and Creation of Adobe PDF copies:

Maps in this archive from 1961 through Update #2 of the Zoning Resolution in 2003 are scans of actual printed zoning map. From Update #3 (2005) onwards, maps are direct PDF copies of the map revisions as printed in updates to the Zoning Resolution.

Notes on conversion of Amendment Numbers to CP (City Planning) or ULURP numbers:

On earlier zoning maps, an Amendment Number (e.g. A-629) is used to identify the area that has been rezoned. Commission reports and sketch maps for rezonings are referenced solely by CP or ULURP numbers. In order to request copies of reports or sketch maps it is necessary to know the CP or ULURP number. A conversion table (ANumber-CPNumberConversion.pdf) is available to translate the "A" numbers listed on the actual zoning maps to their corresponding CP or ULURP numbers. Use of the Amendment Number to identify zoning map changes has been discontinued.

Copyright:

These maps are copyrighted by the City of New York. This is indicated in the space below the map legend on each map.

Contact Info:

NYC Department of City Planning
22 Reade Street, RM 3N
New York, NY 10007
212.720.3505 phone
zoning_gis@planning.nyc.gov