



# BEACH 108<sup>TH</sup> ST CAPITAL RECONSTRUCTION

Presentation to Community Board 14

January 16, 2019

# AGENDA

1. Project Background
2. Project Goals
3. Summary of Feedback Session
4. Project Proposal
  1. Geometry
  2. Landscape and Street Furnishings
5. Project Timeline

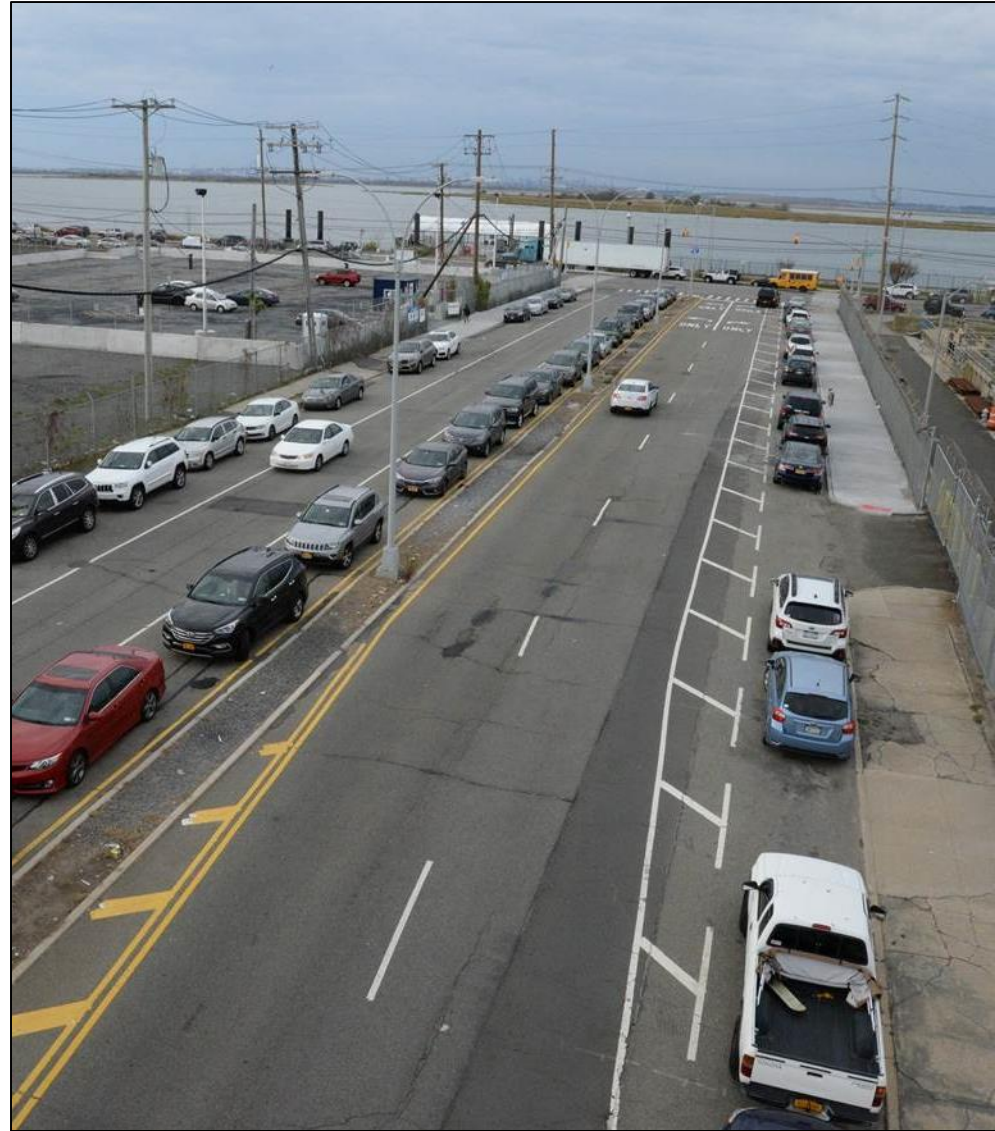

---

## Project Background

# 1

# PROJECT AREA AND ORIGIN

Rockaway West NY Rising report identified Beach 108<sup>th</sup> St as a key economic development and infrastructure project. DOT/DDC will be reconstructing Beach 108<sup>th</sup> St between Beach Channel Drive and Shore Front Parkway.



# PROJECT FUNDING

\$16.9 million project

\$3.8 million in city funds

\$13.1 million in federal HUD funding

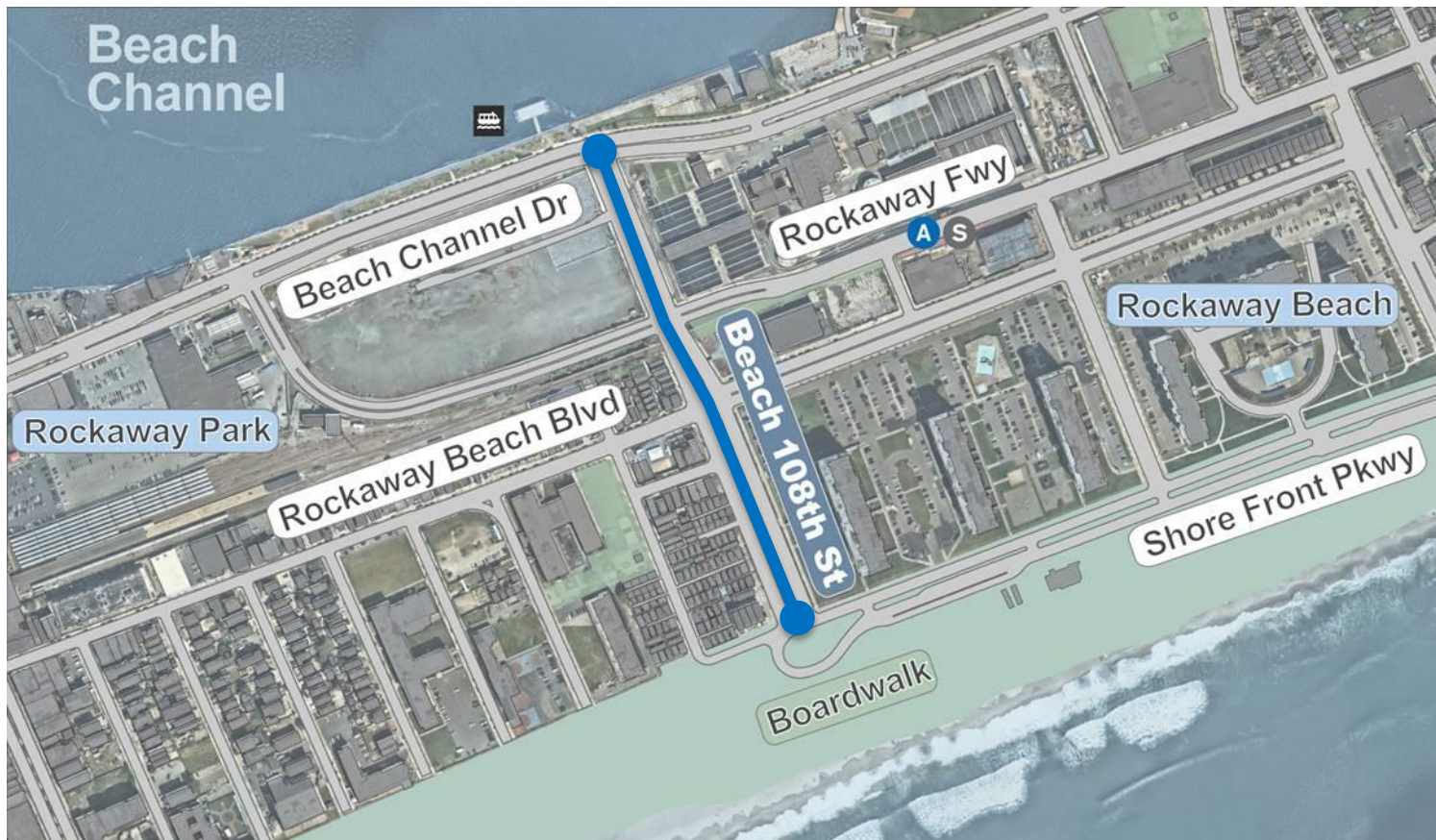

# BACKGROUND

- Requests from community for left turn bays and phases at Rockaway Beach Blvd and Beach 108th St (bays added)
- Requests from community for reconstructed sidewalks to ferry (mostly completed)
- Area-wide requests for angled parking
- Ferry launched in May 2017
- 2 Motorist KSI's (killed or severely injured) occurred at Rockaway Freeway

## Beach 108<sup>th</sup> St (Beach Ch. Dr. to Shore Front Pkwy), QN

Injury Summary, 2012-2016 (5 years)

	Total Injuries	Severe Injuries	Fatalities	KSI
Pedestrian	3	0	0	0
Bicyclists	2	0	0	0
Motor Vehicle Occupant	21	2	0	2
Total	26	2	0	2



Beach 108<sup>th</sup> St at Rockaway Beach Blvd

# EXISTING CONDITIONS

- Roadway varies in width and alignment
- Southbound: one consistent thru lane
- Northbound: one thru lane, widening to two past Rockaway Beach Blvd
- NB left turn lane at Rockaway Fwy, left turn bays at Rockaway Beach Blvd
- Buffered bike lanes connecting to Rockaway Beach Blvd lanes and Shore Front Pkwy path
- Parking on majority of medians with excess channelization



---

## Project Goals

# 2

# PEDESTRIANS

Goal: Improve Pedestrian Accessibility and Safety to Ferry and Boardwalk

- Limited sidewalk space during peak season
- High pedestrian volumes on west side of street with narrow sidewalks



**Limited sidewalk space during peak season**



**Long crosswalks at Rockaway Beach Blvd**

# VEHICLES

Goal: Improve roadway alignment and vehicular operations

- Street profile narrows north of Rockaway Beach Blvd
- Offset alignment and skewed intersection with no left turn phases at Rockaway Beach Blvd creates conflicts between turning vehicles

Goal: Maintain or add parking along project corridor

- High parking demand area



Alignment shifts north of Rockaway Beach Blvd



Heavy left turns at Rockaway Beach Blvd

# BICYCLES

Goal: Improve bicycle access to ferry and boardwalk

- Existing bike lane on one block of Beach 108<sup>th</sup> St does not connect to ferry
- Current buffered lanes have frequent double parking



# GOALS SUMMARY

- 1.Improve pedestrian access
- 2.Improve roadway alignment
- 3.Improve vehicular operations
- 4.Maintain or add parking
- 5.Improve bicycle access
- 6.Maintain Landscaping



---

## Summary from Feedback Session

3

# MAJOR COMMENTS

- 1 Maintain access to Rockaway Beach Drive
- 2 Maintain parking on northern median for ferry access
- 3 Improve pedestrian crossings at Beach Channel Drive

Comments heard but unable to be addressed

- 1 Discourage beachgoers from using western, residential sidewalk  
Response: Difficult to prevent pedestrians from using shortest path

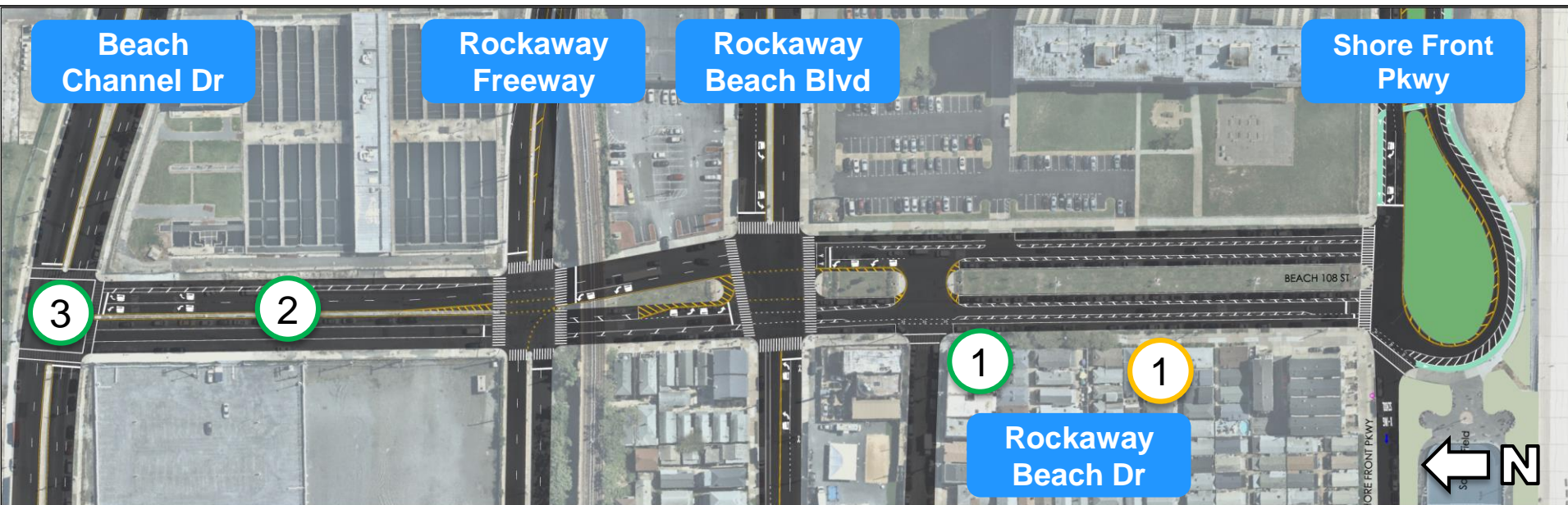

---

## Project Proposal

1. Geometry
2. Landscaping and Street Furnishings

# 4

# GEOMETRY – AT BEACH CHANNEL DR

- 1 Construct “Top-of-the-T” curb extension (part of Beach Channel Dr. Capital Project)
- 2 Add two-way bike path with tree plantings on median
- 3 Maintain two lanes at intersection approach
- 4 Reconstruct sidewalks (14’ on the west, 12’ on the east)
- 5 Add protected left turn phase for Beach 108<sup>th</sup> St

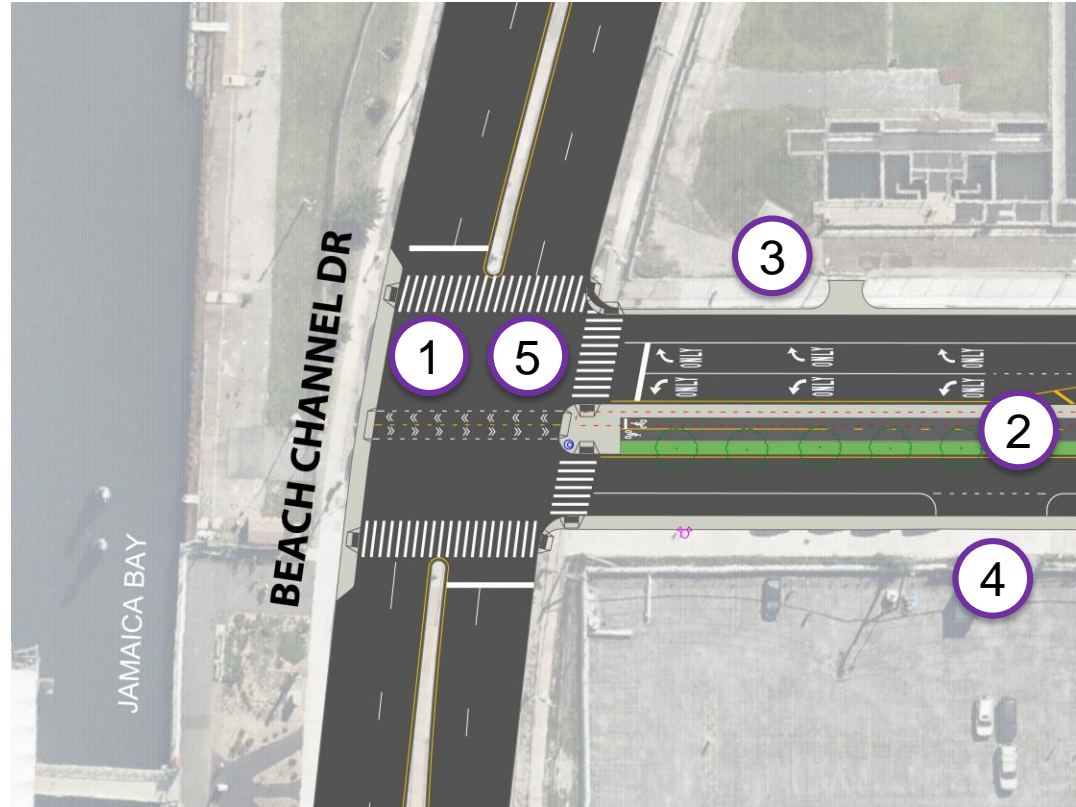

Beach  
Channel Dr

Rockaway  
Freeway

Rockaway  
Beach Blvd



Shore Front  
Pkwy

# GEOMETRY – AT FERRY PARKING LOT

- 1 Flip parking to east side of median south of turn bay
- 2 Add median, two-way bike path with tree plantings
- 3 Maintain one southbound travel lane
- 4 Reconstruct sidewalks (14' on the west, 12' on the east)

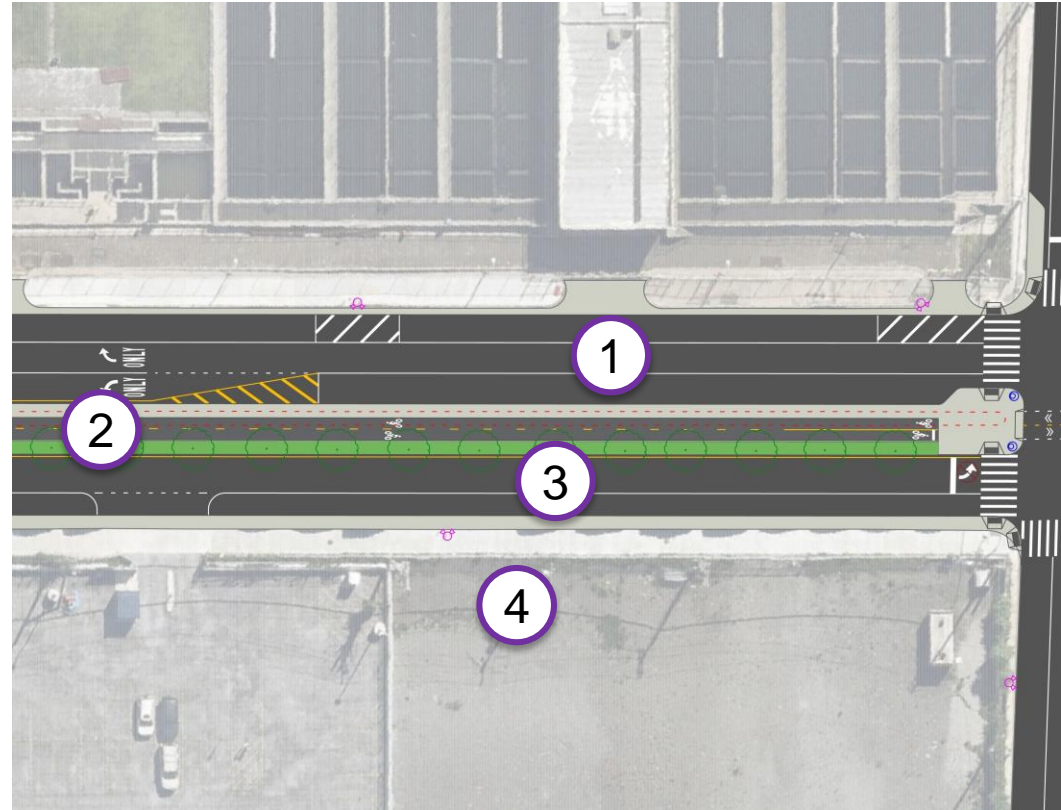

Beach  
Channel Dr

Rockaway  
Freeway

Rockaway  
Beach Blvd



Shore Front  
Pkwy

# GEOMETRY – AT ROCKAWAY FREEWAY

- 1 Add parking on Rockaway Freeway west and east of Beach 108<sup>th</sup> St
- 2 Add protected left turn phase for northbound Beach 108<sup>th</sup> St
- 3 Ban southbound left turn to Rockaway Freeway (0-5 cars in peak hours)
- 4 Construct curb extension on NE corner
- 5 Reconstruct sidewalks (15' on both sides of Beach 108<sup>th</sup> St)

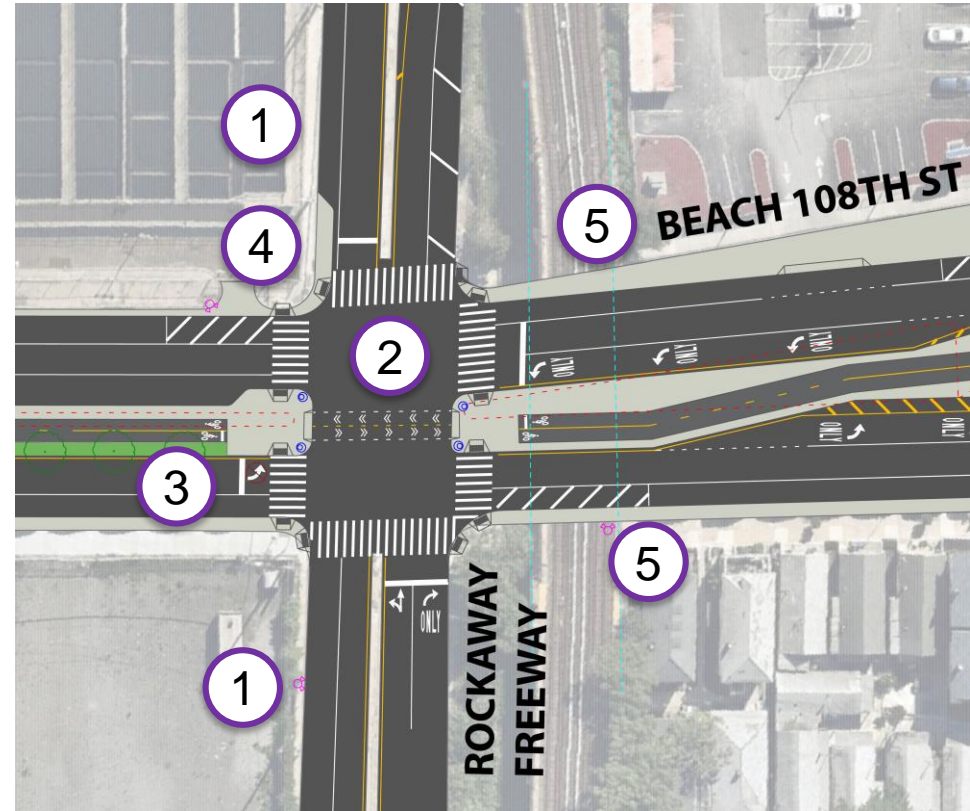

Beach  
Channel Dr

Rockaway  
Freeway

Rockaway  
Beach Blvd



Shore Front  
Pkwy

# GEOMETRY – AT ROCKAWAY BEACH BLVD

- 1 Pull back median on Rockaway Beach Blvd, creating left turn bay
- 2 Construct bus bulb on NE corner at existing bus stop with red bus queue jump/right turn lane
- 3 Add dual, protected left turn phase for Beach 108<sup>th</sup> St
- 4 Convert east side of Beach 108<sup>th</sup> St to back in angled parking
- 5 Maintain access to Rockaway Beach Dr

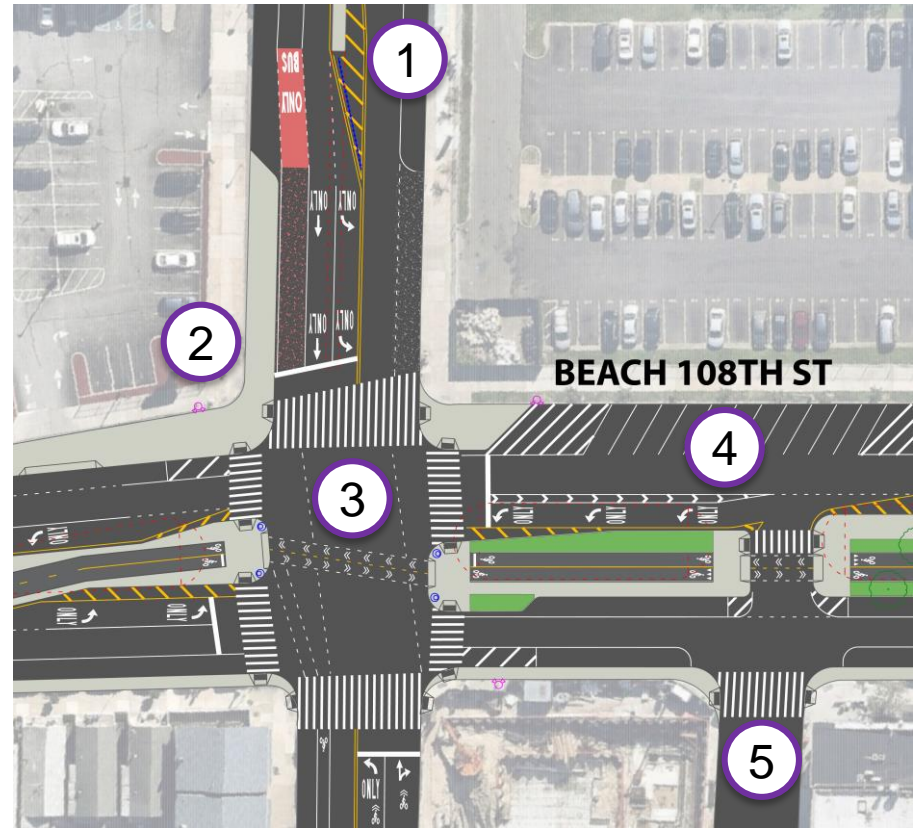

Beach  
Channel Dr

Rockaway  
Freeway

Rockaway  
Beach Blvd



Shore Front  
Pkwy

# GEOMETRY – AT ROCKAWAY BEACH BLVD

- 1 Restore parking to Shore Front Parkway by rerouting bike path
- 2 Add new sidewalk and crossing across median at Shore Front Parkway
- 3 Connect bike path to boardwalk through median
- 4 Construct curb extension on NE corner
- 5 Add new crossings to boardwalk stairs
- 6 Reconstruct and widen west sidewalk, maintaining tree lawn (20')

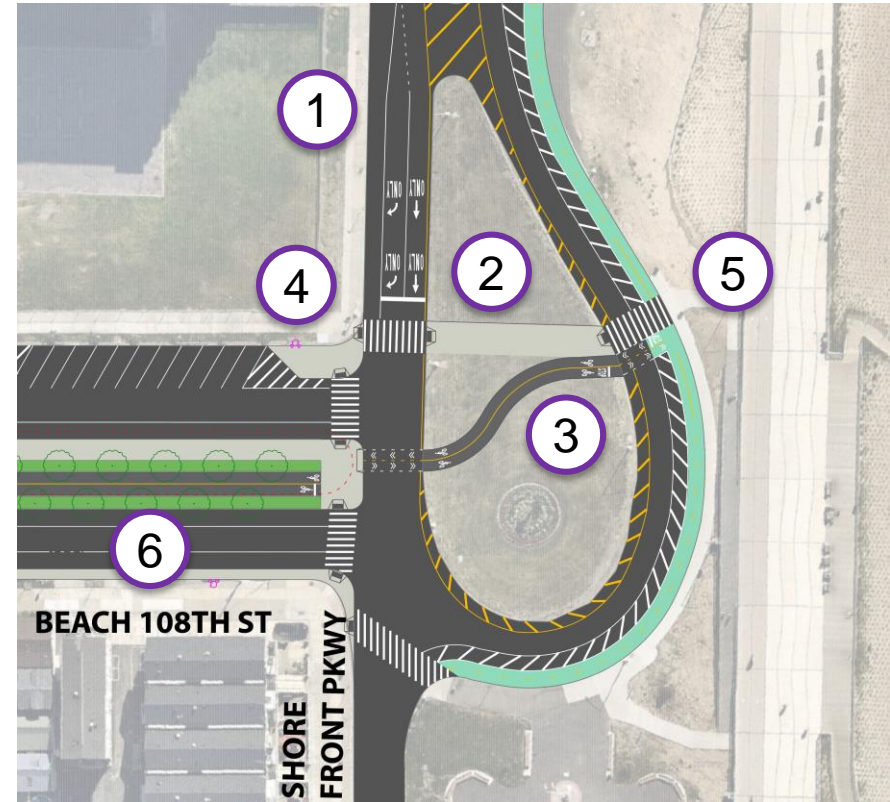

Beach  
Channel Dr

Rockaway  
Freeway

Rockaway  
Beach Blvd



Shore Front  
Pkwy

# LANDSCAPE AND STREET FURNISHINGS

- 1 Add street trees to median wherever possible
- 2 Add street trees in front of DEP facility
- 3 Add street trees and benches at new bus bulb and widened sidewalk on NE corner of Beach 108<sup>th</sup> St and Rockaway Beach Blvd
- 4 Add pedestrian scale lighting to median
- 5 Improve lighting under MTA structure

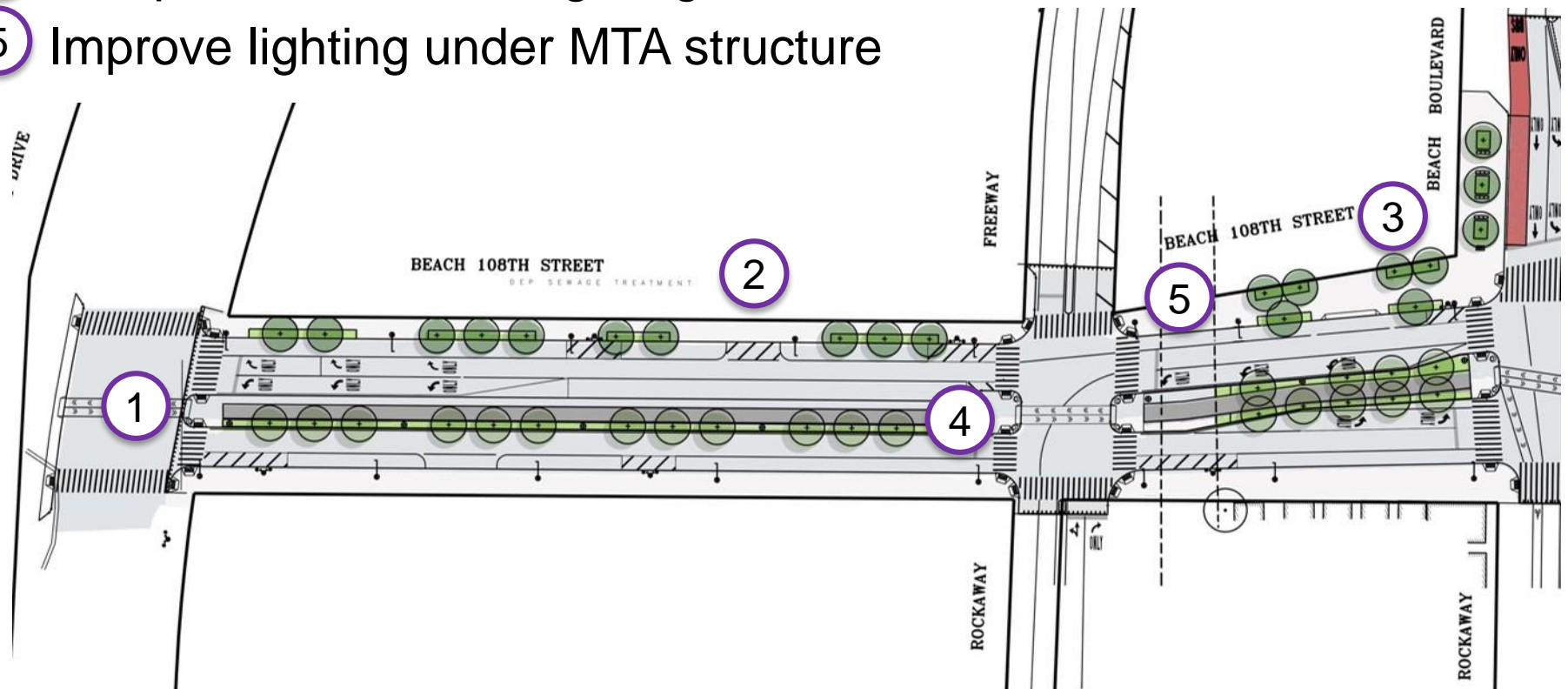

# LANDSCAPE AND STREET FURNISHINGS

- 1 Add street trees to median wherever possible
- 2 Replace missing trees on east and west tree lawns
- 3 Maintain community planting spaces at Rockaway Beach Blvd and reinstall “Welcome” sign following construction
- 4 Add plantings along bike path in Shore Front Pkwy median
- 5 No changes to circular planting area in Shore Front Pkwy median

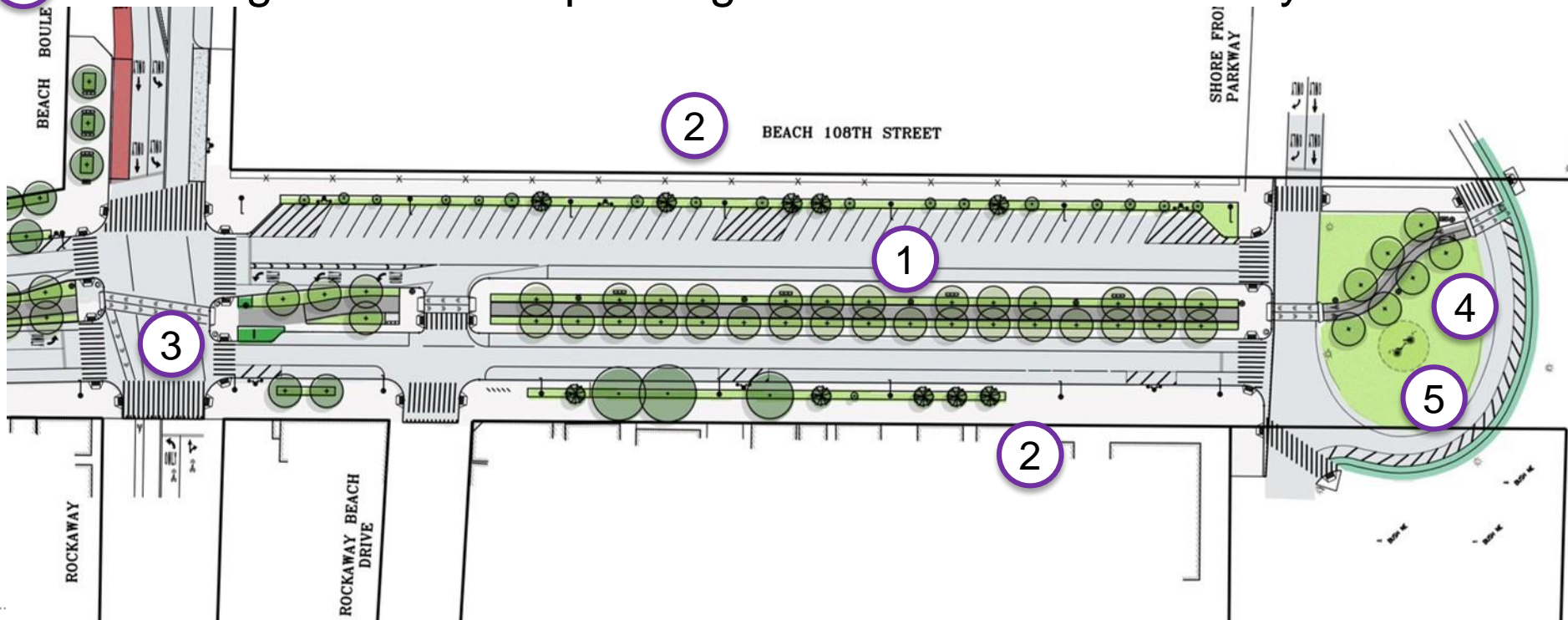

# LANDSCAPE AND STREET FURNISHINGS

## Section A looking south



- ① 'Flatbush Ave' decorative street lights (used on Beach 116<sup>th</sup> St)
- ② 'Flushing Meadows' decorative pedestrian light

## Section B looking south



Beach  
Channel Dr

Rockaway  
Freeway

Rockaway  
Beach Blvd



Shore Front  
Pkwy

# LANDSCAPE AND STREET FURNISHINGS



01

02

03

04

05

06

07

08

09

10

11

12

13

14

15

16

17

18

19

20

21

22

23

24

25

26

27

28

29

30

31

32

33

34

35

36

37

38

39

40

41

42

43

44

45

46

47

48

49

50

51

52

53

54

55

56

57

58

59

60

61

62

63

64

65

66

67

68

69

70

71

72

73

74

75

76

77

78

79

80

81

82

83

84

85

86

87

88

89

90

91

92

93

94

95

96

97

98

99

100

101

102

103

104

105

106

107

108

109

110

111

112

113

114

115

116

117

118

119

120

121

122

123

124

125

126

127

128

129

130

131

132

133

134

135

136

137

138

139

140

141

142

143

144

145

146

147

148

149

150

151

152

153

154

155

156

157

158

159

160

161

162

163

164

165

166

167

168

169

170

171

172

173

174

175

176

177

178

179

180

181

182

183

184

185

186

187

188

189

190

191

192

193

194

195

196

197

198

199

200

201

202

203

204

205

206

207

208

209

210

211

212

213

214

215

216

217

218

219

220

221

222

223

224

225

226

227

228

229

230

231

232

233

234

235

236

237

238

239

240

241

242

243

244

245

246

247

248

249

250

251

252

253

254

255

256

257

258

259

260

261

262

263

264

265

266

267

268

269

270

271

272

273

274

275

276

277

278

279

280

281

282

283

284

285

286

287

288

289

290

291

292

293

294

295

296

297

298

299

300

301

302

303

304

305

306

307

308

309

310

311

312

313

314

315

316

317

# LANDSCAPE AND STREET FURNISHINGS



# PROPOSAL SUMMARY

- Consistent road profile
- Increased tree coverage
- Added parking (20-24 new spaces)
- New left turn phases to improve safety and processing
- Dedicated space for cyclists
- Improved pedestrian access to ferry landing through wider sidewalks and shorter crossings



# PROJECT TIMELINE

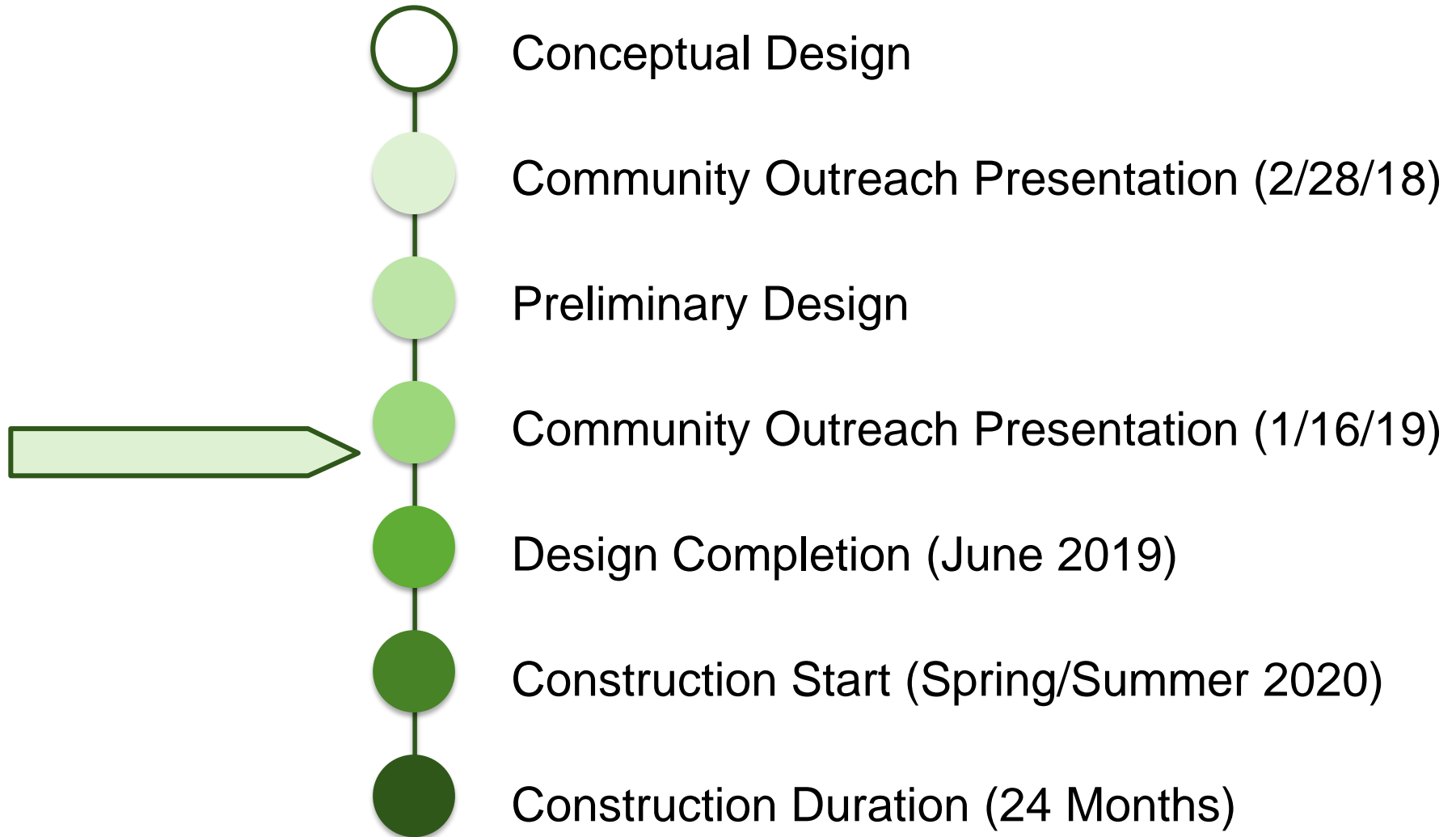

# THANK YOU!

## Questions?



NYC DOT



NYC DOT



nyc\_dot



NYC DOT