



# WESTCHESTER AVE, FOX ST, E 165<sup>TH</sup> ST

Presentation to CB2  
October 14<sup>th</sup>, 2020

---

# BACKGROUND AND EXISTING CONDITIONS

# 1



# BACKGROUND

- Multiple community requests for pedestrian improvements to channelized triangle at the intersection of Westchester Ave, Fox St, and E 165<sup>th</sup> St
- Walkthrough conducted with Council Member Salamanca on July 20, 2020 to discuss pedestrian safety in the area



# PROJECT AREA AND SAFETY DATA

- High volume pedestrian location adjacent to Simpson Ave 2/5 train station, BX4 and BX4A bus lines, El Nuevo San Juan Medical Center, and many commercial retail establishments
- The intersection is in a Vision Zero Priority Area and Westchester Ave is a Vision Zero Priority Corridor



**Westchester Ave, Fox St, E 165<sup>th</sup> St, BX**  
Injury Summary, 2014-2018 (5 years)

	Injuries
Pedestrian	10
Bicyclists	1
Motor Vehicle Occupant	24
Total	35



# EXISTING CONDITIONS

- 1 Narrow sidewalk frequently blocked by grocery store
- 2 Vehicles making right hand turn from southbound Westchester Ave to E 165<sup>th</sup> St can either turn inside or outside of subway column potentially creating conflicts
- 3 Double parking on Westchester Ave

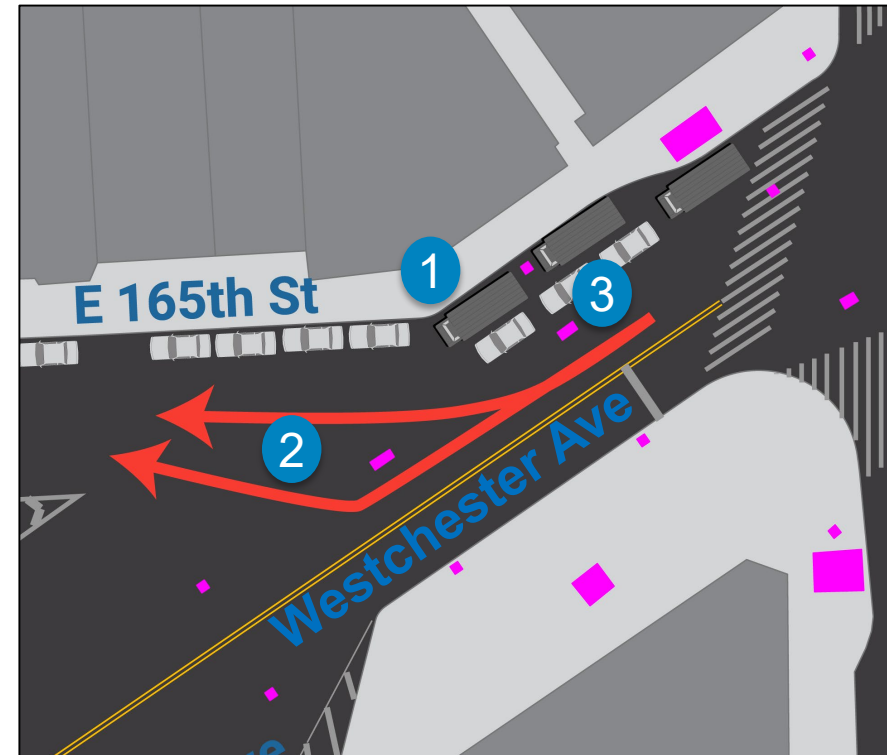

**Key**  
■ Subway Column



# EXISTING CONDITIONS

- 1 Channelized triangle does not provide pedestrian refuge
- 2 Uncontrolled crosswalks on E 165<sup>th</sup> St at Fox
- 3 Missing crosswalk to north corner of E 165<sup>th</sup> St on Westchester Ave

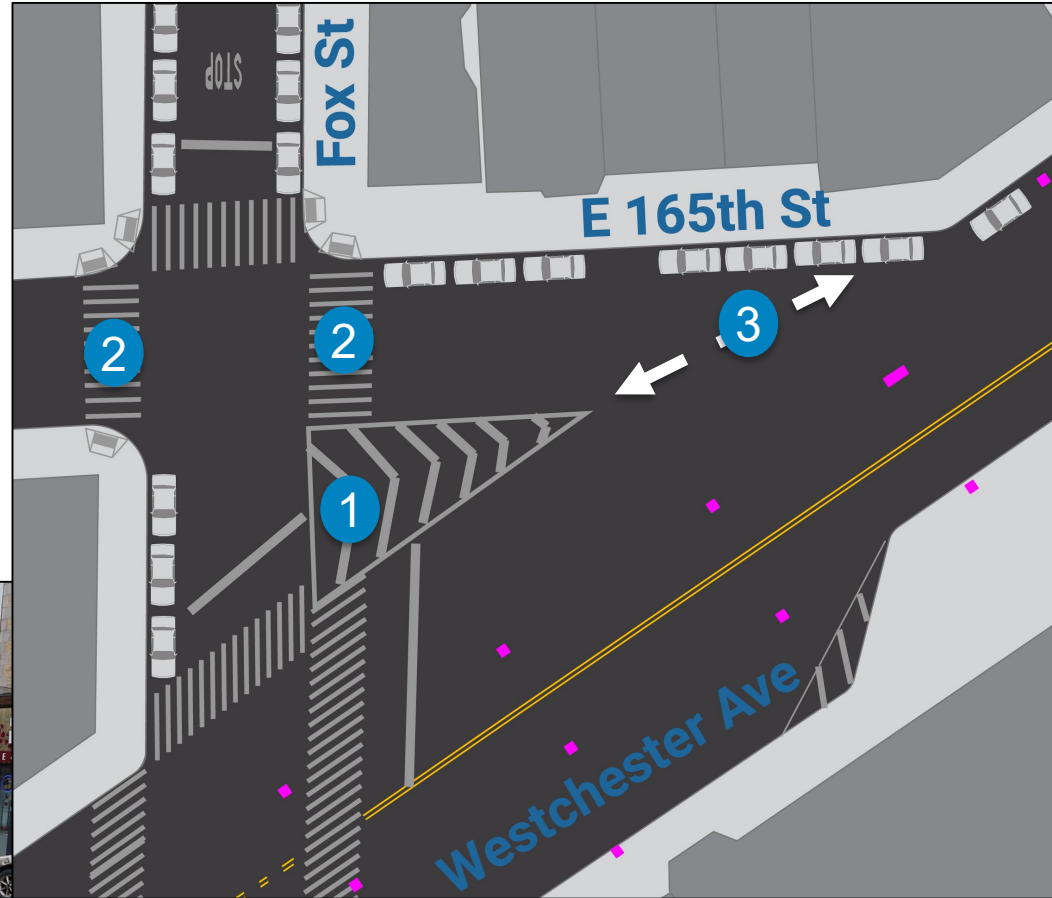

**Key**  
■ Subway Column

---

PROPOSAL

2



# IN-HOUSE TOOLKIT



**Traffic Signals**

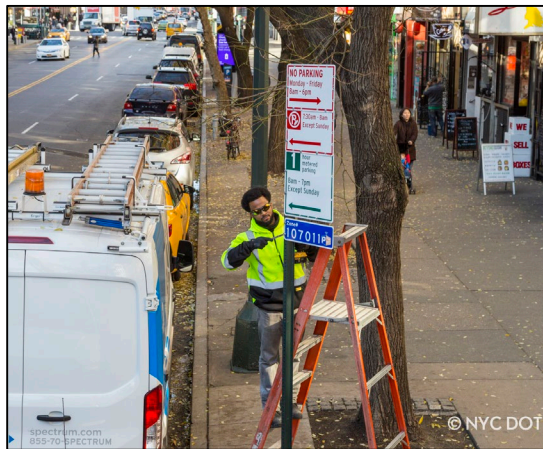

**Parking Regulations**



**Thermoplastic Markings**



**Concrete Triangles**



**Expanded sidewalks with paint with delineators**



# PROPOSAL

- 1 Widen sidewalk on Westchester Ave at E 165<sup>th</sup> St in paint
- 2 Paint and add flexible delineators between columns to move right hand turns outside of subway columns to remove turning conflict
- 3 Move parking out between columns and add commercial loading regulations on Westchester Ave

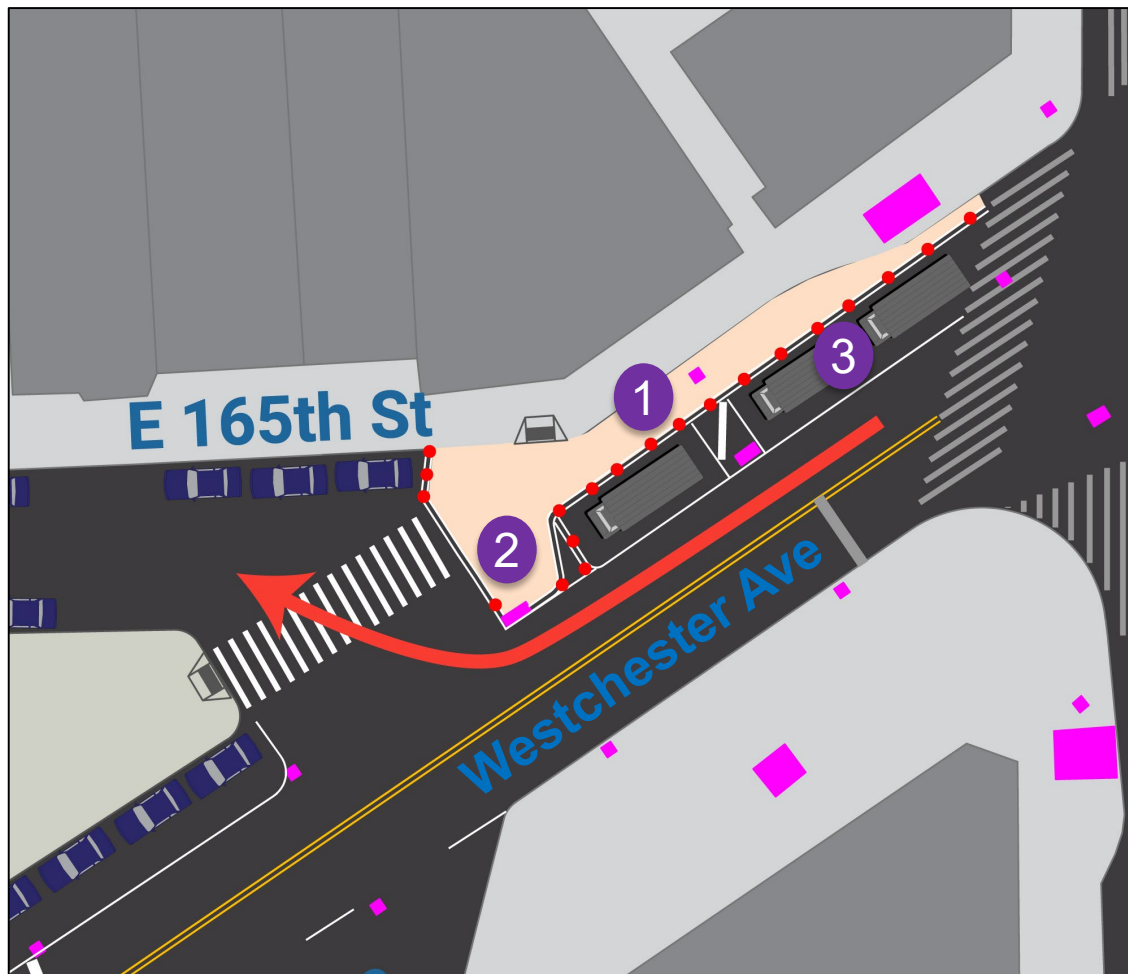

## Key



Subway Column



Flexible Delineator

# PROPOSAL

- 1 Construct concrete triangle with parking and trees at Westchester Ave, E 165<sup>th</sup> St and Fox St
- 2 Construct concrete curb extension on the northeast corner of Fox and E 165<sup>th</sup> St
- 3 Signalize intersection of Fox and E 165<sup>th</sup> St and restrict low volume left hand turn from E 165<sup>th</sup> to southbound Fox St as it is necessary for signal installation
- 4 Install missing crosswalk on Westchester Ave at E 165<sup>th</sup> St

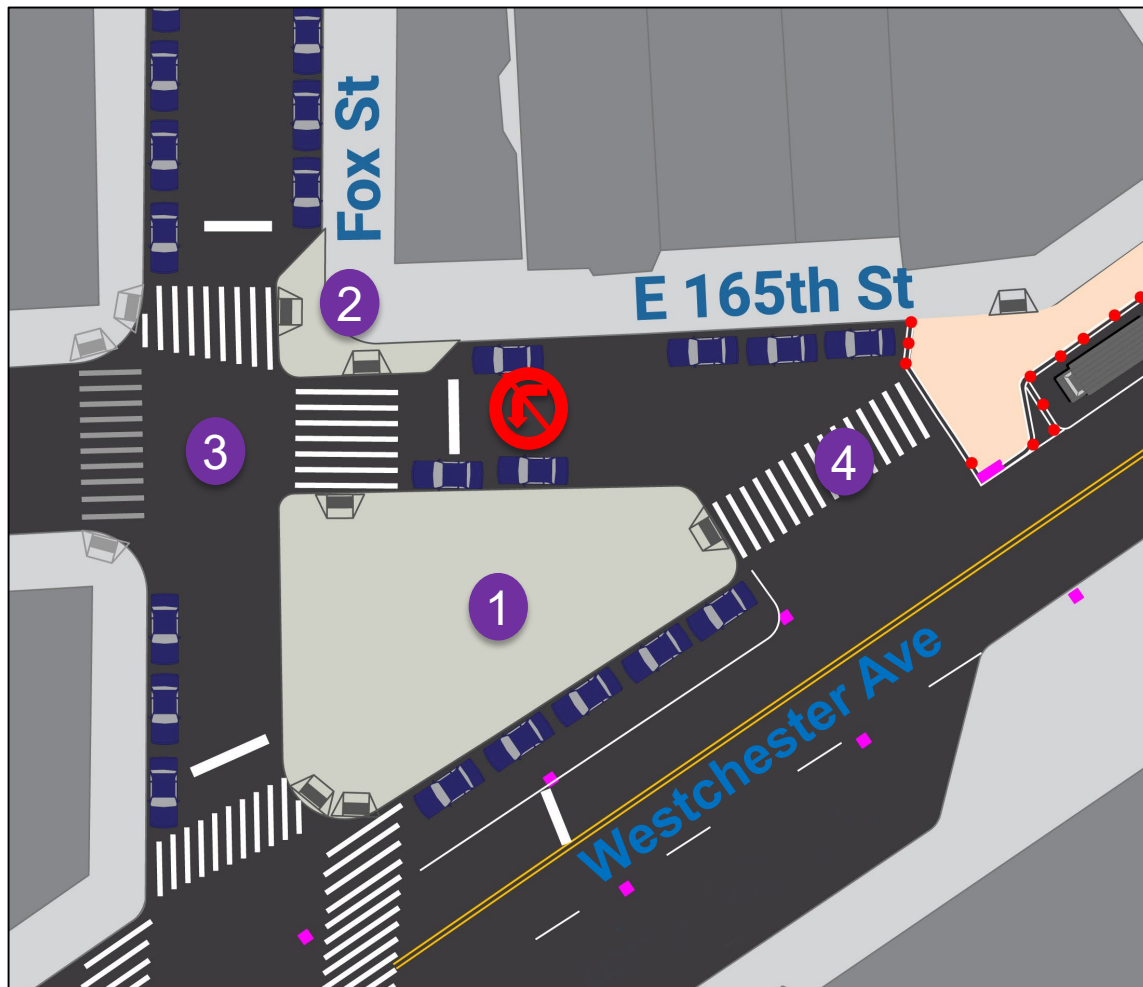

## Key



Subway Column



Flexible Delineator



# BENEFITS

- Expanded pedestrian space
- Signalized crossings
- Added parking spaces
- Safer, shorter pedestrian crossings
- Clarified traffic movements



# SUMMARY

- Widen narrow sidewalk on Westchester Ave at E 165<sup>th</sup> St in paint
- Paint and add flexible delineators between columns to move right hand turns outside of subway columns and remove turning conflict
- Move parking out between columns and add commercial loading regulations on Westchester Ave
- Construct concrete triangle with parking and trees at Westchester Ave, E 165<sup>th</sup> St and Fox St
- Construct concrete curb extension on the northeast corner of Fox and E 165<sup>th</sup> St
- Signalize intersection of Fox and E 165<sup>th</sup> St and restrict low volume left turn from E 165<sup>th</sup> to southbound Fox St as it is necessary for signal installation
- Install missing crosswalk on Westchester Ave at E 165<sup>th</sup> St



# THANK YOU!

## Questions?



NYC DOT



NYC DOT



nyc\_dot



NYC DOT

# FULL PLAN

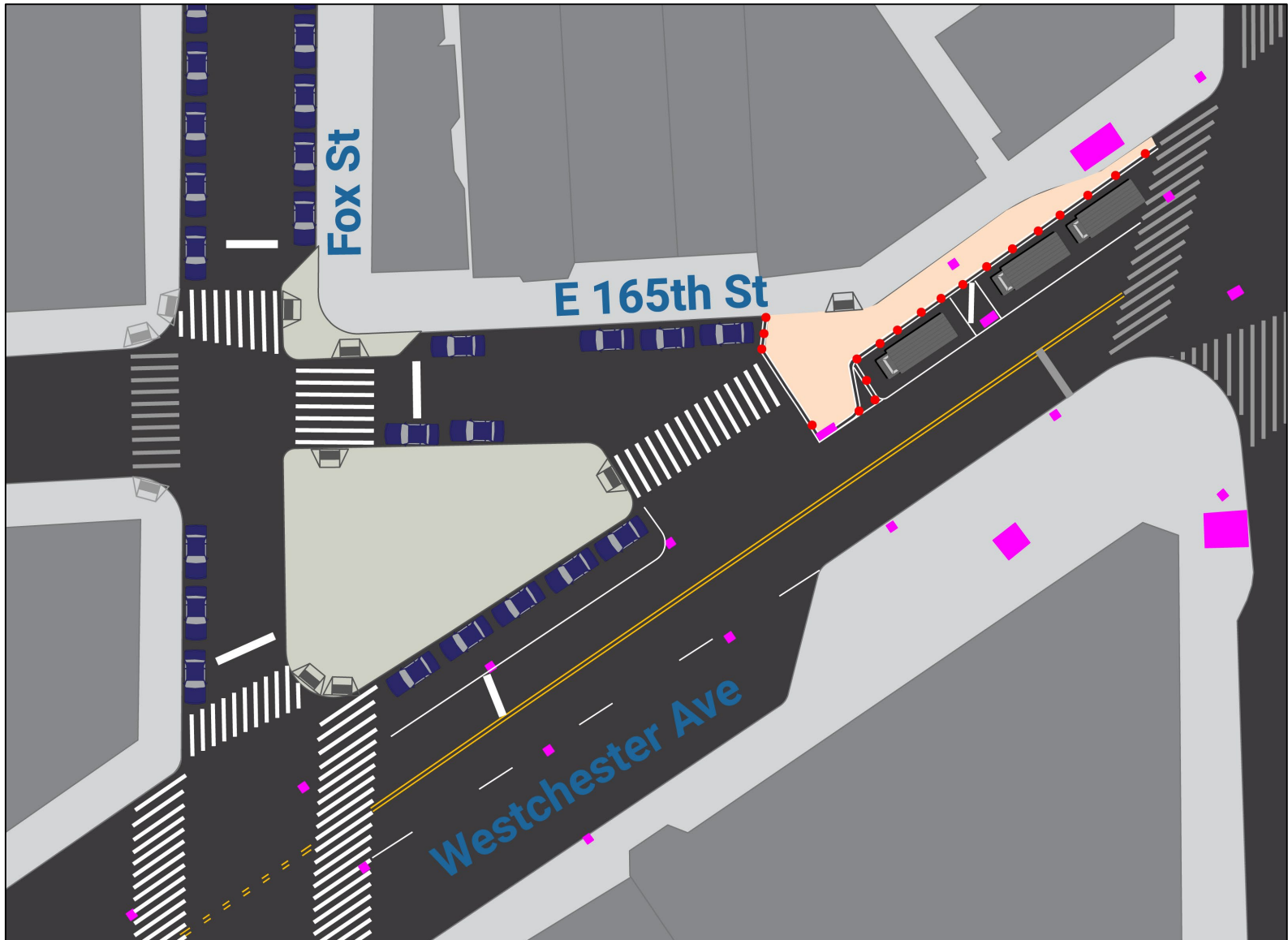



# SIGNAL TIMING

## PHASE I

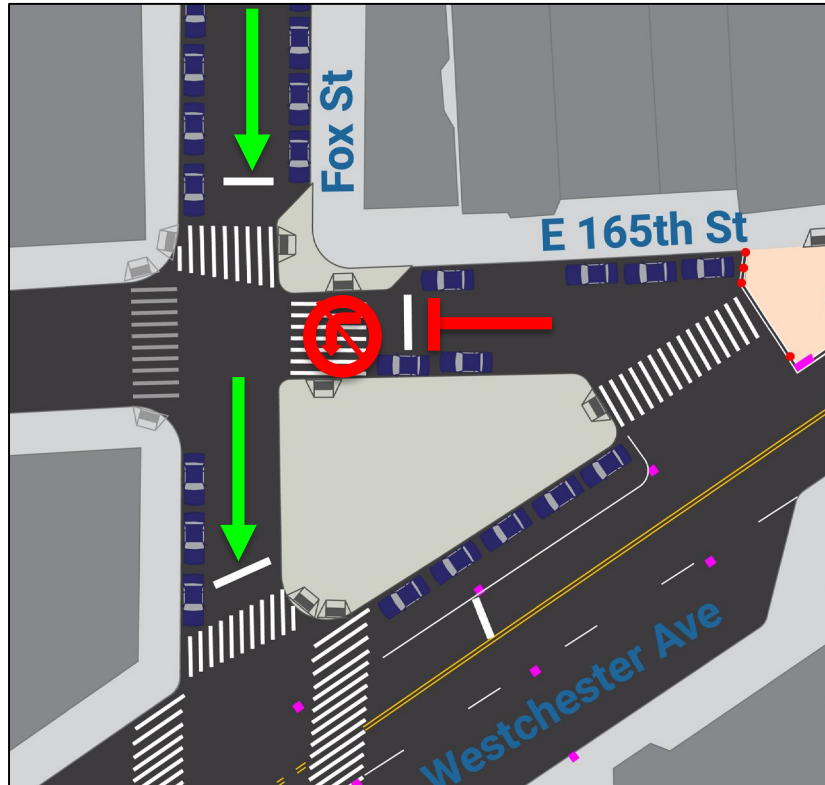

## PHASE II

