



THE CITY OF NEW YORK
MANHATTAN COMMUNITY BOARD 3

59 East 4th Street - New York, NY 10003
Phone: (212) 533-5300 - Fax: (212) 533-3659
www.cb3manhattan.org - info@cb3manhattan.org

Gigi Li, Board Chair

Susan Stetzer, District Manager

Community Board 3 Liquor License Application Questionnaire

Please bring the following items to the meeting:

NOTE: ALL ITEMS MUST BE SUBMITTED FOR APPLICATION TO BE CONSIDERED.

- Photographs of the inside and outside of the premise.
- Schematics, floor plans or architectural drawings of the inside of the premise.
- A proposed food and or drink menu.
- Petition in support of proposed business or change in business with signatures from residential tenants at location and in buildings adjacent to, across the street from and behind proposed location. Petition must give proposed hours and method of operation. For example: restaurant, sports bar, combination restaurant/bar. (petition provided)
- Notice of proposed business to block or tenant association if one exists. E-mail the CB3 office at info@cb3manhattan.org to find block associations. This must be done promptly so that there is sufficient time to meet with residents if necessary.
- Photographs of proof of conspicuous posting of meeting with newspaper showing date.
- If applicant has been or is licensed anywhere in City, letter from applicable community board indicating history of complaints and other comments.

Check which you are applying for:

- new liquor license alteration of an existing liquor license corporate change

Check if either of these apply:

- sale of assets upgrade (change of class) of an existing liquor license

Today's Date: 9/26/2013

If applying for sale of assets, you must bring letter from current owner confirming that you are buying business, or have the seller come with you to the meeting.

Type of license: Restaurant Beer & Wine Is location currently licensed? Yes No

If alteration, describe nature of alteration:

Previous or current use of the location: bakery & coffee shop

Corporation and trade name of current license: N/A

APPLICANT:

Premise address: 223 1st Ave New York NY 10003

Cross streets: E 13th St & E 14th Street

Name of applicant and all principals: MEE ENTERPRISE LLC

WU LIANG CHI

Trade name (DBA): MEE NOODLE SHOP

PREMISE:

Type of building and number of floors: Attached Brick Building total 4 Floors

Will any outside area or sidewalk cafe be used for the sale or consumption of alcoholic beverages?
(includes roof & yard) Yes No If Yes, describe and show on diagram: _____

Does premise have a valid Certificate of Occupancy and all appropriate permits, including certificate of occupancy for back or side yard intended for commercial use? Yes No

Indoor Certificate of Occupancy 40 Outdoor Certificate of Occupancy N/A
(fill in maximum NUMBER of people permitted)

Do you plan to apply for Public Assembly permit? Yes No

Zoning designation (check zoning using map: <http://gis.nyc.gov/doitt/nycitymap/> - please give specific zoning designation, such as R8 or C2): _____

Is this premise wheel chair accessible? Yes No

PROPOSED METHOD OF OPERATION:

What type of establishment will this be (i.e.: restaurant, bar, performance space, club, hotel)?
restaurant

Will any other business besides food or alcohol service be conducted at premise? Yes No
If yes, please describe what type: Chinese Noodle shop

What are the proposed days/hours of operation? (Specify days and hours each day and hours of outdoor space) Monday to Sunday 11am to 11pm

Number of tables? 7 Number of seats at tables? 5-4 seats table & 2-6 seats

How many stand-up bars/ bar seats are located on the premise? NONE

(A **stand up bar** is any bar or counter (whether with seating or not) over which a patron can order, pay for and receive an alcoholic beverage)

Describe all bars (length, shape and location): _____

Any food counters? Yes No If Yes, describe: _____

Does premise have a full kitchen? Yes No?

Does it have a food preparation area? Yes No (If any, show on diagram)

Is food available for sale? Yes No If yes, describe type of food and submit a menu

What are the hours kitchen will be open? 11am to 10:45pm

Will a manager or principal always be on site? Yes No If yes, which? WU LIANG CHH

How many employees will there be? 7

Do you have or plan to install French doors accordion doors or windows?

Will you agree to close any doors and windows at 10:00 P.M. every night? Yes No

Will there be TVs/monitors? Yes No (If Yes, how many?) _____

Will premise have music? Yes No

If Yes, what type of music? Live musician DJ Juke box Tapes/CDs/iPod

If other type, please describe _____

What will be the music volume? Background (quiet) Entertainment level

Please describe your sound system: _____

Will you host promoted events, scheduled performances or any event at which a cover fee is charged? If Yes, what type of events or performances are proposed? NO

How do you plan to manage vehicular traffic and crowds on the sidewalk caused by your establishment? Please attach plans.

Will there be security personnel? Yes No (If Yes, how many and when) _____

How do you plan to manage noise inside and outside your business so neighbors will not be affected? Please attach plans.

Do you have or plan to install sound-proofing?

APPLICANT HISTORY:

Has this corporation or any principal been licensed previously? Yes No

If yes, please indicate name of establishment: _____

Address: _____ Community Board # _____

Dates of operation: _____

If you answered "Yes" to the above question, please provide a letter from the community board indicating history of complaints or other comments.

Has any principal had work experience similar to the proposed business? Yes No If Yes, please attach explanation of experience or resume.

Mee Noodle Shop & Grill
9222nd Ave New York NY 10017

Does any principal have other businesses in this area? Yes No If Yes, please give trade name and describe type of business _____

Has any principal had SLA reports or action within the past 3 years? Yes No If Yes, attach list of violations and dates of violations and outcomes, if any.

Attach a separate diagram that indicates the location (**name and address**) and total number of establishments selling/serving beer, wine (B/W) or liquor (OP) for 2 blocks in each direction. Please indicate whether establishments have On-Premise (OP) licenses. Please label streets and avenues and identify your location. Use letters to indicate Bar, Restaurant, etc. The diagram must be submitted with the questionnaire to the Community Board before the meeting.

LOCATION:

How many licensed establishments are within 1 block? 4

How many licensed establishments are within 500 feet? 8

Is premise within a 500 foot radius of 3 or more establishments with OP licenses? Yes No

How many On-Premise (OP) liquor licenses are within 500 feet? 6

Is premise within 200 feet of any school or place of worship? Yes No

If there is a school or place of worship within 200 feet of your premise on the same block, submit a block plot diagram or area map showing its location in proximity to your premise and indicate the distance and name and address of the school or house of worship.

COMMUNITY OUTREACH:

If there are block associations or tenant associations in the immediate vicinity of your location, you must contact them. Contact the CB 3 office at info@cb3manhattan.org to find block and tenant associations. **Please attach proof (copies of letters or email and poster) that you have advised these groups of your application with sufficient time for them to respond to your notice.**

Please use provided petitions, which clearly state the name, address, license for which you are applying, and the hours and method of operation of your establishment at the top of each page. (Attach additional sheets of paper as necessary).

223 1ST AVE, MANHATTAN, NY

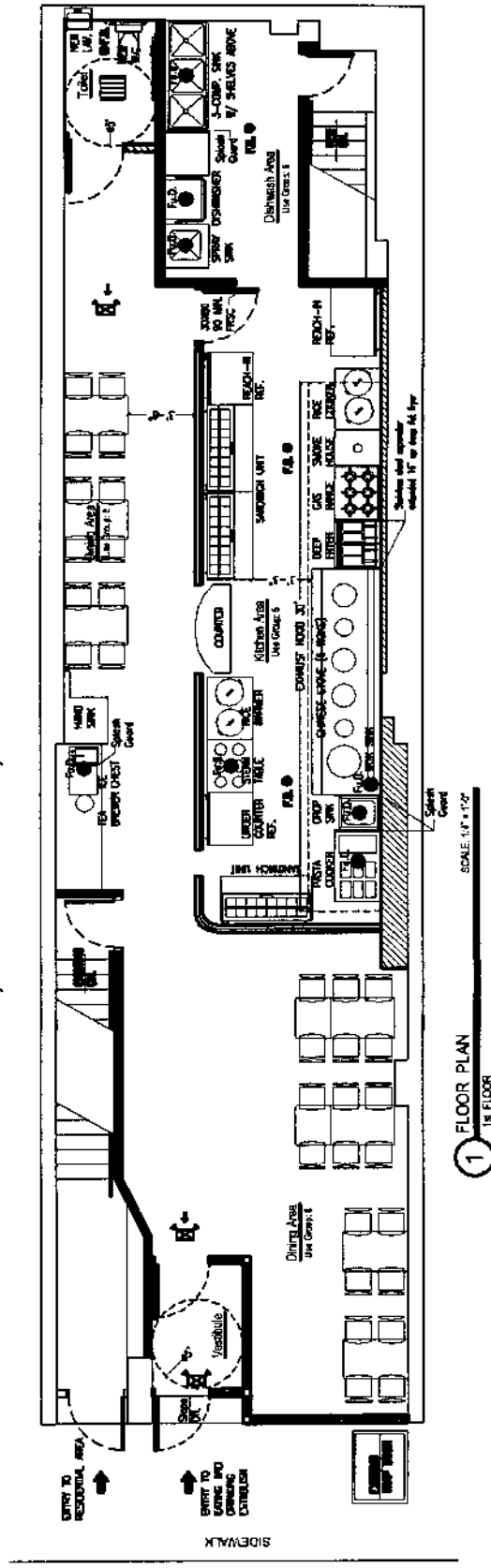

Mee Noodle Shop & Grill

922 2nd Ave
New York, NY 10017-1504
At 49th St

212 888-0027
212 888-0138
212 888-0234

Page 1 of 2

YOUR AD HERE

MenuPages **PRIME** Advertising

for more info: www.menupages.com

Delivery & Take Out

Lunch Special

Served With Choice Of Soup Or Egg Roll And A Choice Of Rice. Available Daily Between 11am-4pm. Lunch Special Rice Selection: White Rice, Brown Rice, Egg Fried Rice. Lunch Special Soup/Egg Roll Selection: Egg Drop Soup, Wonton Soup, Hot & Sour Soup, Egg Roll.

- L1. Chicken Chow Mein Lunch Special 6.65
- L2. Shrimp Chow Mein Lunch Special 6.65
- L3. Shrimp, Chicken Or Beef Lo Mein Lunch Special choice of protein. 6.65 lunch special protein selection: shrimp, chicken, beef.
- L4. Sweet & Sour Chicken Or Pork Lunch Special choice of chicken or pork. 6.65
- L5. Moo Goo Gai Pan Lunch Special 6.65
- L6. Chicken With Broccoli Lunch Special 6.65
- L7. Chicken With Mixed Vegetables Lunch Special 6.65
- L8. Chicken With Black Bean Sauce Lunch Special 6.65
- L9. Chicken With Cashew Nuts Lunch Special 6.65
- L10. Chicken With Garlic Sauce Lunch Special* 6.65
- L11. Diced Chicken With Hot Pepper & Peanut Lunch Special* 6.65
- L12. Chicken & Shrimp Combination Lunch Special 6.65
- L13. Double Sautéed Pork Lunch Special* 6.65
- L14. Pork With Broccoli Lunch Special 6.65
- L15. Roast Pork With Chinese Vegetables Lunch Special 6.65
- L16. Pork With Garlic Sauce Lunch Special* 6.65
- L17. Pepper Steak Lunch Special 6.65
- L18. Beef With Broccoli Lunch Special 6.65
- L19. Shredded Beef With Garlic Sauce Lunch Special* 6.65
- L20. Beef With Mixed Vegetables Lunch Special 6.65
- L21. Baby Shrimp With Broccoli Lunch Special 6.65

- L22. Baby Shrimp With Mixed Vegetables Lunch Special 6.65
- L23. Baby Shrimp With Chili Sauce Lunch Special* 6.65
- L24. Baby Shrimp With Black Bean Sauce Lunch Special 6.65
- L25. Shrimp With Lobster Sauce Lunch Special 6.65
- L26. Baby Shrimp With Garlic Sauce Lunch Special* 6.65
- L27. Broccoli With Garlic Sauce Lunch Special* 6.65
- L28. Mixed Vegetables Lunch Special 6.65
- L29. General Tso Chicken Lunch Special* 7.10
- L30. Tofu With Mixed Vegetables Lunch Special bean curd. 6.65

Classic Appetizers

- Egg Roll 1.80
- Vegetable Roll spring roll. 1.80
- Egg Scallion Pancakes 3.95
- Sesame Wonton 4.60
- Shrimp Toast 4.60
- Small Meat Bun Steamed (6pcs) 5.50
- Shrimp Roll 2.30
- Scallion Pancake 3.50
- Edamame 4.15
- Cold Noodle In Sesame Sauce* 5.05
- Fried Fantail Shrimp 4.60

Classic Soups

- Sm / Lg.
- House Chicken Soup chicken, celery, potatoes, onions and carrots. 3.00 5.05
 - Chicken Noodle Soup 2.75 5.05
 - Tomato Clear Egg Drop Soup lg 5.05
 - Hot & Sour Soup* 2.25 3.65
 - Egg Drop Wonton Soup Mix 2.25 3.65
 - Chicken Corn Cream Soup 5.50
 - Seafood Soup 6.45
 - Chicken Rice Soup 2.75 5.05
 - Cantonese Wonton Soup 2.25 4.60
 - Regular Wonton Soup 2.05 3.65
 - Egg Drop Soup 2.05 3.65
 - Tofu Vegetable Soup 5.05
 - Crab Meat Corn Cream Soup 5.50

Dumpling & Dumpling Noodle Soup \$5.05

Dumpling Additions: Soup \$0.90, Soup With Spinach Noodle (Linguine) \$1.85, Soup With Mandarin Noodle (Linguine) \$1.85, Soup With Lo Mein (Spaghetti) \$1.85, Soup With Thin Cantonese Noodle (Angel Hair) \$1.85, Soup With Mee Fun (Thin Rice Noodle) \$1.85, Soup With Chow Fun (Flat Soft Rice Noodle) \$1.85, Soup With Cantonese Noodle (A Little Wider) \$1.85, Soup With Cantonese Wonton \$3.35.

Pan-Fried Meat Dumpling
Steamed Seafood Dumpling
Steamed Meat Dumpling
Steamed Vegetable Dumpling

Rice & Noodles

- Pan-Fried Noodles With Vegetables double fried noodles. cantonese chow mein. 8.95
- Subgum Pan-Fried Noodles cantonese chow mein. shrimp, scallops, chicken and beef with double fried noodles. 11.25
- Lo Mein with choice of protein. sm 5.50 lg 7.35 rice & noodles protein selection: chicken, shrimp, pork, beef.
- Chow Fun with choice of protein. lg 7.80 rice & noodles protein selection: chicken, shrimp, pork, beef.
- Fried Rice With Chinese Sausage sm 5.50 lg 7.80
- Fried Rice In Tomato Sauce sm 5.50 lg 7.80
- House Special Fried Rice sm 5.95 lg 8.25
- Classic Chow Mein with choice of protein. sm 5.95 lg 8.25 chow mein protein selection: pork, shrimp, chicken, beef, vegetables.
- Pan-Fried Noodles cantonese chow mein with choice of protein. double fried noodles. 9.95
- pan fried noodle protein selection: chicken, beef, shrimp.
- Seafood Pan-Fried Noodles cantonese chow mein. 11.25

- Fried Rice with choice of protein. sm 5.50 lg 7.35 rice & noodles protein selection: chicken, shrimp, pork, beef.
- Mee Fun with choice of protein. lg 7.80 rice & noodles protein selection: chicken, shrimp, pork, beef.
- Taiwanese Mee Fun 7.80
- House Special Lo Mein sm 5.95 lg 8.25
- Singapore Chow Mee Fun hot and spicy. curry flavor with choice of protein. 8.25 chicken/pork/shrimp selection: chicken, pork, shrimp.

Noodles & Noodle Soups

- Noodle Selection: Spinach Noodle (Linguine), Mandarin Noodle (Linguine), Lo Mein (Spaghetti), Thin Cantonese Noodle (Angel Hair), Mee Fun (Thin Rice Noodle), Chow Fun (Flat Soft Rice Noodle), Cantonese Noodle (A Little Wider), Cantonese Wonton \$1.50. Noodle Add-On Selection: Chicken \$3, Beef \$3, Pork \$3, Duck \$3, Shrimp \$3, Hard Boiled Egg \$0.75, Cantonese Wonton \$1.50.
- Plain Noodles In Soup with choice of noodles. 4.60
 - Noodles With Roast Pork with choice of noodles. 6.40
 - Noodles With Soy Sauce Chicken with choice of noodles. 6.40
 - Noodles With Vegetables with choice of noodles. 6.40
 - Noodles With Fish Ball with choice of noodles. 6.40
 - Noodles With Seafood with choice of noodles. 7.60
 - Noodles With Shrimp with choice of noodles. 7.60
 - Pickled Cabbage With Pork In Noodle Soup with choice of noodles. 6.40
 - Dan Dan Noodles dry. with choice of noodles. 6.40
 - Little Bit Of Everything Soup with choice of noodles and corn starch. 7.60
 - Noodles & Cantonese Wonton with choice of noodles. 6.40
 - Noodles With Roast Chicken with choice of noodles. 6.40

- Noodles With Roast Duck with choice of noodles. 7.30
- Noodles With Meat Sauce peking style. hot and spicy. with choice of noodle. this is not a soup. 6.40
- Noodles With Fish Cake with choice of noodles. 5.95
- Noodles With Roast Pork & Seafood with choice of noodles. 7.60
- Pork Chop Noodle Soup with choice of noodles. 7.60
- Cellophane Noodle Soup with bean curd, mushrooms and choice of noodles. 6.40
- Noodle Soup With Chicken with choice of noodles. 6.40
- Little Bit Of Everything In Plain Soup no corn starch. with choice of noodles. 7.60

Egg Foo Young

- 3 Pieces Per Order.
Egg Foo Young choice of protein 8.95
egg foo young protein selection: pork, shrimp, chicken, vegetable.

Chicken

- Sliced Chicken With Chinese Eggplant 9.50
- Sliced Chicken With Broccoli 9.50
- Moo Goo Gai Pan chicken with mushrooms. 9.50
- Sliced Chicken Black Bean Sauce 9.50
- Sliced Chicken With Garlic Sauce* 9.50
- Chicken With Walnuts 9.50
- Ta-Chin Chicken* with onions, pepper and celery. 9.50
- Diced Chicken & Shrimp Combination 9.50
- Moo Shu Chicken extra moo shu pancakes (1) 0.50 (2) 1.00 (3) 1.50 (4) 2.00
- Sliced Chicken With Snow Peas 9.50
- Sliced Chicken With Mixed Vegetables 9.50
- Curry Chicken* 9.50
- Sweet & Sour Chicken 9.50
- Diced Chicken With Cashew Nuts 9.50
- Diced Chicken With Hot Pepper Sauce & Peanuts* 9.50
- Chicken Egg Foo Young (3pcs) 8.95



Menu Items and Prices subject to change. Information related to this restaurant is provided solely for informational purposes only and is not an endorsement or guarantee by MenuPages.com or any Listed Restaurant. © 2009 Slick City Media, Inc. www.MenuPages.com

MENUPAGES

Mee Noodle Shop & Grill

922 2nd Ave
New York, NY 10017-1504
At 49th St

212 888-0027

212 888-0138

212 888-0234

Page 2 of 2

YOUR AD HERE

MenuPages **PRIME** Advertising

for more info: www.menupages.com

Vegetables \$8.95		Shredded Beef Szechuan* <i>with celery and carrots.</i>	(4) 2.00	chicken/shrimp selection	Happy Family chicken, shrimp, scallops, beef, roast pork and vegetables. 14.25
Sautéed Bean Sprouts		Shredded Beef With String Bean		S6. Beef With Tomato Spe- cial Platter served over rice.	Lemon Chicken 10.75
Sautéed Spinach In Shrimp Flavor				S7. Shrimp Lobster Sauce Special Platter served over rice.	General Tso Chicken & Sea- food Combo* 15.00
Mixed Vegetables In Garlic Sauce*		Pork		S8. Baby Shrimp Green Peas Special Platter served over rice.	
Broccoli With Straw Mush- rooms		Moo Shu Pork 9.35		S9. Beef, Pork Or Chicken With String Beans Special Platter choice of protein served over rice.	Home Style Cooking
Sautéed String Beans In Brown Sauce		extra moo shu pancakes		S10. Pepper Steak Special Platter served over rice.	Scrambled Eggs With Scal- lions 8.95
Dry Sautéed String Beans With Meat* pork.		(1) 0.50		S11. Mapo Tofu Special Plat- ter served over rice.	Shredded Pork With Dry Bean Cake 10.35
Chinese Eggplant In Garlic Sauce*		(2) 1.00		S12. Double Sautéed Pork Special Platter* served over rice.	Scrambled Eggs With Shrimp 10.35
Broccoli With Garlic Sauce*		(3) 1.50			Shredded Beef With Jalapeño Peppers* 12.00
Sautéed Spinach With Fresh Garlic		(4) 2.00			
Buddha's Delight In White Sauce		Sweet & Sour Pork 9.35			Hard To Get Classics
Sautéed Chinese Broccoli		Shredded Pork In Garlic Sauce* 9.35			Steak Kew ribeye steak. 15.00
Broccoli With Black Mush- rooms		Pork With Scallion 9.35			Lobster any style. 22.00
String Beans in Garlic Sauce*		Pork Egg Foo Young(3pcs) 8.95			
Moo Shu Vegetables extra moo shu pancakes	(1) 0.50 (2) 1.00 (3) 1.50 (4) 2.00	Roast Pork With Chinese Ve- getables 9.35			BBQ Roast Meats
		Sliced Pork With Mixed Ve- getables 9.35			Roast Pork On Rice cantonese style. 6.45
		Shredded Pork in Black Bean Sauce 9.35			BBQ Spare Ribs cantonese style. without rice. (6pcs) 9.95
		Double Sautéed Pork* origin- al chinese version. 9.35			Roast Chicken cantonese style. 7.80
					Roast Duck On Rice cantonese style. 6.45
					Roast Duck cantonese style. 8.75
					Roast Pork cantonese style. 7.80
					Roast Chicken On Rice cantonese style. 6.45
					Half Roast Chicken 12.00
					Half Roast Duck 13.50
					Sides & Extras
					Moo Shu Pancake ea 0.50
					Small Brown Rice 1.80
					Extra Noodle On The Side 2.00
					Fresh Muster pt 2.00
					Jumbo Shrimp per pc 1.00
					Small White Rice 1.40
					Crispy Dry Noodle 0.50
					Fresh Duck Sauce pt 2.00
					Extra Meat extra meat selec- tion: pork, beef, chicken, baby shrimp. 2.00
					Desserts \$2.75
					Pineapple
					Lychee
					Beverages
					Soda canned. soda selection: pepsi, diet pepsi, mist, diet mist, sunkist, ginger ale, seltzer, iced tea. 1.25
					* Hot & Spicy.



Menu Items and Prices subject to change. Information related to this restaurant is provided solely for informational purposes only and is not an endorsement or guarantee by MenuPages.com or any Listed Restaurant. © 2009 Slick City Media, Inc. www.MenuPages.com



DEPARTMENT OF BUILDINGS

BOROUGH OF MANHATTAN

THE CITY OF NEW YORK

Date **March 19, 1976**

No. **76553**

CERTIFICATE OF OCCUPANCY

NO CHANGES OF USE OR OCCUPANCY NOT CONSISTENT WITH THIS CERTIFICATE SHALL BE MADE UNLESS FIRST APPROVED BY THE BOROUGH SUPERINTENDENT

This certificate supersedes C. O. No.

THIS CERTIFIES that the ~~same~~ ~~altered~~ ~~existing~~ building, ~~structure~~ located at **223-1st Avenue** Block **455** Lot **40**

That the zoning lot and premises above referred to are situated, bounded and described as follows:

BEGINNING at a point on the ~~west~~ **west 80** side of **1st Avenue** distant **43'5"** feet **north** from the corner formed by the intersection of **1st Avenue** and **East 13th Street**

running thence **west 80** feet; thence **north 20** feet; thence **east 80** feet; thence **south 20** feet; running thence **west 80** feet; thence **east 80** feet.

to the point or place of beginning, conforms substantially to the approved plans and specifications, and to the requirements of the Building Code, the Zoning Resolution and all other laws and ordinances, and of the rules of the Board of Standards and Appeals, applicable to a building of its class and kind at the time the permit was issued; and

CONFIRMS FURTHER that, any provisions of Section 246e of the New York Charter have been complied with as certified by a report of the Fire Commissioner to the Borough Superintendent.

Ab. No. **7493-74** Construction classification **C-3-W-F.P.**
 Occupancy classification **Old Law Tenement** Height **4** stories **38'11"** feet
 Date of completion **Class "A" U.** Located in **C 1-5 1st R 7-2** Zoning District
 at time of issuance of permit **2-20-76**

This certificate is issued subject to the limitations hereinafter specified and to the following resolutions of the Board of Standards and Appeals: (Calculate numbers to be inserted here)
 and The City Planning Commission:

PERMISSIBLE USE AND OCCUPANCY

Off-Street Parking Spaces _____

Off-Street Loading Berths _____

STORY	LIVE LOADS Lbs. per Sq. Ft.	PERSONS ACCOMMODATED	USE
Cellar	on ground		Relief room, storage, locker room, necessary to store above.
1st	100, 125, 150	20	Bakery store U. G. 6.
2nd	40		One (1) apartment.
3rd	40		One (1) apartment.
4th	40		One (1) apartment.

THIS CERTIFICATE OF OCCUPANCY MUST BE POSTED WITHIN THE BUILDING IN ACCORDANCE WITH THE RULES OF THE DEPARTMENT OF BUILDINGS, CITY OF NEW YORK, 1967

Sanitary Drainage: _____ Discharge Into Either
 (DOES) (DOES NOT) Sanitary or Combined Sewer

Storm Drainage: _____ Discharge Into Either
 (DOES) (DOES NOT) Storm or Combined Sewer

Conelius T. Harman
 Borough Superintendent

OFFICE COPY—DEPARTMENT OF BUILDINGS

JEREMIAH T. WALSH



THE CITY OF NEW YORK
MANHATTAN COMMUNITY BOARD 3

59 East 4th Street - New York, NY 10003

Phone: (212) 533-5300 - Fax: (212) 533-3659

www.cb3manhattan.org - info@cb3manhattan.org

Gigi Li, Board Chair

Susan Stetzer, District Manager

Dear Applicants, Lawyers, Architects, and others who represent liquor license applicants,

Community Board 3 has received your notification of an application for a new or alteration liquor license. Your request has been placed on the agenda of the next meeting of the SLA (State Liquor Authority) & DCA (Department of Consumer Affairs) Licensing Committee of Community Board 3. This committee will meet on

**Monday, October 7, 2013 at 6:30pm
Community Board 3 Office
59 East 4th Street (btwn 2nd Avenue & Bowery)**

Please see text of email invite for due date and directions on how to submit the questionnaire.

- Submit completed questionnaires (**with requested diagrams**) to the Community Board office **by the due date listed in the email invite. 6 copies (double sided)** plus additional requested information should be **brought to the meeting**, including copies of petitions circulated and proof of conspicuous posting of Community Board 3 notices at the site for **7 days** prior to the meeting (please include newspaper with date in photo). Please read questionnaire instructions carefully.
- Please inform the office of withdrawals by Friday noon before the Committee meeting. Notice must be in writing by fax, e-mail, or letter stating that applicant will not file with the SLA until they appear before the Community Board. Applicant must submit a new notice to the Community Board to be included on agenda for a meeting at later date.
- Note that withdrawn applications **will not be rolled over** to next month as stated in previous paragraph.
- Applications without completed information - **including** petitions and proof of posting - will not be heard at the committee meeting.
- Please note that the applicant must be present.

Thank you for your help and cooperation. If there are any questions, please call the office.

Sincerely,

A handwritten signature in black ink that reads 'Susan Stetzer'.

Susan Stetzer
District Manager